

THE HOME AGENCY

'Passion for property'



Flat 3 Maycroft Court, 1 Hulse Road, Banister Park, Southampton, £1,150 PCM

- Ground Floor Flat
- Gas Central Heating
- Brand New Carpets Throughout
- Sought After Location
- Two Bedroom
- Modern Kitchen
- Redecorated Throughout
- Double Glazing
- White Goods
- Communal Gardens

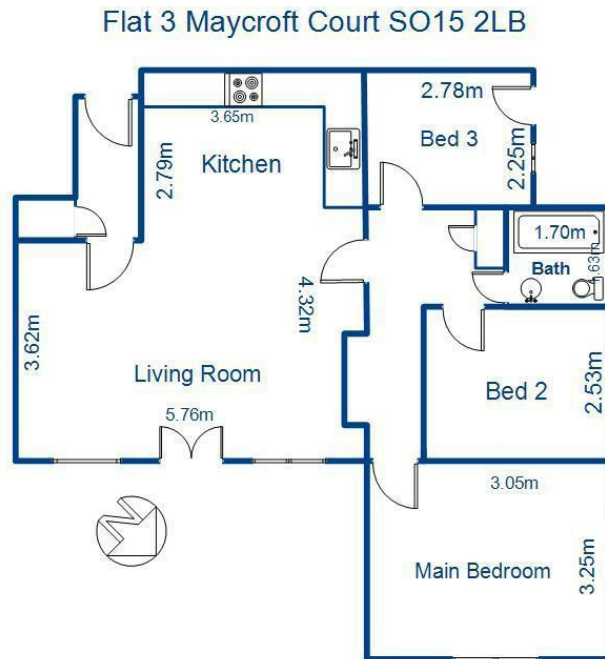

Gross Living Area 70.04Msq

ALL MEAUREMENTS ARE APPROXIMATE

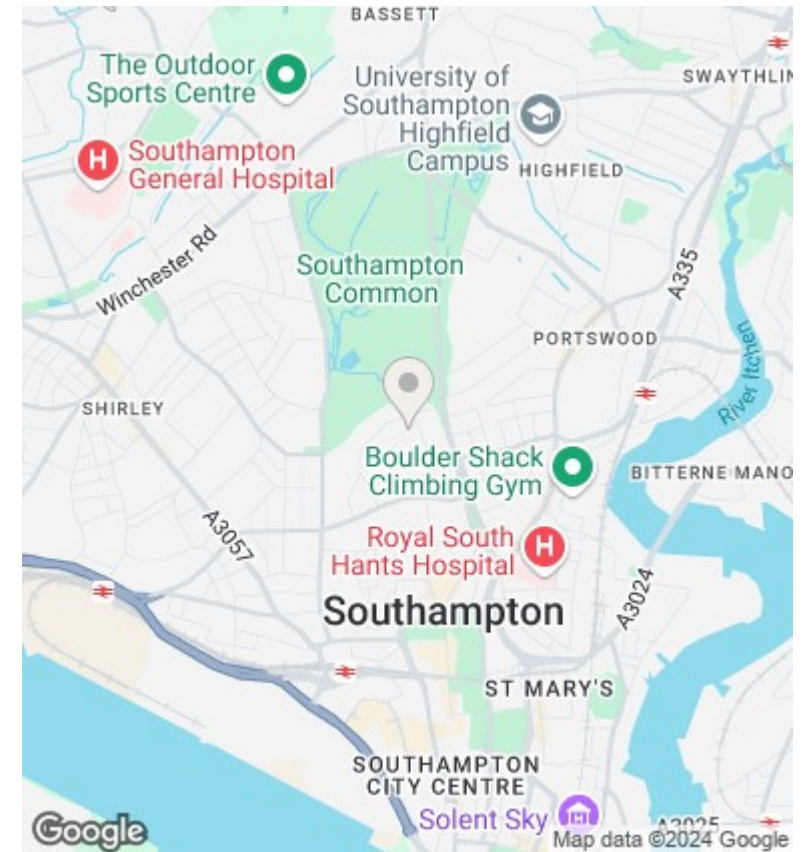

Directions

Viewings

Viewings by arrangement only. Call 02380 632632 to make an appointment.

Council Tax Band

C

EPC Rating:

C

Energy Efficiency Rating		
	Current	Potential
Very energy efficient - lower running costs		
(92 plus) A		
(81-91) B		
(69-80) C	73	78
(55-68) D		
(39-54) E		
(21-38) F		
(1-20) G		
Not energy efficient - higher running costs		
England & Wales		EU Directive 2002/91/EC