

THE HOME AGENCY

'Passion for property'



Flat 10 Park View, 8 Romsey Road, Eastleigh, Hampshire, SO50

£1,250 PCM

- Purpose Built
- Balcony
- Fitted Kitchen
- New flooring
- Two Double Bedrooms
- Off Road Parking
- Modern Bathroom
- White Goods
- Security Entry System
- Double Glazing

Flat 10 Park View 8 Romsey Road SO50 9DD

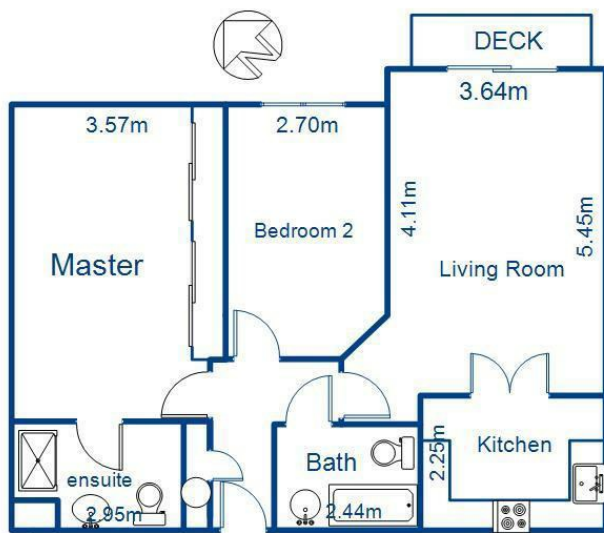

Mid Floor Flat 72Msq

ALL MEASUREMENTS ARE APPROXIMATE

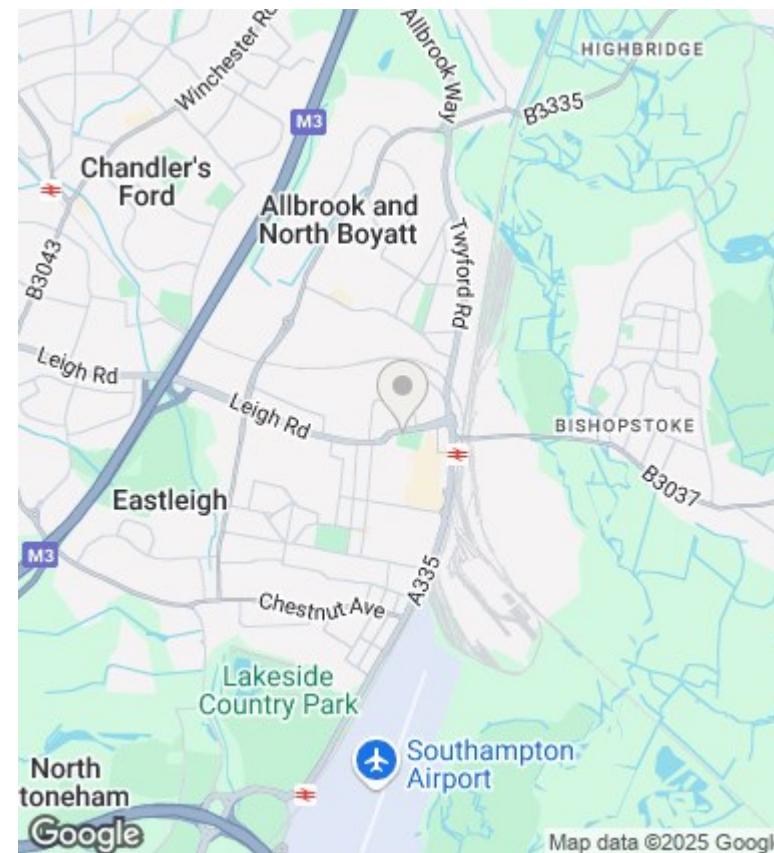

Directions

Viewings

Viewings by arrangement only. Call 02380 632632 to make an appointment.

Council Tax Band

B

EPC Rating:

B

Energy Efficiency Rating		
	Current	Potential
Very energy efficient - lower running costs		
(92 plus) A		
(81-91) B	82	82
(69-80) C		
(55-68) D		
(39-54) E		
(21-38) F		
(1-20) G		
Not energy efficient - higher running costs		
England & Wales	EU Directive 2002/91/EC	