



**RAWLINSON
&WEBBER.**

Chandlers Close, West Molesey
Asking Price £295,000 Leasehold

**RAWLINSON
&WEBBER**

**RAWLINSON
&WEBBER**

Property Description

A good sized 2 bedroom, first floor apartment located in this modern, purpose built development close to Molesey Heath and within easy proximity to the local High Street which offers numerous, useful amenities.

The property has a secure intercom system and there are communal grounds including some resident parking bays, plus some visitor parking as well. In addition, there is a bike and bin store for general use

Shops, (including a pharmacy and a local Sainsburys nearby) can be found close by as well as a regular bus to Hampton Court and beyond including services to Kingston and Walton. There is also a church and a pub within easy reach.

Agent notes: There is an an option to buy a 50% share or as a whole, restricted to any final staircasing.

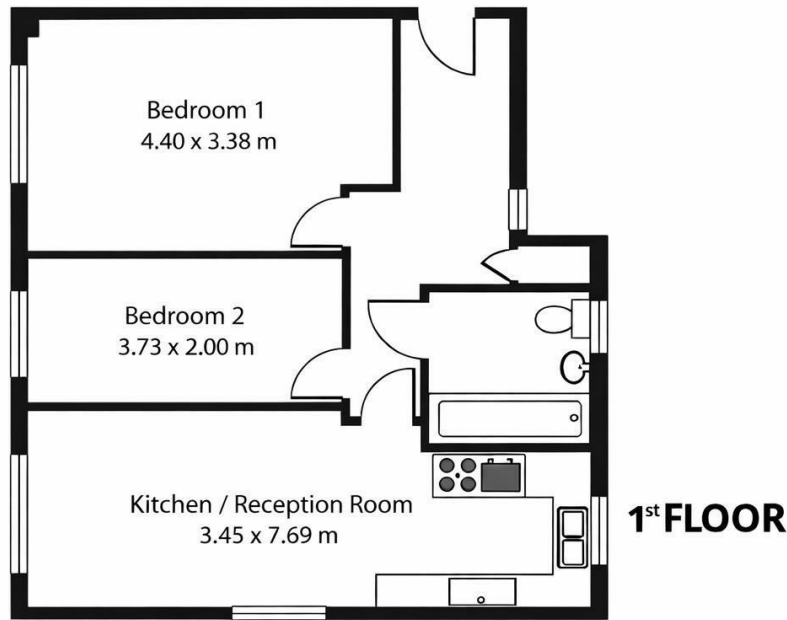

Features

- LOUNGE
- KITCHEN
- BATHROOM
- 2 BEDROOMS
- FIRST FLOOR
- MODERN AND PURPOSE BUILT
- SECURITY INTERCOM
- RESIDENT PARKING
- GAS CENTRAL HEATING
- DOUBLE-GLAZING

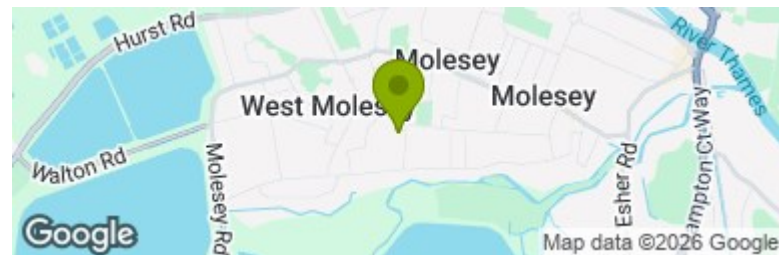

Energy Efficiency Rating		Current	Potential
Very energy efficient - lower running costs			
(92 plus) A			
(81-91) B			
(69-80) C		79	79
(54-68) D			
(39-54) E			
(21-38) F			
(1-20) G			
Not energy efficient - higher running costs			
England & Wales		EU Directive 2002/91/EC	

Council Tax Band:

C

EPC Rating:

C