



THE ESTATE COMPANY



William Court, Hall Road, St Johns Wood, NW8 9PB

Asking Price £749,950

- Larger Than Average One Bedroom Apartment
- 678 Sq Ft
- Third Floor
- Porter
- Lift
- Communal Gardens
- Reception Leading Into A Dinning Area
- Walking Distance to High Street & Underground Station

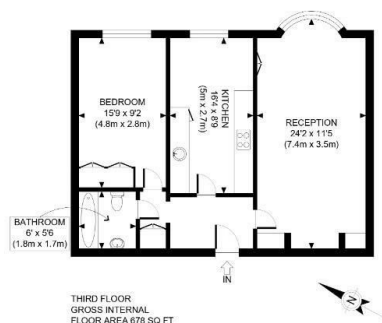

APPROX. GROSS INTERNAL FLOOR AREA: 678 SQ FT/ 63 SQM

PROPERTY PHOTO PLANS .CO.UK
ONE STOP SHOP FOR PROPERTY MARKETING

This plan is for illustrative purposes only and should be used as such by any prospective client. Whilst every attempt has been made to ensure the accuracy of the Floor Plan contained here, measurements of the doors, windows, rooms and any other items are approximate and no responsibility is taken for any errors, omissions, or misstatement. The services, systems and appliances shown have not been tested and no guarantee as to the operability or efficiency can be given.

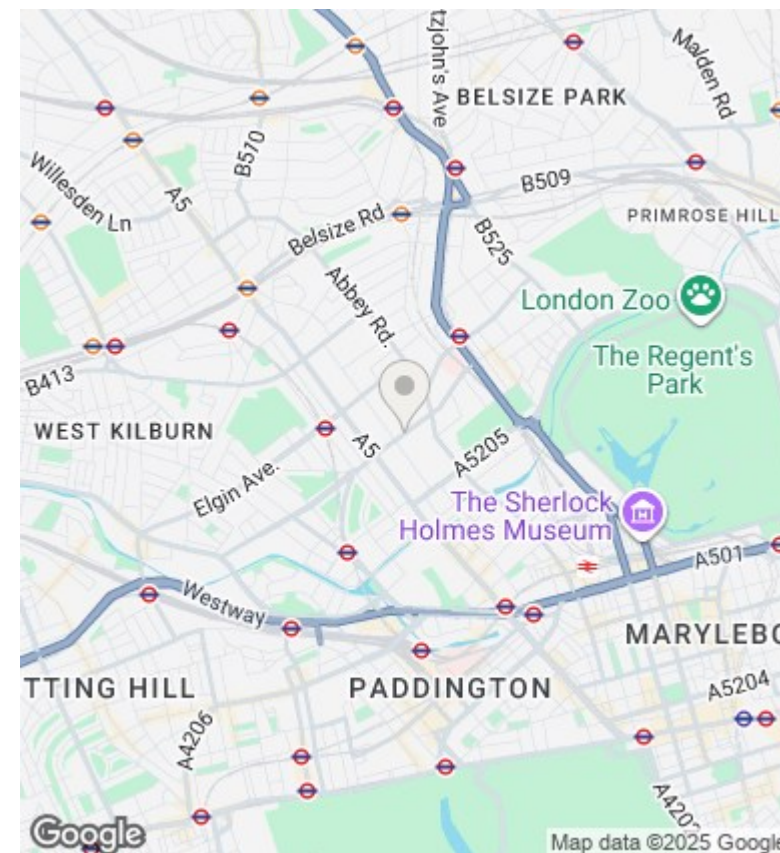

Directions

Viewings

Viewings by arrangement only. Call 020 7372 5000 to make an appointment.

Council Tax Band

B

EPC Rating:

C

Energy Efficiency Rating		
	Current	Potential
Very energy efficient - lower running costs		
(92 plus) A		
(81-91) B		
(69-80) C	75	82
(55-68) D		
(39-54) E		
(21-38) F		
(1-20) G		
Not energy efficient - higher running costs		
England & Wales	EU Directive 2002/91/EC	