

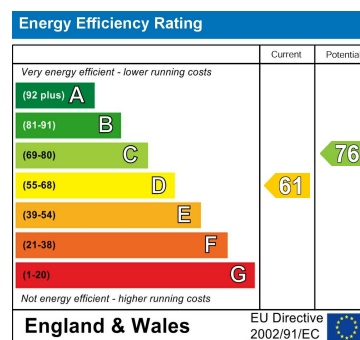

Clarence Street, Seaton Sluice

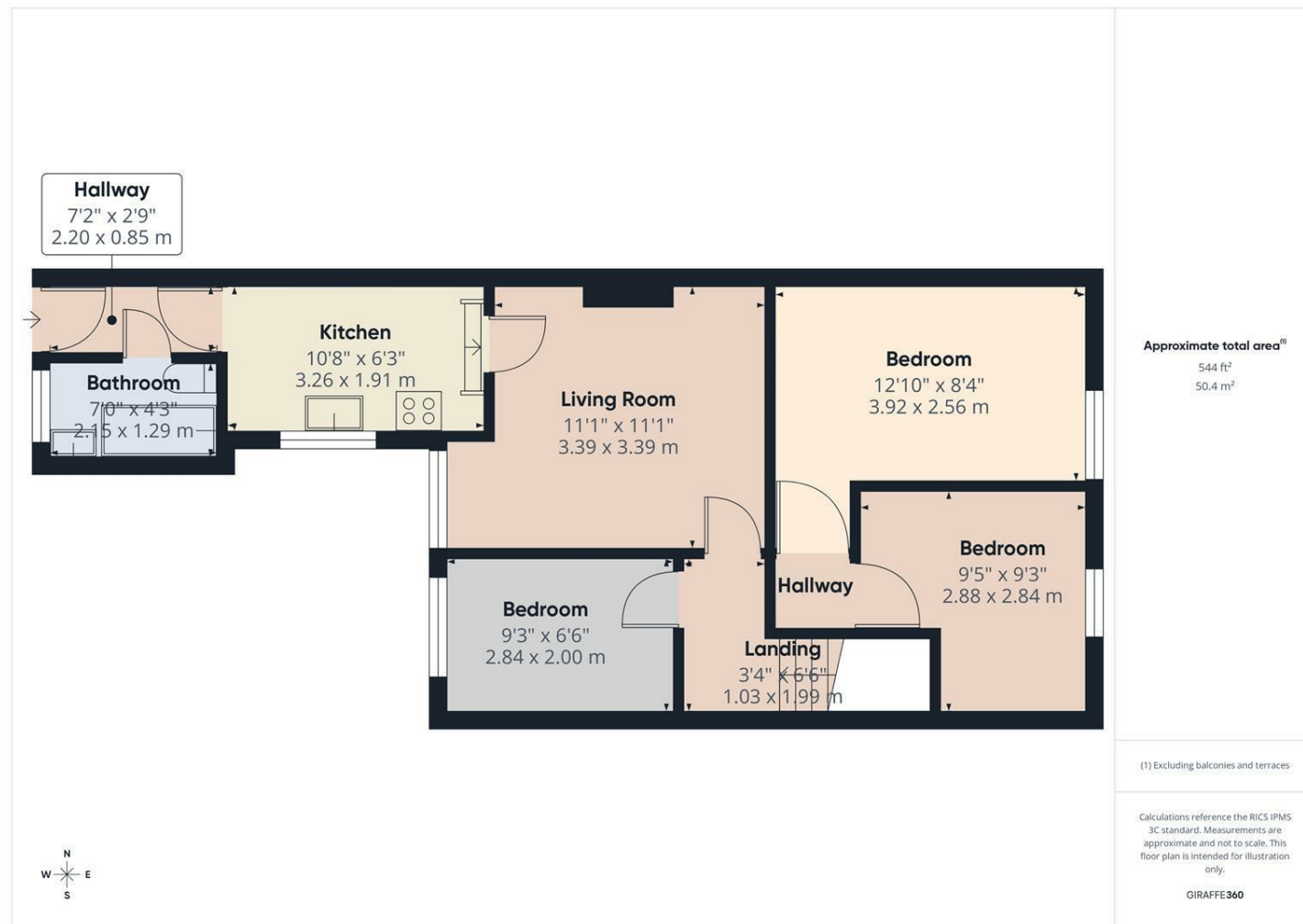

Important Information

All rooms have been measured with electronic laser and are approximate measurements only. None of the services to the above property have been tested by ourselves, and we cannot guarantee that the installations described in the details are in perfect working order. Brannen & Partners for themselves, the vendors or lessors, produce these brochures in good faith and are a guidelines only. They do not constitute any part of a contract and are correct to the best of our knowledge at the time of going to press. Pictures may appear distorted due to enlargement and are not to be used to give an accurate reflection of size. All negotiations and payments are subject to contract.

Offers Over £105,000

Description

WELL PROPORTIONED THREE BEDROOM FIRST FLOOR FLAT SITUATED IN SEATON SLUICE

We welcome to the market this well proportioned three bedroom first floor flat which is situated within this popular residential area in Seaton Sluice. Benefitting from good sized accommodation, making an ideal purchase for a first time buyer, buy to let investor or downsizer.

Briefly comprising: Private entrance with stairs to the first floor landing which offers access to all rooms. The living room is a good size and overlooks the rear of the property, a door leads to the kitchen which has fitted wall and base units including an integrated gas hob, electric oven and extractor fan. An inner lobby off the kitchen has access out to the rear yard and to the bathroom which comprises a bath with shower over, hand basin and W.C.

To complete this property are three bedrooms which are all accessed from the main landing.

Externally to the rear is a shared yard.

Situated within this popular residential area, only minutes from the seafront. Seaton Sluice is an attractive coastal town within close proximity to the beautiful North East coastline, wide range of amenities, good schooling and excellent transportation links.

Private Entrance Hallway

Living Room
11'1" x 11'1"

Kitchen
10'8" x 6'3"

Bathroom
7'0" x 4'2"

Bedroom One
12'10" x 8'4"

Bedroom Two
9'5" x 9'3"

Bedroom Three
9'3" x 6'6"

Externally
To the rear is a shared yard.

Tenure
Leasehold

