

HUNTERS[®]

HERE TO GET *you* THERE

8 Levett Close, Isle Of Grain, Rochester, ME3 0EG

Asking Price £270,000

Property Images



HUNTERS[®]

HERE TO GET *you* THERE

Property Images



HUNTERS®

HERE TO GET *you* THERE

GROUND FLOOR
384 sq.ft. (35.7 sq.m.) approx.

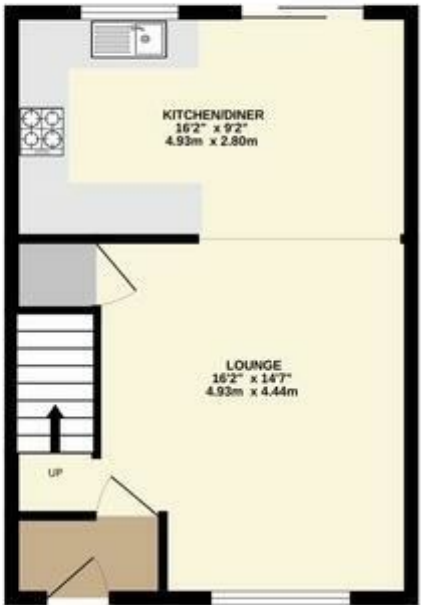

1ST FLOOR
384 sq.ft. (35.7 sq.m.) approx.

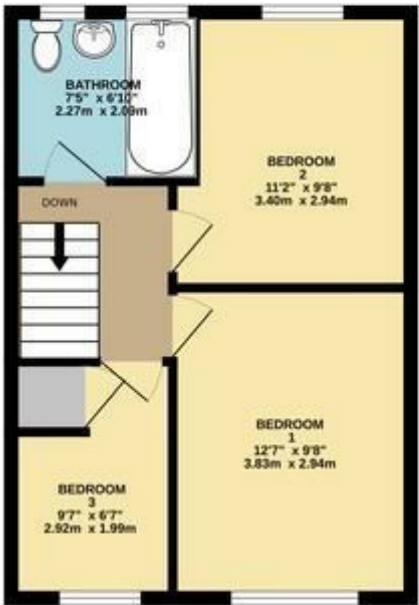

TOTAL FLOOR AREA : 769 sq.ft. (71.4 sq.m.) approx.

While every attempt has been made to ensure the accuracy of the floorplan contained here, measurements of doors, windows, rooms and any other items are approximate and no responsibility is taken for any error, omission or mis-statement. This plan is for illustrative purposes only and should be used as such by any prospective purchaser. The services, systems and appliances shown have not been tested and no guarantee as to their operability or efficiency can be given.
Made with floorplan 1/1/2025

EPC

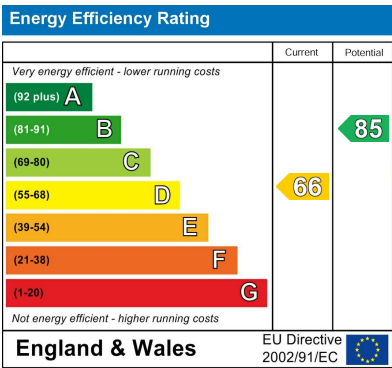

Map



Details

Type: House - End Terrace Beds: 3 Bathrooms: 1 Reception: 1 Tenure: Freehold

Summary

Welcome to this charming end terrace house located on Levett Close, Isle of Grain, Rochester. This delightful property offers a comfortable living space, making it an ideal home for families or first time buyers.

The house features a well proportioned open plan living/diner and kitchen, great for entertaining guests. With three good sized bedrooms, there is ample space for everyone to have their own sanctuary.

Additional benefits also include a bloc paved driveway to the front offering parking for two cars, a low maintenance garden and garage en bloc.

Whether you are a first time buyer or looking to settle down in a welcoming neighbourhood, this house presents a wonderful opportunity. With its generous living space, it is a property that truly deserves your attention.

Don't miss the chance to make this lovely house your new home!

Features

• END TERRACE • LOUNGE • KITCHEN/DINER • THREE BEDROOMS • DRIVEWAY TO FRONT • WELL PRESENTED • GREAT FIRST TIME PURCHASE • GARAGE EN BLOC • REAR GARDEN • EPC RATING D