

HUNTERS[®]

HERE TO GET *you* THERE



High Timber Street

London, EC4V 3PQ

£2,900 Per Calendar Month



Set within the exclusive Globe View riverside development, this stunning two double bedroom, two bathroom apartment offers refined City living at its best. The property features a sleek off-set modern kitchen, a spacious reception room opening onto a private balcony with views across the beautifully landscaped atrium, fitted wardrobes, wood flooring, and the benefit of a daytime concierge service.

Perfectly positioned in the heart of the City, the apartment is moments from Mansion House, Blackfriars, City Thameslink and St Paul's stations, providing superb transport connections.

The accommodation includes a generous living area, fully fitted and equipped kitchen, contemporary family bathroom, and a stylish ensuite shower room—ideal for professionals seeking comfort, convenience, and a touch of luxury.



Area Map

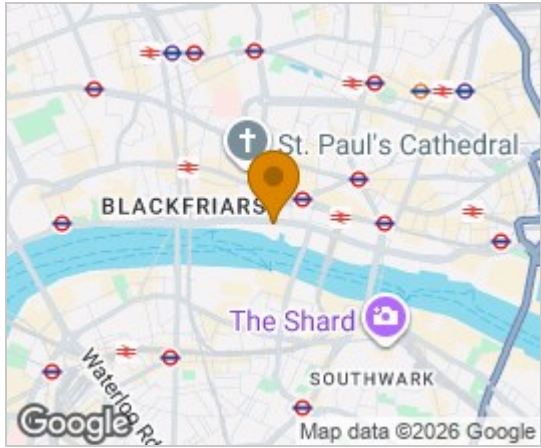

Floor Plans

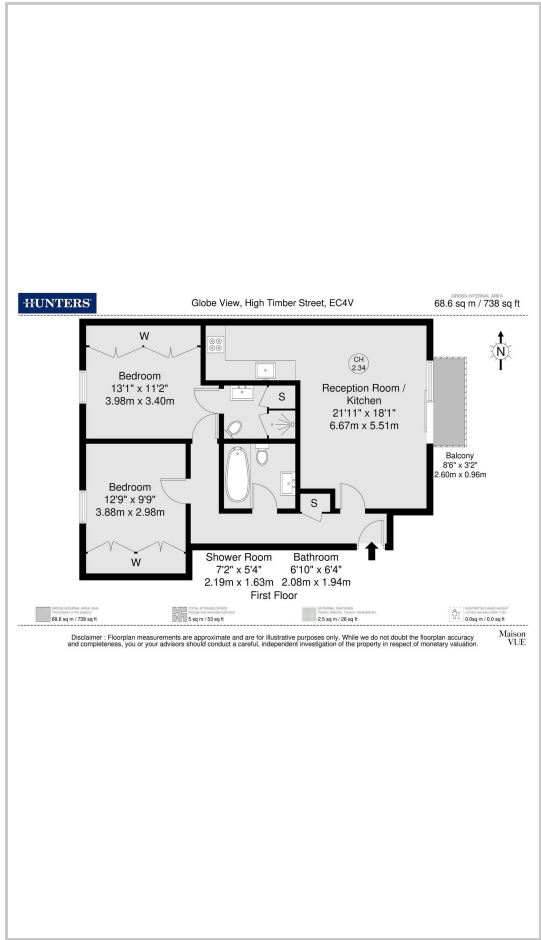

Energy Efficiency Graph

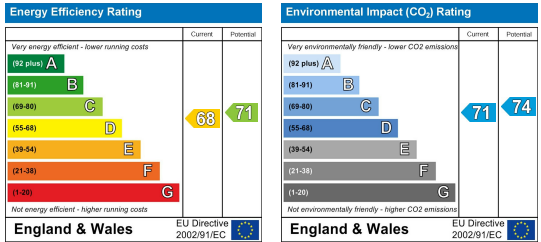

These particulars are intended to give a fair and reliable description of the property but no responsibility for any inaccuracy or error can be accepted and do not constitute an offer or contract. We have not tested any services or appliances (including central heating if fitted) referred to in these particulars and the purchasers are advised to satisfy themselves as to the working order and condition. If a property is unoccupied at any time there may be reconnection charges for any switched off/disconnected or drained services or appliances - All measurements are approximate. **THINKING OF SELLING?** If you are thinking of selling your home or just curious to discover the value of your property, Hunters would be pleased to provide free, no obligation sales and marketing advice. Even if your home is outside the area covered by our local offices we can arrange a Market Appraisal through our national network of Hunters estate agents.