



Kingsway North, , Leicester, LE3 3BF

- Three bedroom semi-detached home
- Open-plan lounge and dining
- Conservatory with garden view
- Enclosed garden
- Excellent transport links nearby
- Available now
- Fitted Kitchen
- Modern style bathroom suite
- Tandem garage and driveway
- Gas central heating and double glazing

£1,400 Per Month



Kingsway North, , Leicester, LE3 3BF

DESCRIPTION

Available Now To Rent – Spacious Family Home – Three Bedrooms – Conservatory – Driveway & Garage – Excellent Transport Links- Open Plan Lounge-Dining room

Available now, this well-presented and spacious home offers a comfortable and versatile living environment, ideally suited for families or couples seeking convenience and connectivity. Ideally located with excellent road and public transport links to the city, Fosse Park, and major motorways, the property is also close to local shops, schools, and Meridian Leisure Park.

The ground floor offers generous living space, with a bright lounge featuring a large bay window that fills the room with natural light, flowing seamlessly into a cosy dining room—perfect for both relaxing and entertaining. The modern kitchen is stylishly fitted with sleek cabinetry and integrated appliances, with direct access to the garden for added practicality. A light-filled conservatory to the rear provides additional flexible space, ideal for relaxing or informal dining while overlooking the garden.

Upstairs, three well-proportioned bedrooms offer comfortable accommodation, including a spacious principal bedroom with bay window, a second generous double, and a third room ideal as a study, nursery, or guest space. The modern bathroom is finished with contemporary fittings and tiled surfaces.

Externally, the rear garden offers a private space with lawn and mature greenery, while the property also benefits from a tandem garage and driveway providing ample parking. Further features include gas central heating and double glazing.

A bright, well-located home ready to move into—early viewing is highly recommended.





Ground Floor

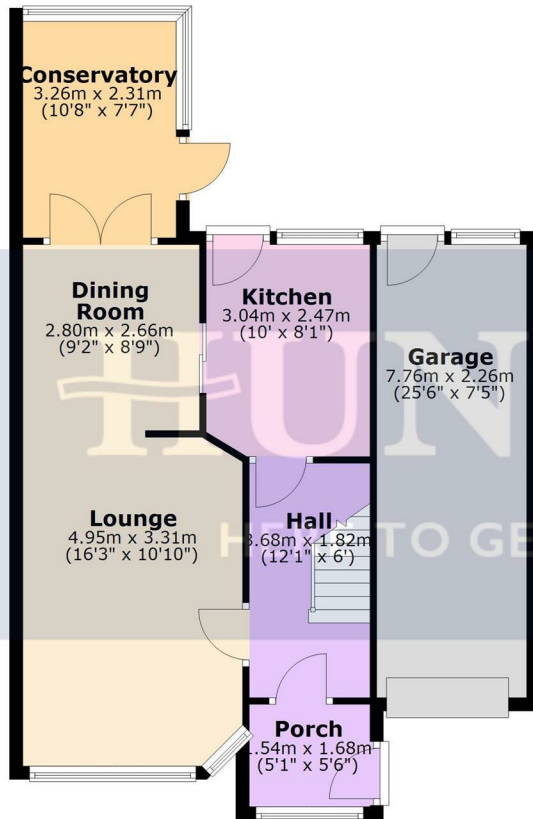

First Floor

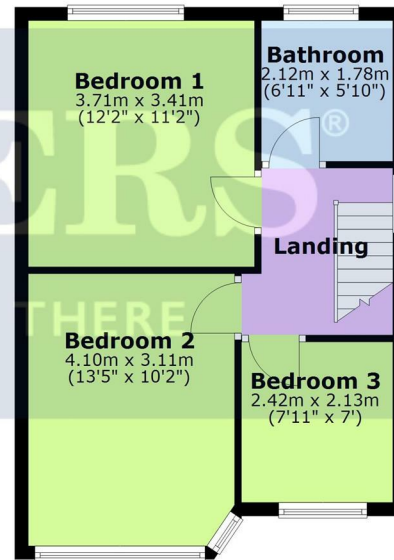

Total area: approx. 108.9 sq. metres (1172.3 sq. feet)

While every attempt has been made to ensure the accuracy of the floor plan herea, measurements of doors, windows, rooms or any other items are approximate and no responsibility is taken for any error, omission or mis-statement. The plan is for illustrative purpose only and should be used as such by any prospective purchaser or tenant. The services, systems and appliances have not been tested and no guarantee as to their operability or efficiency can be give. Plan produced using PlanUp.

Viewings

Please contact wigston@hunters.com, if you wish to arrange a viewing appointment for this property or require further information.

Valuations

For a valuation of your property, please email the team with your property details, contact information and the times you are available.

ENERGY PERFORMANCE CERTIFICATE

The energy efficiency rating is a measure of the overall efficacy of a home. The higher the rating the more energy efficient the home is and the lower the fuel bills will be.

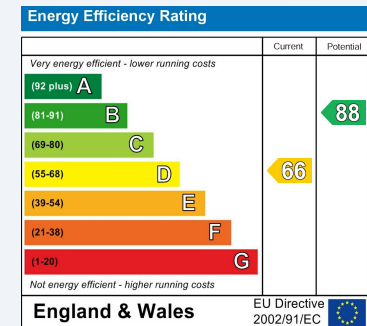

These particulars are intended to give a fair and reliable description of the property but no responsibility for any inaccuracy or error can be accepted and do not constitute an offer or contract. We have not tested any services or appliances (including central heating if fitted) referred to in these particulars and the purchasers are advised to satisfy themselves as to the working order and condition. If a property is unoccupied at any time there may be reconnection charges for any switched off/disconnected or drained services or appliances - All measurements are approximate.

THINKING OF SELLING? If you are thinking of selling your home or just curious to discover the value of your property, Hunters would be pleased to provide free, no obligation sales and marketing advice. Even if your home is outside the area covered by our local offices we can arrange a Market Appraisal through our national network of Hunters estate agents.