

HUNTERS®

HERE TO GET *you* THERE



Mottisfont Road

Abbey Wood, SE2 9LL

Guide Price £210,000 - £230,000



This well-located one-bedroom first-floor flat offers a practical and appealing option for first-time buyers, downsizers, or investors looking for a home with strong transport links and generous outdoor space.

Positioned just 0.3 miles from Abbey Wood Station, the property enjoys excellent access to the Elizabeth Line, Thameslink, and Southeastern services. Direct connections to Central London, Canary Wharf, and Heathrow Airport make commuting and city travel fast and convenient.

The flat is arranged to maximise both space and comfort, featuring a bright living room, a separate kitchen, a well-sized double bedroom, and a bathroom. The layout is functional and easy to maintain, offering a straightforward living environment suited to a variety of lifestyles.

A standout benefit is the larger-than-average private garden, providing an ideal setting for relaxing, entertaining, or enjoying outdoor space.



- COMMUNAL ENTRANCE
- ENTRANCE HALL
- LOUNGE 13'2 x 13'2 (4.01m x 4.01m)
- KITCHEN 9'10 x 8'6 (3.00m x 2.59m)
- BEDROOM 13'2 x 8'6 (4.01m x 2.59m)
- BATHROOM
- GARDEN

Area Map



Floor Plans

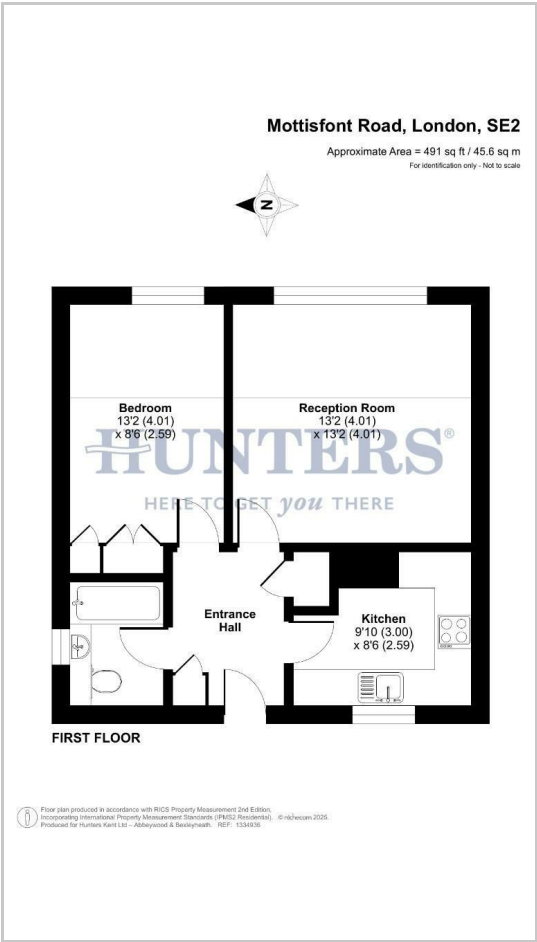

Energy Efficiency Graph

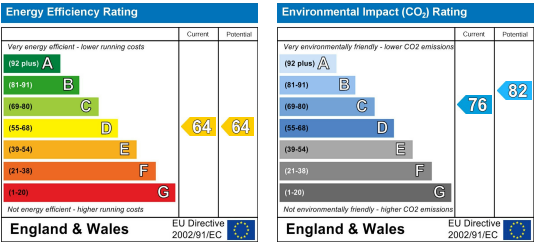

These particulars are intended to give a fair and reliable description of the property but no responsibility for any inaccuracy or error can be accepted and do not constitute an offer or contract. We have not tested any services or appliances (including central heating if fitted) referred to in these particulars and the purchasers are advised to satisfy themselves as to the working order and condition. If a property is unoccupied at any time there may be reconnection charges for any switched off/disconnected or drained services or appliances - All measurements are approximate.

THINKING OF SELLING? If you are thinking of selling your home or just curious to discover the value of your property, Hunters would be pleased to provide free, no obligation sales and marketing advice. Even if your home is outside the area covered by our local offices we can arrange a Market Appraisal through our national network of Hunters estate agents.