

# HUNTERS<sup>®</sup>

HERE TO GET *you* THERE



## Wessex Court

South East Road, Sholing, SO19 8PL

£825 Per Calendar Month



We are delighted to present this one bedroom apartment in the popular location of Sholing. The property comprises of open-plan kitchen/lounge, bathroom and double bedroom. Further benefits include communal garden, allocated and visitor parking, electric heating and double glazing. Available late January, offered unfurnished.



## ENTRANCE HALL

Built in airing cupboard, heater.

## KITCHEN 0'0" x 0'0" (0 x 0)

A range of base and wall units, stainless steel oven and extractor fan and electric hob. The flat also benefits from a full height fridge and a wood laminate floor.

## LOUNGE 0'0" x 0'0" (0 x 0)

Open plan living space to kitchen, Wood laminate floor and Double glazed windows to rear elevation.

## BEDROOM 0'0" x 0'0" (0 x 0)

Wood laminate floor and large double glazed window to rear elevation overlooking a grass area.

## BATHROOM 5'8" x 6'6" (1.73 x 1.98)

Comprised of panelled bath with mixer tap, electric shower attachment and curtain, close coupled WC and pedestal washhand basin. Double glazed window to side elevation.

## Area Map



## Floor Plans

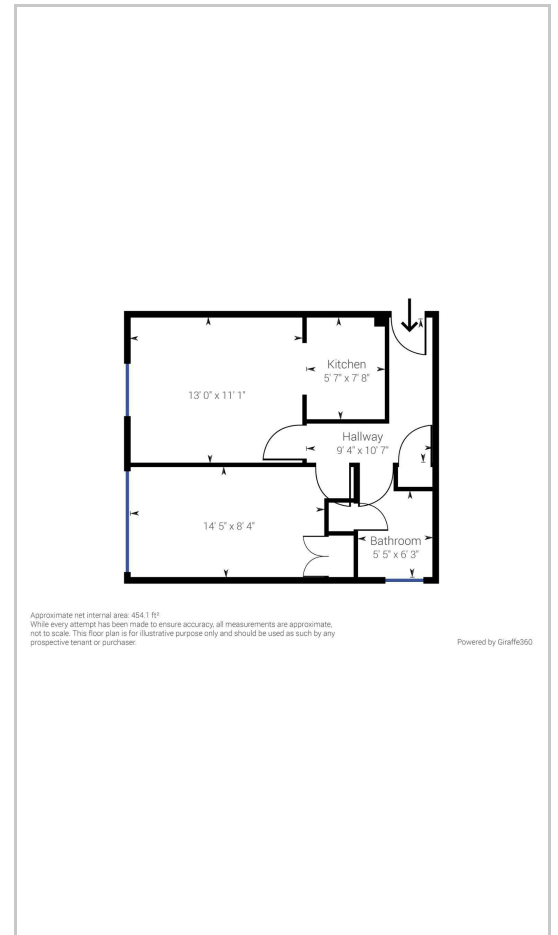

## Energy Efficiency Graph

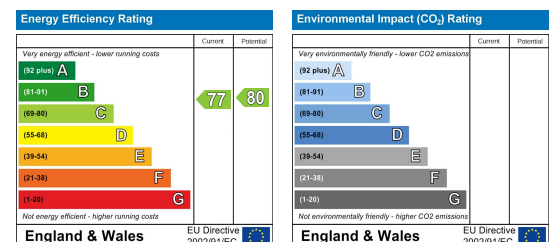

These particulars are intended to give a fair and reliable description of the property but no responsibility for any inaccuracy or error can be accepted and do not constitute an offer or contract. We have not tested any services or appliances (including central heating if fitted) referred to in these particulars and the purchasers are advised to satisfy themselves as to the working order and condition. If a property is unoccupied at any time there may be reconnection charges for any switched off/disconnected or drained services or appliances - All measurements are approximate. **THINKING OF SELLING?** If you are thinking of selling your home or just curious to discover the value of your property, Hunters would be pleased to provide free, no obligation sales and marketing advice. Even if your home is outside the area covered by our local offices we can arrange a Market Appraisal through our national network of Hunters estate agents.

35 Bedford Place, Southampton, SO15 2DG

Tel: 02380 987720 Email: southampton@hunters.com <https://www.hunters.com>