

HUNTERS[®]

HERE TO GET *you* THERE



Boulevard View

Whitchurch Lane, Bristol, BS14 0TN

£1,150 Per Month



A superb two-bedroom apartment available to let — perfect for professionals, couples, or small families.

Combining modern style with everyday convenience, this well-presented home is ideally situated close to public transport links, local schools, and a wide range of amenities.

Step inside to a bright entrance hallway that leads into a spacious open-plan living area, ideal for both relaxing and entertaining. The contemporary kitchen offers plenty of space for cooking and dining, and there is a handy storage cupboard for added practicality.

Both bedrooms are generously sized and versatile — suitable as comfortable double rooms or adaptable for a home office.

Additional benefits include an allocated parking space and secure bike storage.

With excellent access for commuting, school runs, and daily essentials, this property offers a fantastic blend of comfort and convenience.



Area Map



Floor Plans

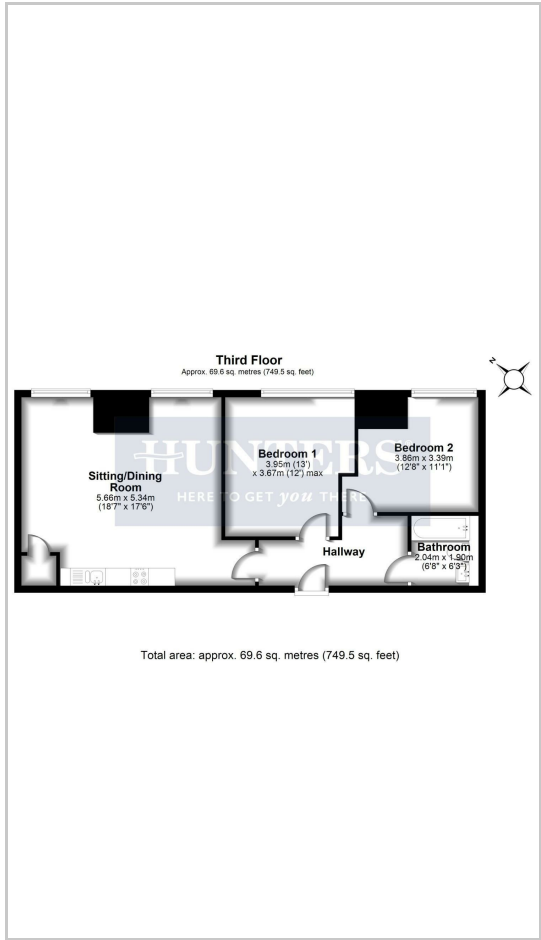

Energy Efficiency Graph

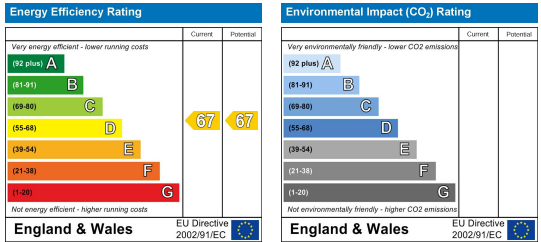

These particulars are intended to give a fair and reliable description of the property but no responsibility for any inaccuracy or error can be accepted and do not constitute an offer or contract. We have not tested any services or appliances (including central heating if fitted) referred to in these particulars and the purchasers are advised to satisfy themselves as to the working order and condition. If a property is unoccupied at any time there may be reconnection charges for any switched off/disconnected or drained services or appliances - All measurements are approximate. **THINKING OF SELLING?** If you are thinking of selling your home or just curious to discover the value of your property, Hunters would be pleased to provide free, no obligation sales and marketing advice. Even if your home is outside the area covered by our local offices we can arrange a Market Appraisal through our national network of Hunters estate agents.