



**HUNTERS**<sup>®</sup>  
HERE TO GET *you* THERE

2 Elvard Close, Bristol, BS13 9BT

## 2 Elvard Close, Bristol, BS13 9BT

£250,000

Situated in a peaceful cul-de-sac on Elvard Close, Bristol, this three-bedroom semi-detached home offers an exciting opportunity to create a property tailored to your own style and needs. Ideal for families, first-time buyers, or investors, the home provides generous living space and excellent potential throughout.

The property features two well-proportioned reception rooms, offering flexibility for both comfortable living and entertaining, whether as a cosy lounge, formal dining room, or a combination of both.

Upstairs, three spacious bedrooms provide ample accommodation. The bathroom is currently functional but would benefit from modernisation, presenting the perfect chance to personalise the space.

Externally, the home boasts a private driveway for convenient off-street parking, along with an enclosed rear garden—ideal for relaxing, gardening, or hosting family and friends.

Offered with no onward chain, this property ensures a smoother and faster purchase process. With scope for improvement throughout, this is a fantastic opportunity to transform a well-located house into a truly impressive home.

Hunters Bishopsworth 25 Highridge Road, Bristol, BS13 8HJ | 0117 244 4441  
bishopsworth@hunters.com | www.hunters.com

### Ground Floor

Approx. 47.3 sq. metres (508.7 sq. feet)

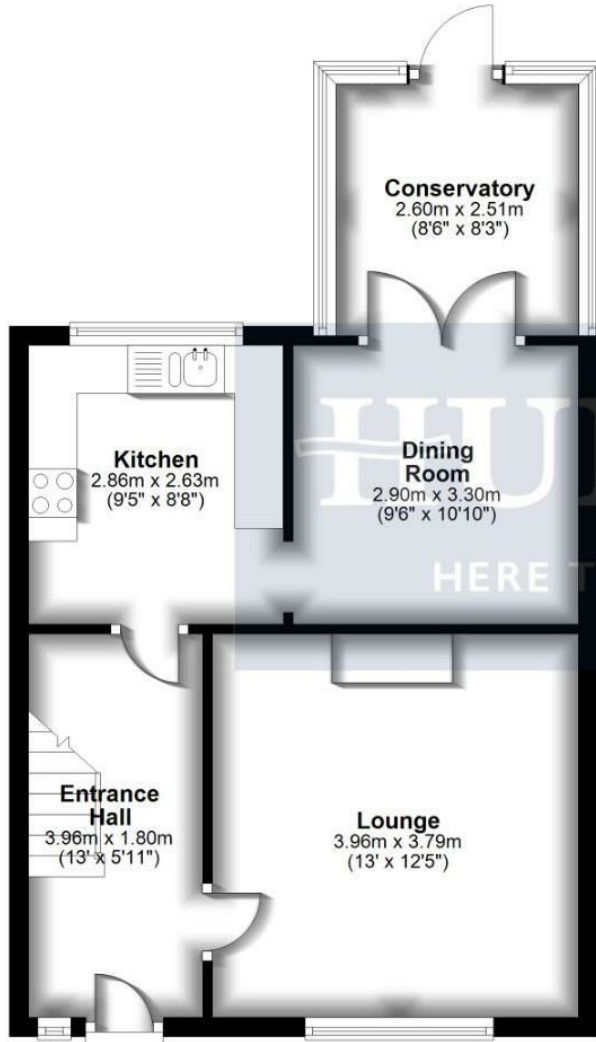

### First Floor

Approx. 39.6 sq. metres (426.4 sq. feet)

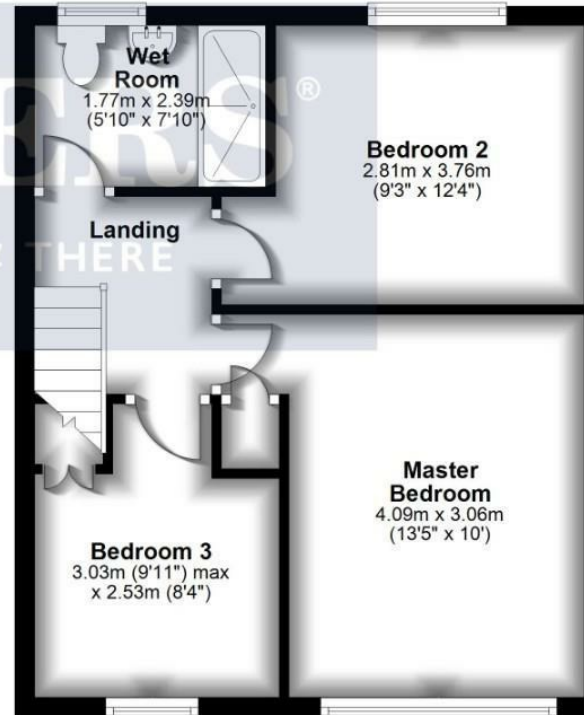

Total area: approx. 86.9 sq. metres (935.1 sq. feet)

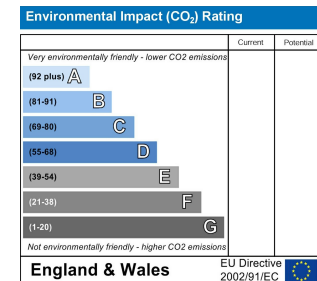
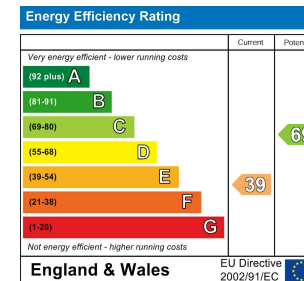

## Energy Efficiency Rating

	Current	Potential
<i>Very energy efficient - lower running costs</i>		
(92 plus) <b>A</b>		
(81-91) <b>B</b>		
(69-80) <b>C</b>		69
(55-68) <b>D</b>		
(39-54) <b>E</b>	39	
(21-38) <b>F</b>		
(1-20) <b>G</b>		
<i>Not energy efficient - higher running costs</i>		
<b>England &amp; Wales</b>	EU Directive 2002/91/EC	

These particulars are intended to give a fair and reliable description of the property but no responsibility for any inaccuracy or error can be accepted and do not constitute an offer or contract. We have not tested any services or appliances (including central heating if fitted) referred to in these particulars and the purchasers are advised to satisfy themselves as to the working order and condition. If a property is unoccupied at any time there may be reconnection charges for any switched off/disconnected or drained services or appliances - All measurements are approximate. If you are thinking of selling your home or just curious to discover the value of your property, Hunters would be pleased to provide free, no obligation sales and marketing advice. Even if your home is outside the area covered by our local offices we can arrange a Market Appraisal through our national network of Hunters estate agents.









