

HUNTERS®

HERE TO GET *you* THERE

New Road Side, Horsforth, LS18

Guide Price £230,000

Property Images



Property Images



Floorplan

New Road Side, Horsforth, Leeds, LS18

Approximate Area = 725 sq ft / 67.3 sq m

For identification only - Not to scale

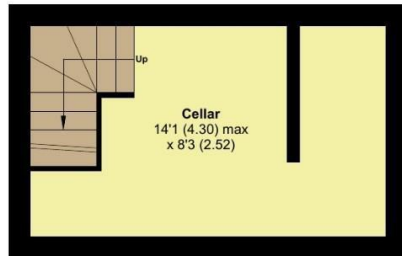

CELLAR
APPROX FLOOR
AREA 10.6 SQ M
(115 SQ FT)



GROUND FLOOR
APPROX FLOOR
AREA 28.3 SQ M
(305 SQ FT)

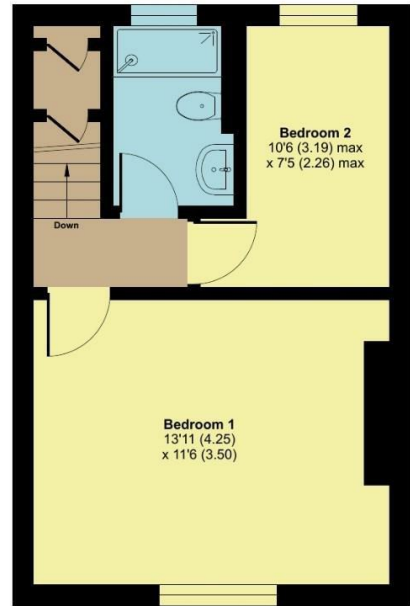

FIRST FLOOR
APPROX FLOOR
AREA 28.3 SQ M
(305 SQ FT)

Floor plan produced in accordance with RICS Property Measurement Standards incorporating International Property Measurement Standards (IPMS2 Residential). © nichecom 2025. Produced for Hunters Property Group. REF: 1332155

EPC

Energy Efficiency Rating		
	Current	Potential
Very energy efficient - lower running costs		
(92 plus) A		
(81-91) B		
(69-80) C		
(55-68) D		
(39-54) E		
(21-38) F		
(1-20) G		
Not energy efficient - higher running costs		
	64	75
England & Wales	EU Directive 2002/91/EC	

Map

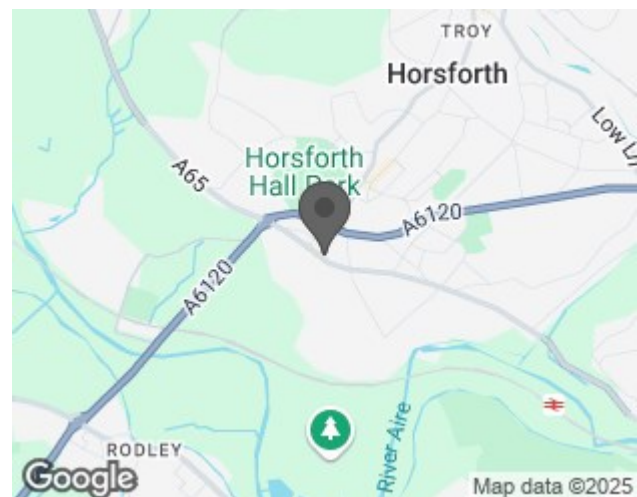

Details

Type: House - Mid Terrace Beds: 2 Bathrooms: 1 Receptions: 2 Tenure: Freehold

Summary

Stylish Two-Bedroom Stone Terrace in the Heart of Horsforth

Welcome to New Road Side, Horsforth – a beautifully presented two-bedroom mid-stone terrace home, perfectly positioned in one of the area's most sought-after locations. Just a stone's throw from the vibrant bars, restaurants, cafés, and boutique shops of central Horsforth, this is a prime spot for young professionals and first-time buyers alike.

Move-in ready and packed with charm, this delightful home combines modern interiors with period character, offering the perfect blend of comfort and convenience.

Key Features:

- **Inviting Living Room** – A stylish, welcoming space with a modern electric fire, tasteful décor, and built-in shelving within the alcove – ideal for relaxing or entertaining.
- **Bright, Well-Equipped Kitchen** – Thoughtfully designed with ample storage and worktop space, this light-filled kitchen also provides access to the rear garden and a cellar for additional storage.
- **Spacious Master Bedroom** – Elegantly decorated, this large double bedroom offers the perfect place to unwind after a long day.
- **Second Bedroom** – A peaceful single room with tranquil views over the rear allotments – perfect as a guest room, nursery, or home office.
- **Contemporary Shower Room** – Fully tiled with a sleek walk-in shower, handy inset shelf, WC, and a modern vanity unit.
- **Outdoor Space** – To the front, a small elevated garden from the roadside. At the rear, enjoy a low-maintenance garden, perfect for summer BBQs and relaxing with friends and family in a peaceful setting.
- **On-Street Parking & Rear Access** – The property benefits from ownership of part of the rear lane, offering both access and valuable parking options.

Set in the heart of New Road Side, Horsforth, this home offers a lifestyle of ease and accessibility. Whether you're grabbing a coffee, meeting friends for dinner, or hopping on a nearby transport link – everything is right at your doorstep.

Don't miss this fantastic opportunity to own a home in one of Leeds' most desirable suburbs. Call today to arrange your viewing – and get ready to unpack and start living the Horsforth life.

Welcome home!

Features

- TWO BEDROOM • MID STONE TERRACE • CENTRAL HORSFORTH LOCATION • MOVE IN READY • MODERN DECOR THROUGHOUT • GARDENS TO FRONT AND REAR • EPC RATING:- • COUNCIL TAX BAND:- B