

HUNTERS[®]

HERE TO GET *you* THERE



Utah Building

Deals Gateway, London, SE13 7RP

£1,995 Per Month



We are delighted to offer this stunning apartment located stone's throw away from Greenwich Park and all amenities Greenwich has to offer.

The apartment offers a spacious open plan reception room with modern kitchen, large double bedrooms and two bathrooms. The apartment also benefits from floor to ceiling windows, wooden floors and neutral décor throughout.

Further benefits include on site concierge, gym and swimming pool.



Area Map

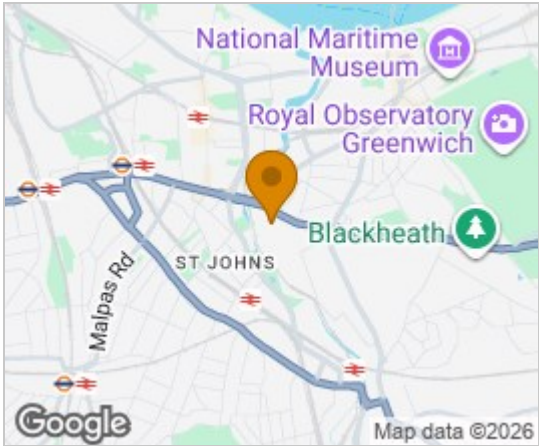

Floor Plans

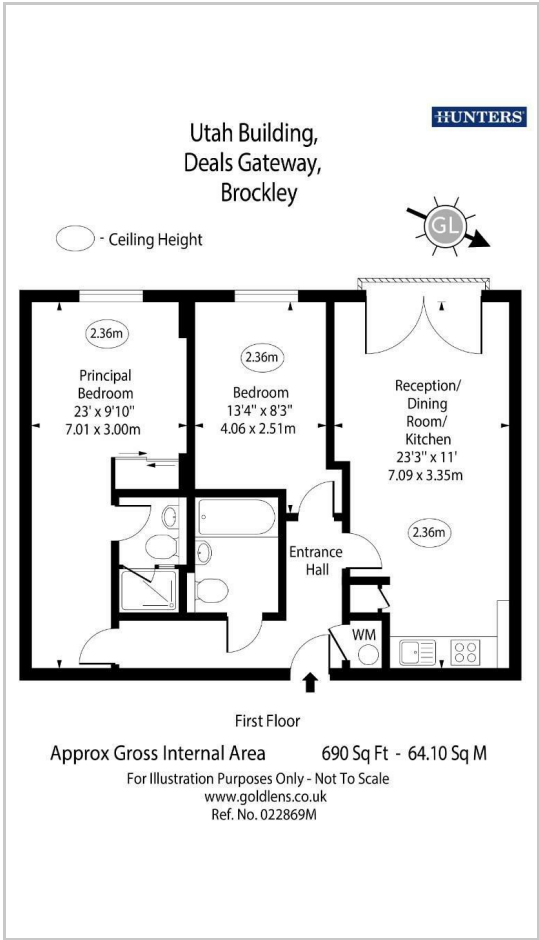

Energy Efficiency Graph

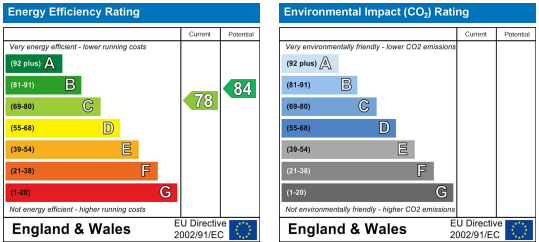

These particulars are intended to give a fair and reliable description of the property but no responsibility for any inaccuracy or error can be accepted and do not constitute an offer or contract. We have not tested any services or appliances (including central heating if fitted) referred to in these particulars and the purchasers are advised to satisfy themselves as to the working order and condition. If a property is unoccupied at any time there may be reconnection charges for any switched off/disconnected or drained services or appliances - All measurements are approximate.

THINKING OF SELLING? If you are thinking of selling your home or just curious to discover the value of your property, Hunters would be pleased to provide free, no obligation sales and marketing advice. Even if your home is outside the area covered by our local offices we can arrange a Market Appraisal through our national network of Hunters estate agents.