

HUNTERS[®]

HERE TO GET *you* THERE



Milton Garden Estate

London, N16 8TS

£2,195 Per Month



HOT WATER AND HEATING INCLUDED!!!

This spacious two bedroom flat, with spectacular views over London, is set on the 8th floor within this purpose built block.

Accommodation comprises of bright and airy reception room, separate kitchen, two double bedrooms, bathroom and separate WC.

Property further benefits from double glazing throughout, balcony and ample storage.

Located on Milton Gardens, only moments from the many bars, restaurants and coffee houses of Stoke Newington Church Street, Newington Green and trendy Dalston, Butterfield Green and a short walk from the wide open spaces of Clissold Park. Transport links include, Canonbury Station (Overground), Dalston Kingsland & Junction Stations (Overground) and a variety of bus routes into The City and West End



Reception
 Bedroom
 Bedroom.
 Kitchen

Area Map

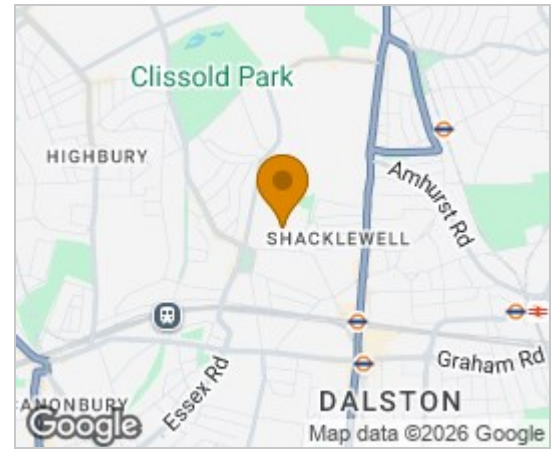

Floor Plans

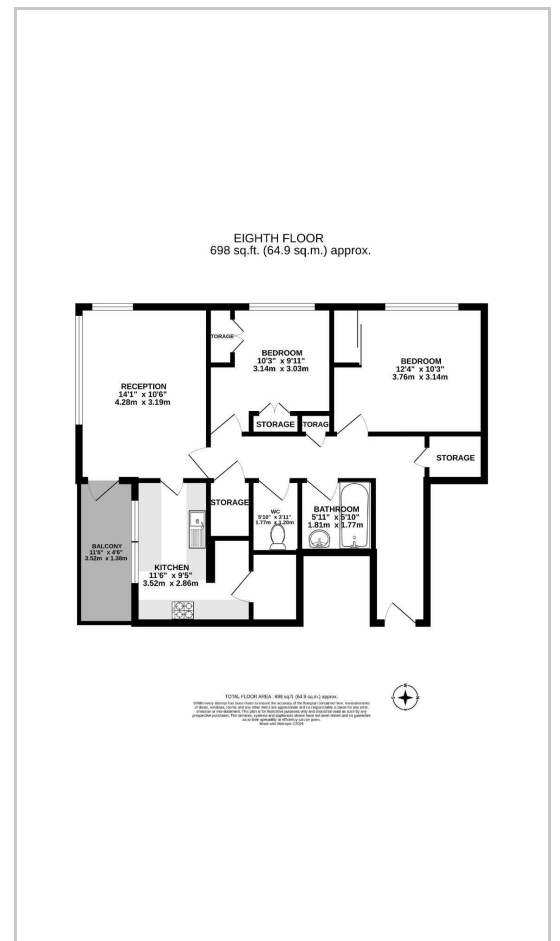

Energy Efficiency Graph

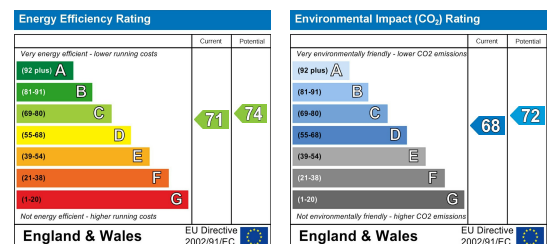

These particulars are intended to give a fair and reliable description of the property but no responsibility for any inaccuracy or error can be accepted and do not constitute an offer or contract. We have not tested any services or appliances (including central heating if fitted) referred to in these particulars and the purchasers are advised to satisfy themselves as to the working order and condition. If a property is unoccupied at any time there may be reconnection charges for any switched off/disconnected or drained services or appliances - All measurements are approximate. **THINKING OF SELLING?** If you are thinking of selling your home or just curious to discover the value of your property, Hunters would be pleased to provide free, no obligation sales and marketing advice. Even if your home is outside the area covered by our local offices we can arrange a Market Appraisal through our national network of Hunters estate agents.