

# HUNTERS<sup>®</sup>

HERE TO GET *you* THERE



## Green Lanes Walk

Finsbury Park, N4 2GA

£2,695 Per Month

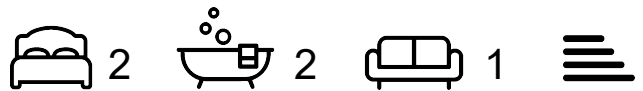

Set within a superb modern development, this contemporary two bedroom flat offers ample living space with modern fixtures and fittings, and truly stunning view rarely found in London.

Situated on third floor with lift, the property comprises light and spacious reception room with open-plan kitchen, excellent master bedroom with en suite bathroom, second double bedroom, bathroom and balcony overlooking The New River West Reservoir.

Hythe House is conveniently located on Green Lanes and benefits from transport links such as, Manor House Station (Piccadilly Line) and a variety of bus routes in to The City and West End.



## Area Map



## Floor Plans

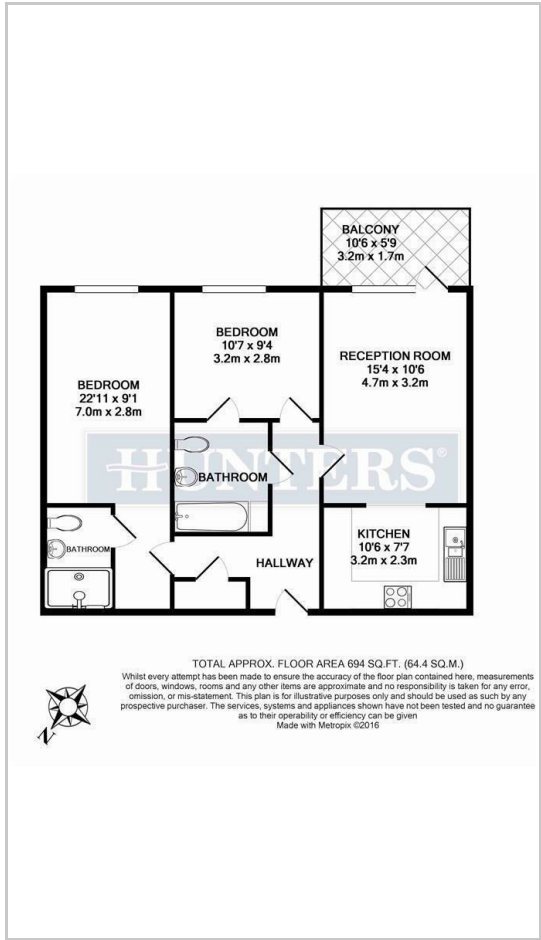

## Energy Efficiency Graph



These particulars are intended to give a fair and reliable description of the property but no responsibility for any inaccuracy or error can be accepted and do not constitute an offer or contract. We have not tested any services or appliances (including central heating if fitted) referred to in these particulars and the purchasers are advised to satisfy themselves as to the working order and condition. If a property is unoccupied at any time there may be reconnection charges for any switched off/disconnected or drained services or appliances - All measurements are approximate. **THINKING OF SELLING?** If you are thinking of selling your home or just curious to discover the value of your property, Hunters would be pleased to provide free, no obligation sales and marketing advice. Even if your home is outside the area covered by our local offices we can arrange a Market Appraisal through our national network of Hunters estate agents.