

# HUNTERS®

HERE TO GET *you* THERE



## Marsh Wall

London, E14 9AX

£1,850 Per Calendar Month



A modern one bedroom apartment set on the 7th floor of a secure contemporary development, boasting a bright reception room/open plan kitchen and with amazing views. Internal accommodation is a generous 414 sq.ft (38.5 sq.m)

Whitby House benefits from being moments from the fantastic selection of shops, bars and restaurants in Canary Wharf while being close to the River Thames. Connectivity to public transport is ample with access to tube, DLR, bus network and even Thames clipper all close by. The nearest stations are Heron Quay DLR and Canary Wharf tube within a short walking distance.

Make the most of this prime location with access to an array of retail shopping, bars and restaurants on your doorstep.



Area Map

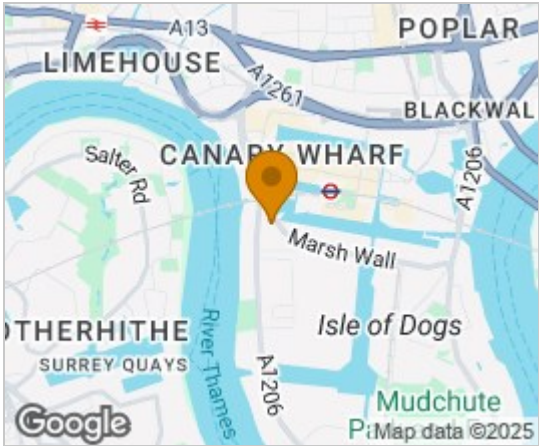

Floor Plans

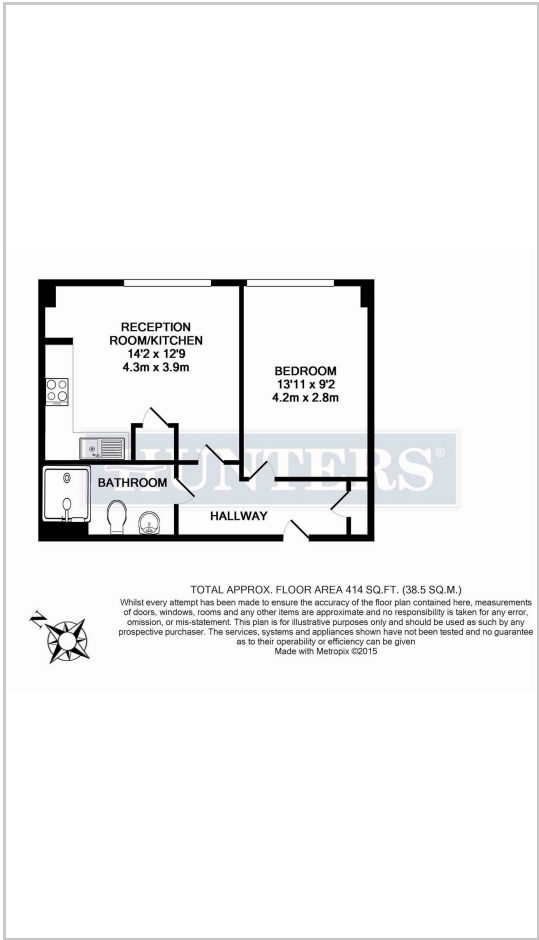

Energy Efficiency Graph

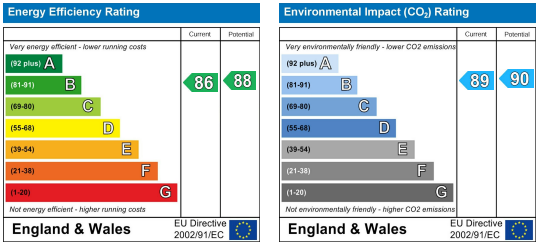

These particulars are intended to give a fair and reliable description of the property but no responsibility for any inaccuracy or error can be accepted and do not constitute an offer or contract. We have not tested any services or appliances (including central heating if fitted) referred to in these particulars and the purchasers are advised to satisfy themselves as to the working order and condition. If a property is unoccupied at any time there may be reconnection charges for any switched off/disconnected or drained services or appliances - All measurements are approximate.

**THINKING OF SELLING?** If you are thinking of selling your home or just curious to discover the value of your property, Hunters would be pleased to provide free, no obligation sales and marketing advice. Even if your home is outside the area covered by our local offices we can arrange a Market Appraisal through our national network of Hunters estate agents.