

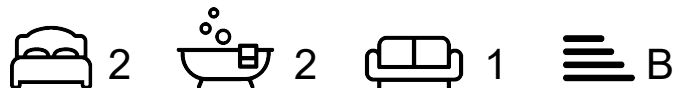

42 Newnton Close

London, N4 2GT

£3,495 Per Month



*** SHORT TERM RENTAL FOR 3 MONTHS ***

Available to view by appointment only is this exceptional two double bedroom, two bathroom apartment situated on the second floor (with lift access) of this modern building boasting over 850 sq. ft. (80 sqm.) of luxury accommodation.

The Shoreline Building, is situated on Newnton Close within moments of Woodberry Wetlands Nature Reserve, the apartment is conveniently situated off Seven Sisters Road, located moments from the many bars, restaurants and coffee houses of Stoke Newington Church Street, vibrant Harringay Green Lanes, and the wide-open spaces of both Finsbury and Clissold Park. The property also benefits from an array of local amenities including Sainsbury's Local, independent corner stores, cafes, Post Office, ATM, dry cleaners, GP practices, restaurants, the Castle Climbing Centre and the West Reservoir Water sports Centre.

Transport links include Manor House tube (Piccadilly Line), Finsbury Park Station (National Rail, Thameslink, Piccadilly & Victoria Lines) and a variety of bus routes into The City & West End.



Area Map

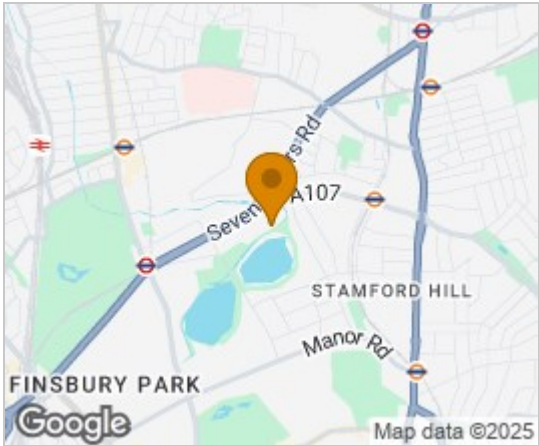

Floor Plans

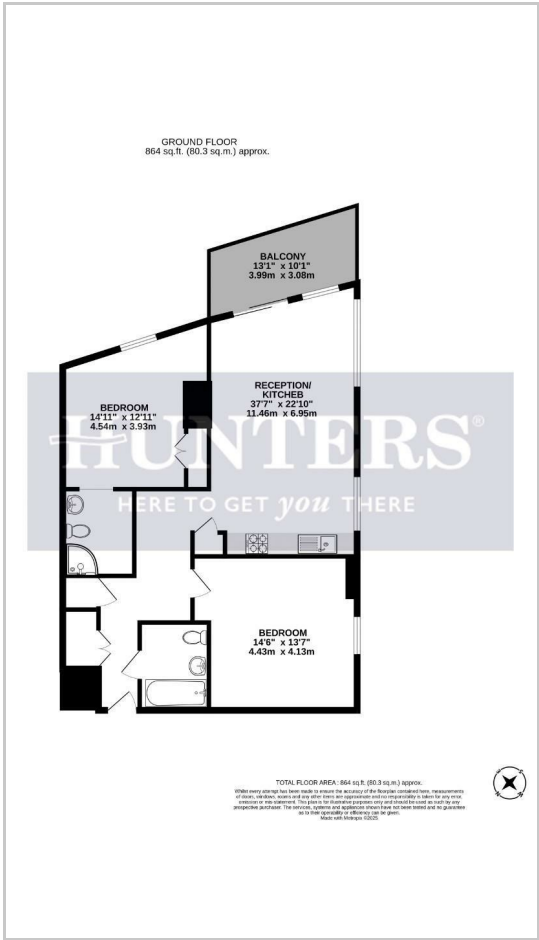

Energy Efficiency Graph

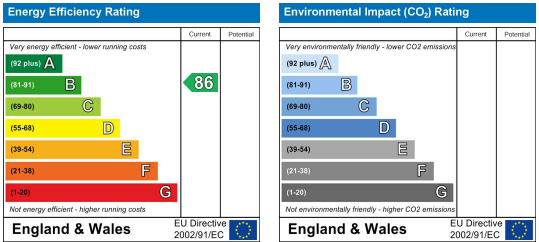

These particulars are intended to give a fair and reliable description of the property but no responsibility for any inaccuracy or error can be accepted and do not constitute an offer or contract. We have not tested any services or appliances (including central heating if fitted) referred to in these particulars and the purchasers are advised to satisfy themselves as to the working order and condition. If a property is unoccupied at any time there may be reconnection charges for any switched off/disconnected or drained services or appliances - All measurements are approximate. **THINKING OF SELLING?** If you are thinking of selling your home or just curious to discover the value of your property, Hunters would be pleased to provide free, no obligation sales and marketing advice. Even if your home is outside the area covered by our local offices we can arrange a Market Appraisal through our national network of Hunters estate agents.