

Westbrooke Crescent, , Welling, DA16 1PU

- In need of updating
- Spacious accomodation
- Shower room & bathroom
- Extended kitchen
- Floor Area: 1009 sq ft
- Good size plot
- Three bedrooms
- Extended lounge & separate dining room
- Call Hunters to view
- EPC Rating: D

Offers Over £450,000



Westbrooke Crescent, , Welling, DA16 1PU

DESCRIPTION

Nestled in the desirable Westbrooke Crescent in Welling, this semi-detached house presents an excellent opportunity for those looking to create their dream home. Spanning an impressive 1,009 square feet, this property boasts a spacious layout that is perfect for families or those seeking extra room to grow.

The ground floor features a welcoming entrance that leads to two generous reception rooms, including an extended lounge that offers ample space for relaxation and entertaining. The dining room is perfect for family meals, while the kitchen provides a functional area for culinary pursuits. Additionally, a convenient shower room is located on this level, enhancing the practicality of the home.

Upstairs, you will find three well-proportioned bedrooms, complemented by a family bathroom, making it ideal for both family living and guest accommodation. The property is in need of updating, allowing you to personalise the space to your taste and style.

The outdoor space is equally appealing, with a front garden that has the potential to be transformed into a driveway, providing off-street parking. The plot is spacious, offering opportunities for further development, subject to the necessary permissions.

Situated in a great location, this home is close to local schools, shops, and transport links, including Welling train station, making commuting a breeze. Danson Park is also nearby, providing a lovely green space for outdoor activities.

This extended semi-detached home is a fantastic opportunity for those looking to invest in a property with great potential. We invite you to call Hunters to arrange a viewing and explore the possibilities that await you in this charming Welling residence.





Westbrooke Crescent, Welling, DA16

Approximate Area = 1009 sq ft / 93.7 sq m

For identification only - Not to scale

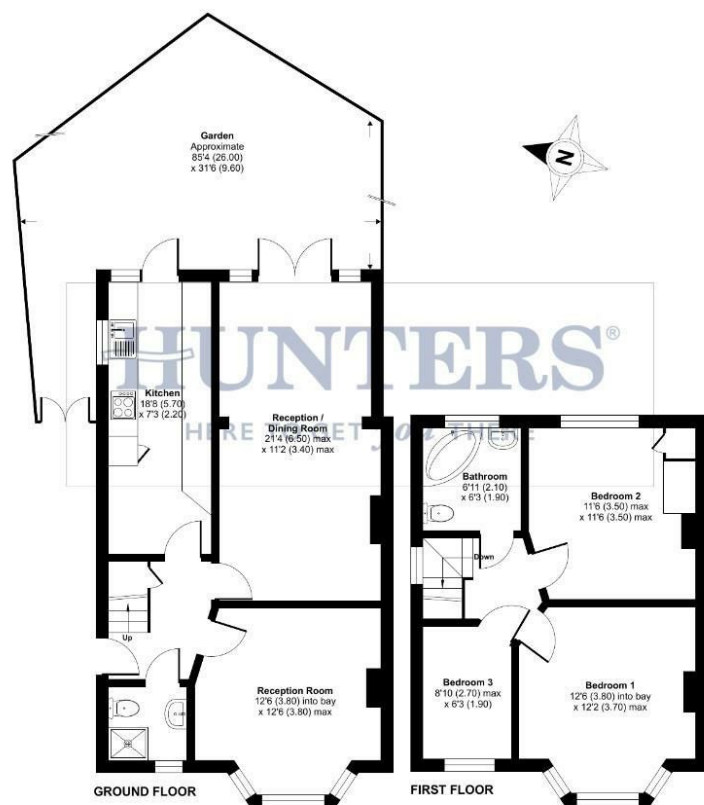

Floor plan produced in accordance with RICS Property Measurement 2nd Edition, incorporating International Property Measurement Standards (IPMS2 Residential). Produced for Hunters Welling - Cross & Warren Enterprises Ltd. REF: 1344/802. © nichcom 2025.

Viewings

Please contact welling@hunters.com, if you wish to arrange a viewing appointment for this property or require further information.

Valuations

For a valuation of your property, please email the team with your property details, contact information and the times you are available.

ENERGY PERFORMANCE CERTIFICATE

The energy efficiency rating is a measure of the overall efficacy of a home. The higher the rating the more energy efficient the home is and the lower the fuel bills will be.

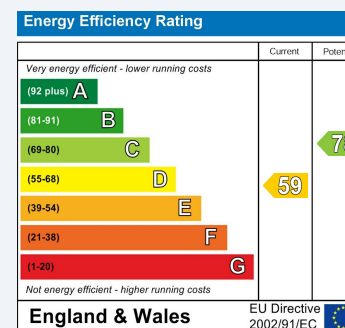

These particulars are intended to give a fair and reliable description of the property but no responsibility for any inaccuracy or error can be accepted and do not constitute an offer or contract. We have not tested any services or appliances (including central heating if fitted) referred to in these particulars and the purchasers are advised to satisfy themselves as to the working order and condition. If a property is unoccupied at any time there may be reconnection charges for any switched off/disconnected or drained services or appliances - All measurements are approximate.

THINKING OF SELLING? If you are thinking of selling your home or just curious to discover the value of your property, Hunters would be pleased to provide free, no obligation sales and marketing advice. Even if your home is outside the area covered by our local offices we can arrange a Market Appraisal through our national network of Hunters estate agents.