

# HUNTERS®

HERE TO GET *you* THERE

**641 Whitchurch Lane, Whitchurch, Bristol, BS14 0TA**

**£285,000**

**Property Images**





# HUNTERS®

HERE TO GET *you* THERE

## Property Images



# HUNTERS®

HERE TO GET *you* THERE

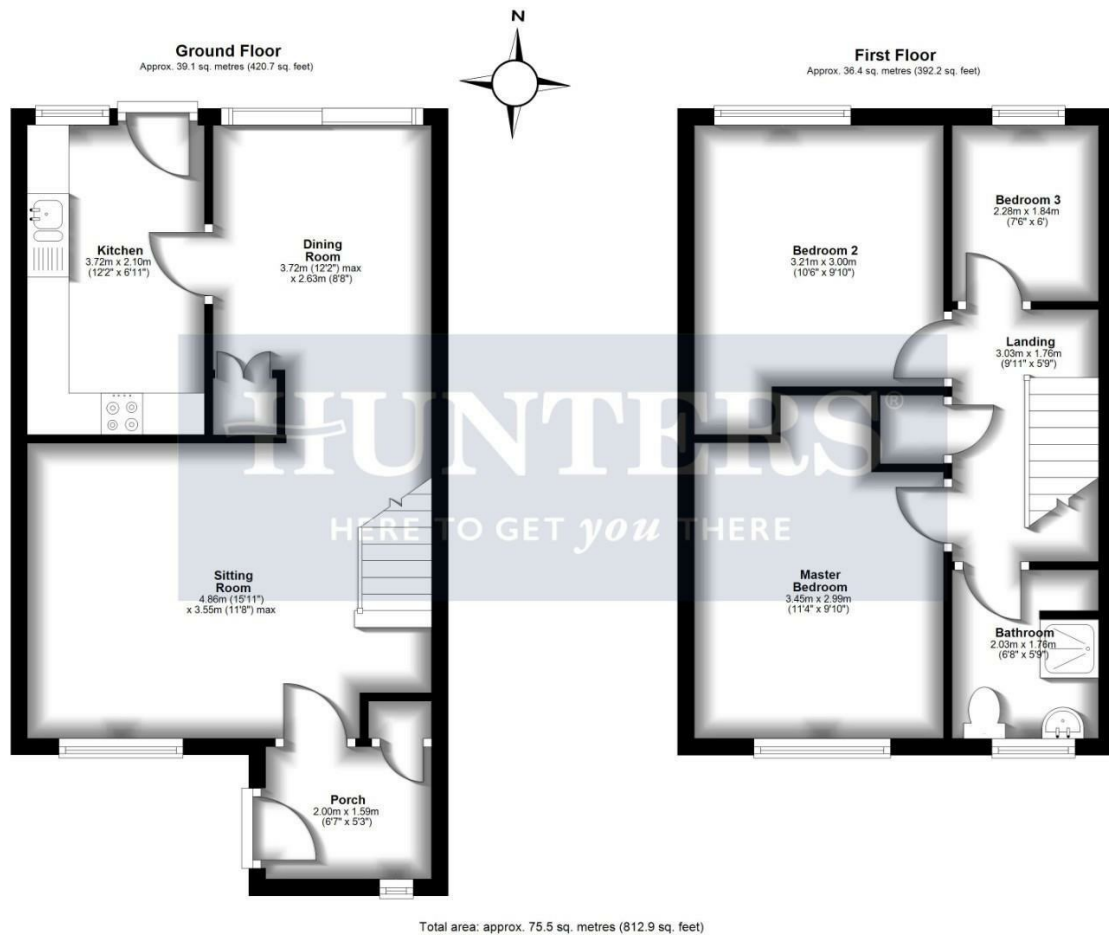

## EPC

Energy Efficiency Rating		
	Current	Potential
Very energy efficient - lower running costs		
(92 plus) <b>A</b>		87
(81-91) <b>B</b>	74	
(69-80) <b>C</b>		
(55-68) <b>D</b>		
(39-54) <b>E</b>		
(21-38) <b>F</b>		
(1-20) <b>G</b>		
Not energy efficient - higher running costs		
England & Wales		
EU Directive 2002/91/EC		

## Map



## Details

Type: House - Mid Terrace Beds: 3 Bathrooms: 1 Receptions: 2  
Tenure: Freehold

We are delighted to present for sale this three-bedroom, mid terraced home. Ideally situated in a sought-after location with excellent public transport links, proximity to schools, and local amenities, perfect for first-time buyers, investors, or families alike. This property boasts three bedrooms, a modern bathroom, two reception rooms, and a kitchen.

The first reception room is a light and airy lounge, perfect for relaxing or entertaining guests. While the second reception room, which is being used as a dining room, provides access to the rear garden through patio doors, boasting natural light and a beautiful garden view.

The kitchen is well-lit with natural light and offers easy access to an enclosed rear garden, perfect for those summer barbecues or a safe space for children to play.

The master bedroom is generously proportioned, while the second bedroom comfortably accommodates a double bed. The third bedroom is currently being used as an office but could easily be converted back into a bedroom. The modern bathroom is equipped with a heated towel rail and a shower.

This house is graced with a front garden, a walkway path, and an entrance porch for welcoming guests adding to its charm. Additional features of the property include a garage, a storage shed in the rear garden, and both on-road and garage parking options.

Don't miss out on this opportunity to own a home in a prime location. Call us today to arrange a viewing!

## Features

• Mid Terrace Home • Three Bedrooms • Lounge • Dining Room • Kitchen • Modern Bathroom • Enclosed Rear Garden • Storage Shed • Garage in a Block