

HUNTERS®

HERE TO GET *you* THERE



Calypso Crescent

SE15 6FP

£1,900 Per Calendar Month



Two double bedroom two bathroom purpose built apartment.

This spacious purpose built apartment forms part of a modern development and benefits from large open plan reception with modern fitted kitchen containing a range of integrated appliances.

There are two good sized double bedrooms with ample storage and the master bedroom contains its own en-suite bathroom.

There is a further family bathroom containing both bath and shower fitting making this property perfect for sharers.

A short walk to Burgess Park with its lake and amenities.



Area Map



Floor Plans

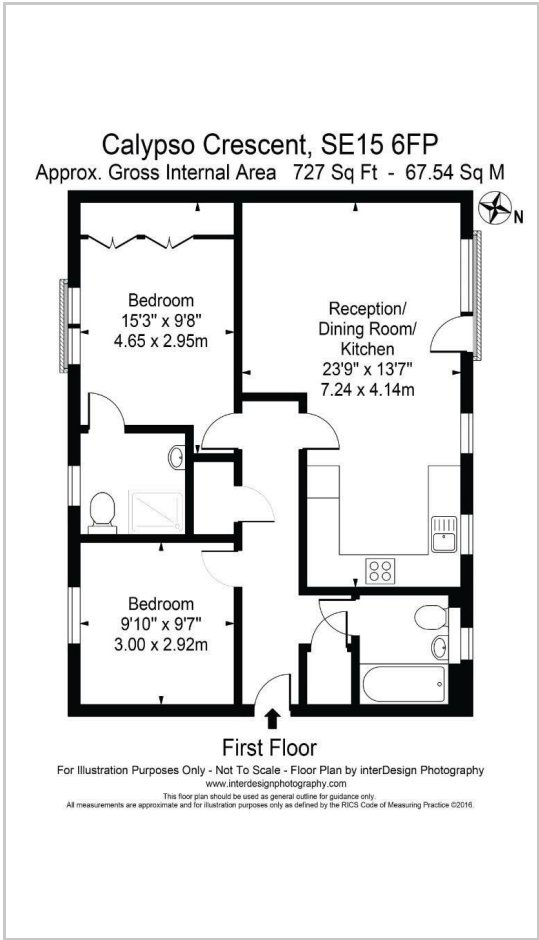

Energy Efficiency Graph

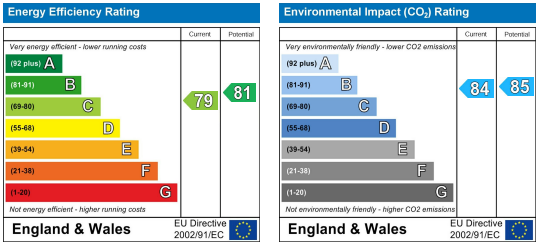

These particulars are intended to give a fair and reliable description of the property but no responsibility for any inaccuracy or error can be accepted and do not constitute an offer or contract. We have not tested any services or appliances (including central heating if fitted) referred to in these particulars and the purchasers are advised to satisfy themselves as to the working order and condition. If a property is unoccupied at any time there may be reconnection charges for any switched off/disconnected or drained services or appliances - All measurements are approximate.

THINKING OF SELLING? If you are thinking of selling your home or just curious to discover the value of your property, Hunters would be pleased to provide free, no obligation sales and marketing advice. Even if your home is outside the area covered by our local offices we can arrange a Market Appraisal through our national network of Hunters estate agents.