



**HUNTERS**<sup>®</sup>

HERE TO GET *you* THERE



## STANLEY DRIVE, DARWEN

£220,000



This delightful three bed semi is positioned on a popular cul-de-sac just off Knowsley Road. With a fresh modern design throughout benefitting from no onward chain.

The property comprises; entrance hallway with storage, open plan lounge & dining areas and a modern kitchen. To the first floor there are three good sized bedrooms and a stylish three piece bathroom. The master bedroom benefits from sliding fitted wardrobes. Off the landing there is a practical storage area with lighting. Externally the property comes with excellent garden space. There is a two tiered garden to the rear with a mixture of lawn & flagged patio. To the front there is a colourful lawn area alongside a double length driveway leading to a single garage.

The house is situated in the heart of Whitehall, within short proximity of both primary and secondary schools. There is easy access to Darwen town centre along with the neighbouring town centre of Bolton just down the A666.

**OUR THOUGHTS** - *'Properties in Whitehall are always in high demand and we think this goes quickly - enquire early to avoid disappointment'*

## KEY FEATURES

- Semi Detached Home
- Three Good Size Bedrooms
  - Whitehall Location
  - Front & Rear Gardens
- Garage & Double Length Driveway
- Modern Kitchen & Bathrooms
  - Spacious Lounge
  - No Onward Chain

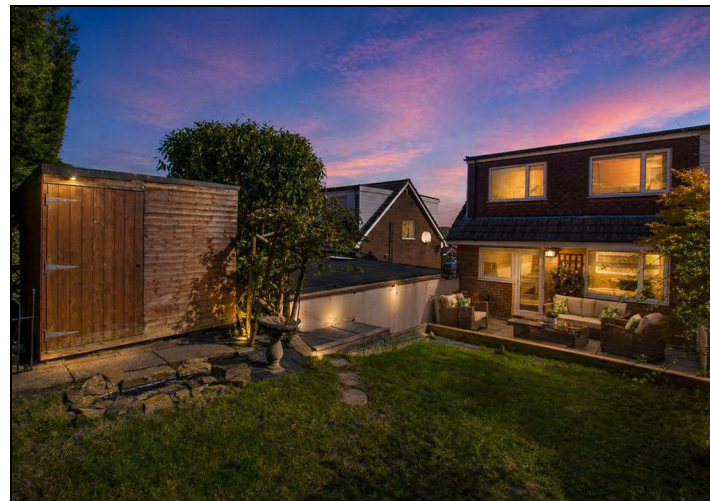





### Ground Floor

Approx. 57.2 sq. metres (615.2 sq. feet)

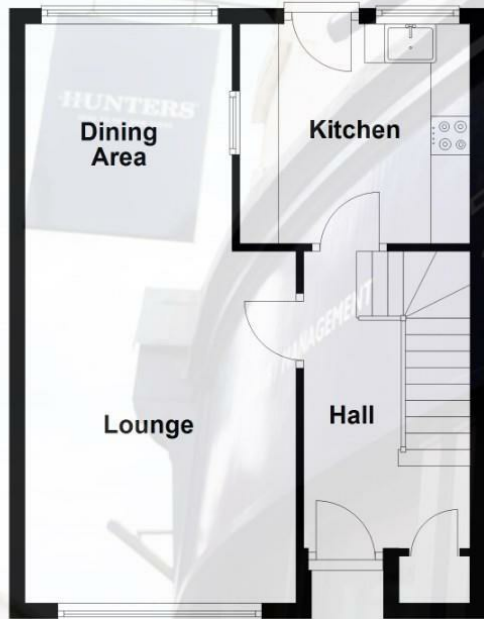

### Garage

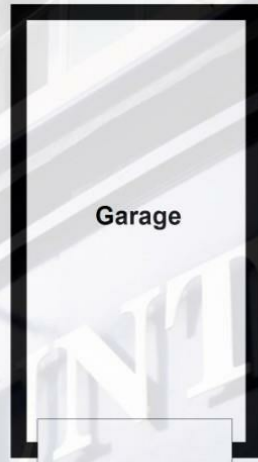

### First Floor

Approx. 39.6 sq. metres (425.8 sq. feet)



Total area: approx. 96.7 sq. metres (1041.0 sq. feet)

