

# HUNTERS<sup>®</sup>

HERE TO GET *you* THERE



## Elmtree Drive

Bristol, BS13 8NA

£1,700 Per Month



Hunters are pleased to offer this four bedroom property in Elmtree Drive, Bristol, this attractive end-terrace property offers spacious and versatile living, ideal for families or professional tenants alike.

The home boasts four bedrooms, providing ample space for both relaxation and home working. A bright and welcoming reception room forms the heart of the property—perfect for entertaining guests or enjoying quiet evenings in.

The property further benefits from a modern, well-appointed bathroom, designed with convenience and comfort in mind.

Externally, the home truly stands out. A double driveway provides off-street parking for two vehicles, an increasingly rare advantage. While the substantial rear garden offers a fantastic outdoor space. Whether it's for children to play, hosting summer gatherings, or simply unwinding, this garden caters to a variety of lifestyles.



# Area Map

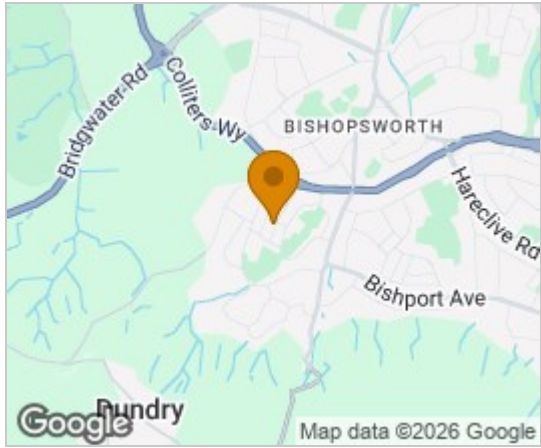

# Floor Plans

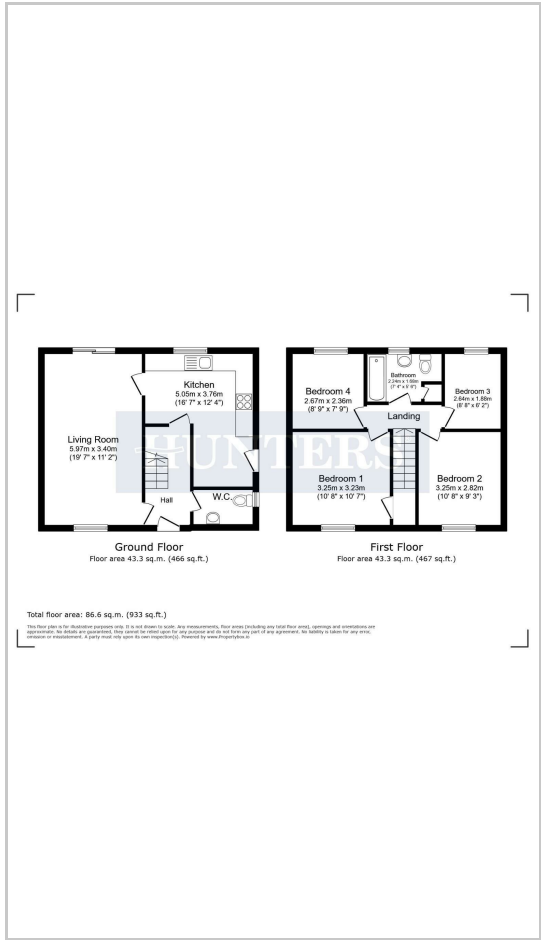

# Energy Efficiency Graph

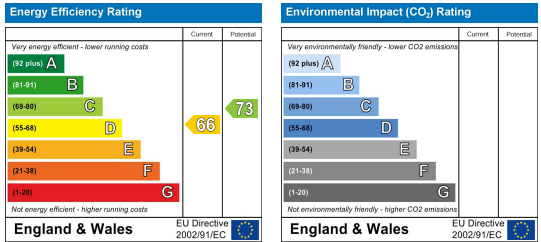

These particulars are intended to give a fair and reliable description of the property but no responsibility for any inaccuracy or error can be accepted and do not constitute an offer or contract. We have not tested any services or appliances (including central heating if fitted) referred to in these particulars and the purchasers are advised to satisfy themselves as to the working order and condition. If a property is unoccupied at any time there may be reconnection charges for any switched off/disconnected or drained services or appliances - All measurements are approximate. **THINKING OF SELLING?** If you are thinking of selling your home or just curious to discover the value of your property, Hunters would be pleased to provide free, no obligation sales and marketing advice. Even if your home is outside the area covered by our local offices we can arrange a Market Appraisal through our national network of Hunters estate agents.