



Netton Close, , Wigston, LE18 2RH

- Two Bedroom Semi-Detached Bungalow
- Lounge-dining room
- Modern Shower room
- Driveway and Garage
- Gas Central Heating and Double Glazing
- Presented in modern condition
- Fitted Kitchen
- Enclosed garden with Veranda
- 360 Virtual Tour
- Cul-de-Sac Location on the Popular Little Hill estate

£250,000



Netton Close, , Wigston, LE18 2RH

DESCRIPTION

Nestled in the tranquil cul-de-sac of Netton Close on the sought-after Little Hill estate in Wigston, this charming semi-detached bungalow is presented in a ready-to-move-in condition.

Ideal for buyers seeking a comfortable and convenient lifestyle, this delightful home boasts a generous fitted kitchen, where you can easily prepare your favourite meals. The generous lounge-dining room offers a bright and inviting space for relaxation and entertaining, ensuring that you can enjoy both comfort and style in your home, the two well-appointed bedrooms offer a space to relax and unwind, and a modern fitted shower room, making it perfect for small families or those looking to downsize.

The exterior of the property is equally appealing, featuring a low-maintenance rear garden designed with an artificial lawn, patio paving for outdoor seating, and a charming veranda, perfect for enjoying the fresh air. The driveway and garage provide ample off-road parking for up to two vehicles, adding to the convenience of this lovely home.

Located within close proximity to local shops, schools, and amenities, this bungalow also benefits from excellent public transport links to both town and city centres, making it an ideal choice for those who value accessibility. With its combination of comfort, convenience, and modern living, this property is not to be missed. We invite you to explore this wonderful home through our 360 virtual tour and envision your new life in this delightful bungalow.

To find out more about this bungalow, contact your local Hunters estate agents Wigston.





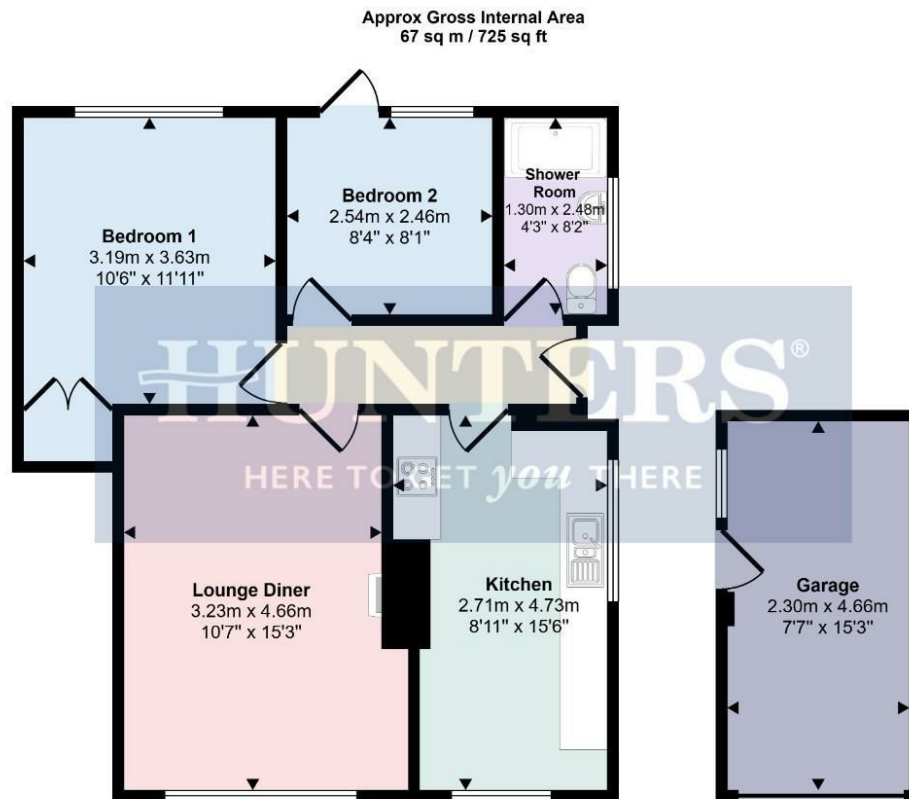

Floorplan
Approx 57 sq m / 609 sq ft

Garage
Approx 11 sq m / 115 sq ft

This floorplan is only for illustrative purposes and is not to scale. Measurements of rooms, doors, windows, and any items are approximate and no responsibility is taken for any error, omission or mis-statement. Icons of items such as bathroom suites are representations only and may not look like the real items. Made with Made Snappy 360.

Viewings

Please contact wigston@hunters.com, if you wish to arrange a viewing appointment for this property or require further information.

Valuations

For a valuation of your property, please email the team with your property details, contact information and the times you are available.

ENERGY PERFORMANCE CERTIFICATE

The energy efficiency rating is a measure of the overall efficacy of a home. The higher the rating the more energy efficient the home is and the lower the fuel bills will be.

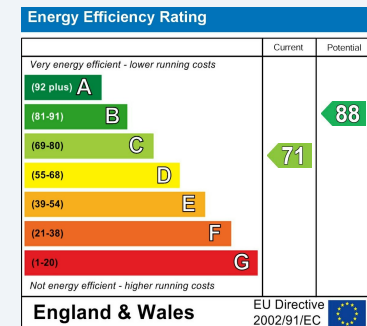

These particulars are intended to give a fair and reliable description of the property but no responsibility for any inaccuracy or error can be accepted and do not constitute an offer or contract. We have not tested any services or appliances (including central heating if fitted) referred to in these particulars and the purchasers are advised to satisfy themselves as to the working order and condition. If a property is unoccupied at any time there may be reconnection charges for any switched off/disconnected or drained services or appliances - All measurements are approximate.

THINKING OF SELLING? If you are thinking of selling your home or just curious to discover the value of your property, Hunters would be pleased to provide free, no obligation sales and marketing advice. Even if your home is outside the area covered by our local offices we can arrange a Market Appraisal through our national network of Hunters estate agents.