



Low Field Lane, Staveley, Knaresborough, HG5 9LB

- NO ONWARD CHAIN
- Two generously sized double bedrooms
- Spacious lounge with room for both seating and dining areas
- Just a short drive to the historic market town of Knaresborough
- Early viewing highly recommended
- Located in the quiet and well-connected village of Staveley
- Private rear garden
- Includes a garage, ideal for storage
- Great option for first-time buyers or downsizers
- Council Tax Band D

Guide Price £280,000



Low Field Lane, Staveley, Knaresborough, HG5 9LB

DESCRIPTION

NO ONWARD CHAIN. Located in the peaceful village of Staveley, this semi-detached bungalow offers a practical and comfortable living space that's well-suited to a range of buyers. With two good-sized double bedrooms, it's a home that gives you room to breathe, whether you're downsizing, buying for the first time.

Inside, the lounge is a generous space with plenty of natural light and enough room for both a sitting area and dining setup. It's a flexible space that works just as well for relaxing evenings as it does for having friends over.

The bathroom is straightforward and functional, and the property also includes a garage—ideal for extra storage. The property also boasts of a private rear garden.

You're just a short drive from Knaresborough, a well-loved market town with scenic walks, local shops, and cafes. It's a handy spot to have nearby and adds to the convenience of this location.

Overall, this is a solid, well-located bungalow with everything you need for comfortable day-to-day living—no fuss, just a good home in a good spot.

EPC

Energy rating D

This property produces 4.7 tonnes of CO2

Material Information - Harrogate

Tenure Type: Freehold

Council Tax Banding: D





17 Low Field Lane, Low Field Lane, Knaresborough, Staveley, HG5 9LB, GB

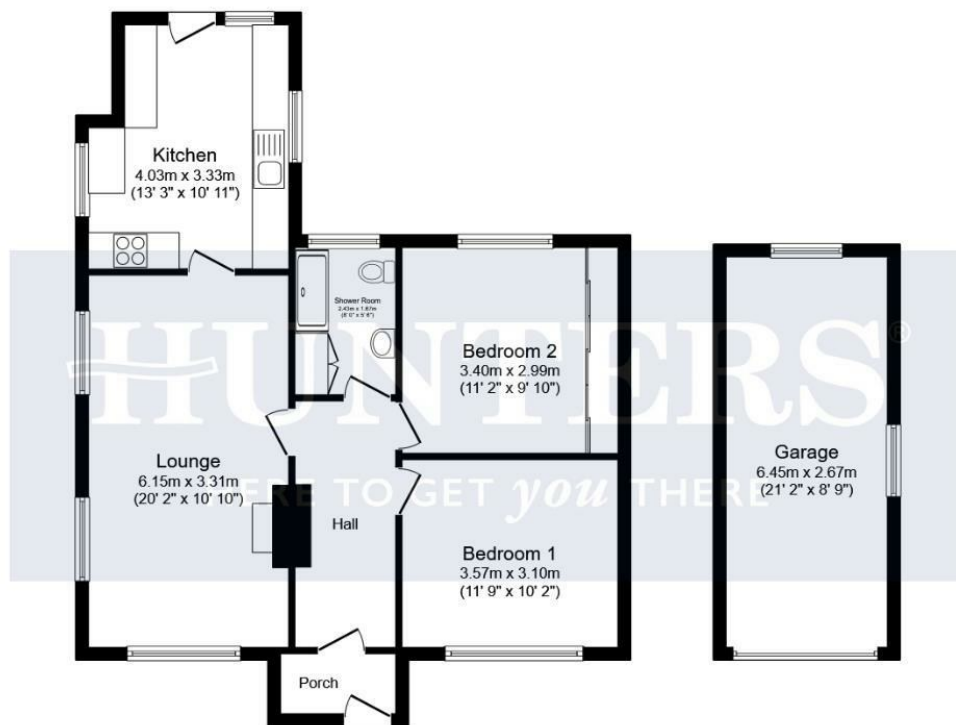

Floor Plan

Floor area 71.0 sq.m. (764 sq.ft.)

Garage

Floor area 17.2 sq.m. (185 sq.ft.)

Total floor area: 88.2 sq.m. (950 sq.ft.)

This floor plan is for illustrative purposes only. It is not drawn to scale. Any measurements, floor areas (including any total floor area), openings and orientations are approximate. No details are guaranteed, they cannot be relied upon for any purpose and do not form any part of any agreement. No liability is taken for any error, omission or misstatement. A party must rely upon its own inspection(s). Powered by www.Propertybox.io

HUNTERS
HERE TO GET *you* THERE

Viewings

Please contact harrogate@hunters.com, if you wish to arrange a viewing appointment for this property or require further information.

Valuations

For a valuation of your property, please email the team with your property details, contact information and the times you are available.

ENERGY PERFORMANCE CERTIFICATE

The energy efficiency rating is a measure of the overall efficacy of a home. The higher the rating the more energy efficient the home is and the lower the fuel bills will be.

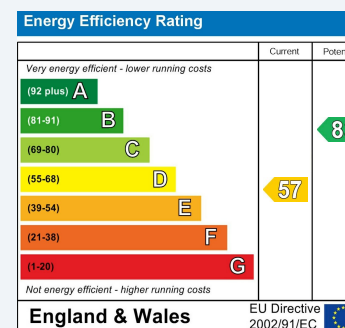

These particulars are intended to give a fair and reliable description of the property but no responsibility for any inaccuracy or error can be accepted and do not constitute an offer or contract. We have not tested any services or appliances (including central heating if fitted) referred to in these particulars and the purchasers are advised to satisfy themselves as to the working order and condition. If a property is unoccupied at any time there may be reconnection charges for any switched off/disconnected or drained services or appliances - All measurements are approximate.

THINKING OF SELLING? If you are thinking of selling your home or just curious to discover the value of your property, Hunters would be pleased to provide free, no obligation sales and marketing advice. Even if your home is outside the area covered by our local offices we can arrange a Market Appraisal through our national network of Hunters estate agents.



Regents House, 13-15 Albert Street, Harrogate, HG1 1JX
Tel: 01423 536222 Email: harrogate@hunters.com <https://www.hunters.com>

HUNTERS
HERE TO GET *you* THERE