



**HUNTERS**<sup>®</sup>  
HERE TO GET *you* THERE



# Loveridge Road, London, NW6 2DT

Guide Price £600,000



Hunters are pleased to offer this well-presented two double bedroom garden flat, occupying the ground floor of a converted period house in West Hampstead, spanning over 640 square foot of internal living space

Recently renovated throughout, the property features a bright South-facing reception room with large bay windows and high ceilings, a separate modern kitchen, two double bedrooms, an en suite and a separate W/C. The flat benefits from sole use of the rear garden.

Loveridge Road is a quiet residential turning conveniently located for the excellent amenities of West Hampstead including the Jubilee Line, London Overground and Thameslink (0.3 miles), Brondesbury Park Overground (0.2 miles) and Kilburn (0.2 miles).

223 West End Lane, West Hampstead, London, NW6 1XJ | 0207 431 4777  
westhampsteadsales@hunters.com | www.hunters.com



This Hunters business is independently owned and operated by Starside Estates Limited | Registered Address: 29 Oakwood Park Road, London, N14 6QB | Registered Number: 6741529 England and Wales | VAT No: 943 9575 77 with the written consent of Hunters Franchising Limited.



## KEY FEATURES

- Two Bedroom Garden Flat
- Over 640 sq.ft. of internal living space
  - High ceilings
  - Newly renovated
- Sole use of rear garden









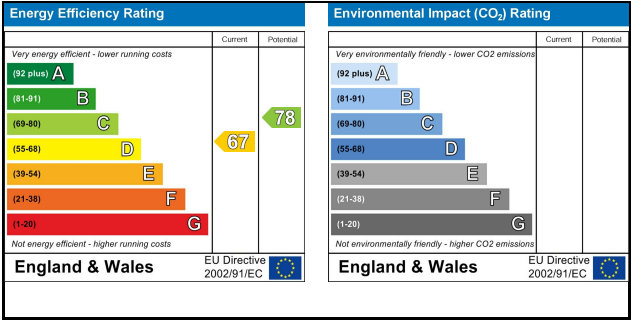
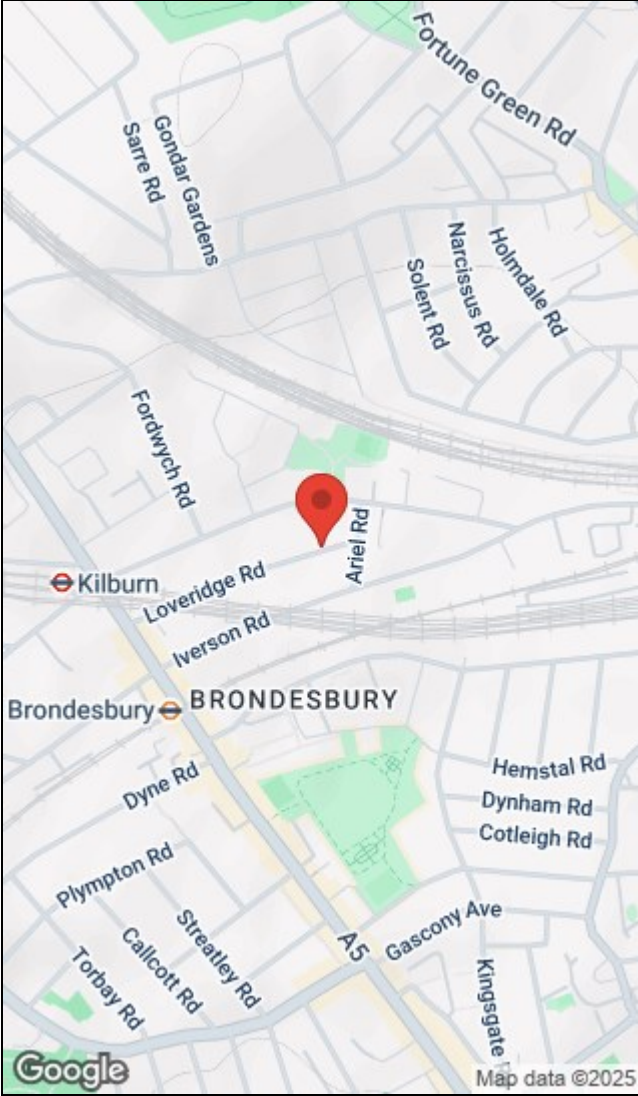
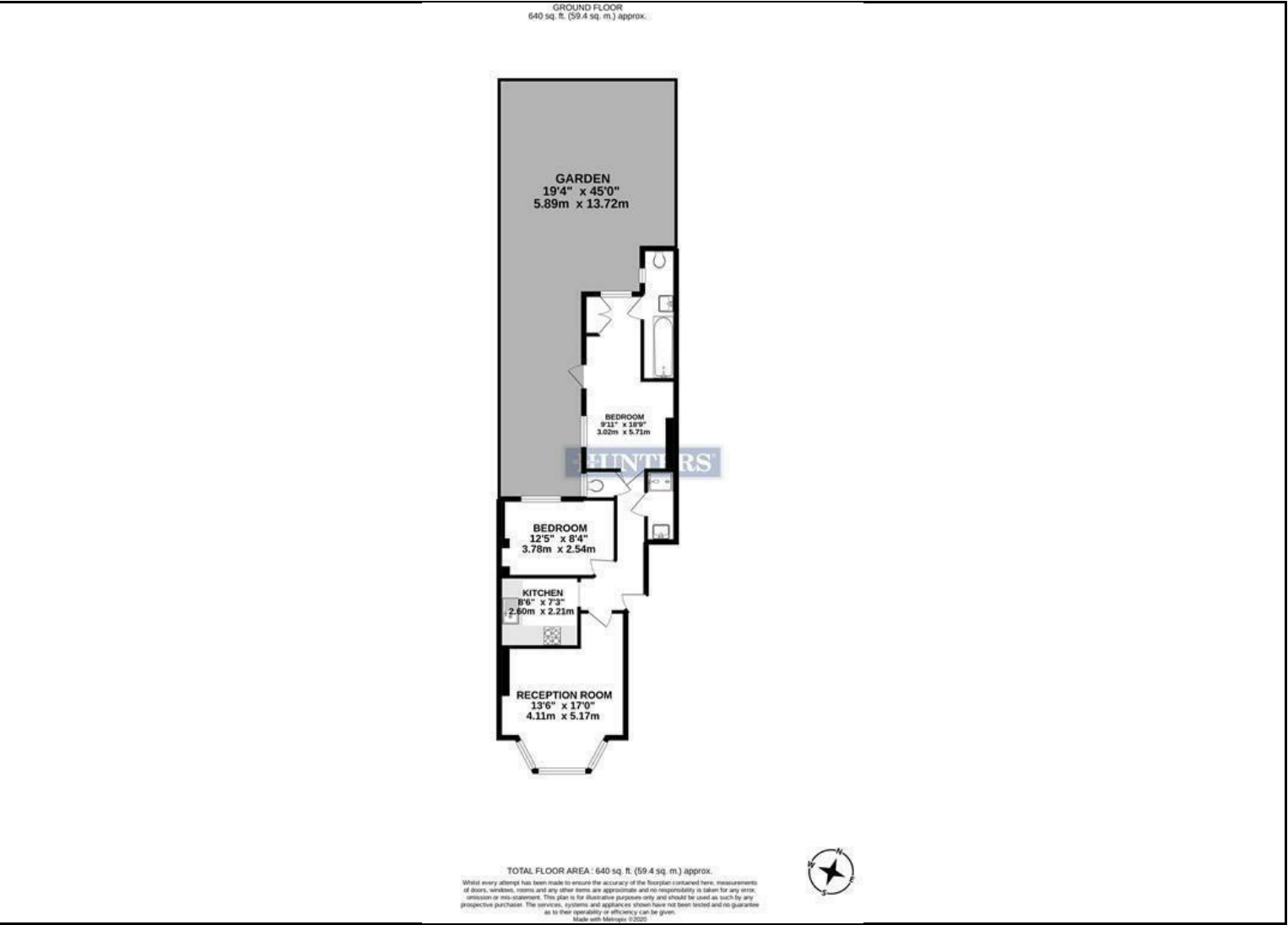

223 West End Lane, West Hampstead, London, NW6 1XJ | 0207 431 4777  
westhampsteadsales@hunters.com | www.hunters.com



This Hunters business is independently owned and operated by Starside Estates Limited | Registered Address: 29 Oakwood Park Road, London, N14 6QB | Registered Number: 6741529 England and Wales | VAT No: 943 9575 77 with the written consent of Hunters Franchising Limited.