

**HUNTERS**<sup>®</sup>  
HERE TO GET *you* THERE

 5  3  3  E

# Hermitage Lane, Golders Green, London, NW2

## Asking Price £3,200,000

# HUNTERS®

HERE TO GET *you* THERE

\*\*\* £750 LEGAL FEES CONTRIBUTION, UPON SUCCESSFUL PURCHASE THROUGH HUNTERS WILL BE GIVEN TO THE BUYER.  
\*\*\*

Set back from the road behind a generous three-car gated driveway, the property enjoys a high degree of privacy. A detached family home offers over 2,500 sq ft of internal accommodation, ideally positioned in Golders Green on the cusp of Hampstead Heath.

Arranged over three levels, the accommodation provides three reception rooms, five bedrooms and three bathrooms. The ground floor comprises a spacious dual reception room, a fully integrated modern kitchen opening into a large conservatory, and a guest cloakroom.

The upper floors accommodate five bedrooms - three doubles and two singles - along with three family bathrooms and excellent storage throughout. With a generous private rear garden extending to approximately 36 ft, offering a peaceful and secluded outdoor space.

Benefitting from excellent transport links and a wide range of amenities, with Hampstead, West Hampstead and Golders Green all nearby. Hampstead Heath and Golders Hill Park are also within easy walking distance, providing superb green open spaces for recreation and leisure.

223 West End Lane, West Hampstead, London, NW6 1XJ | 0207 431 4777  
westhampsteadsales@hunters.com | www.hunters.com



This Hunters business is independently owned and operated by Starside Estates Limited | Registered Address: 29 Oakwood Park Road, London, N14 6QB | Registered Number: 6741529 England and Wales | VAT No: 943 9575 77 with the written consent of Hunters Franchising Limited.

## KEY FEATURES

- Five Bedroom Detached Family House
- Three Bathrooms and additional guest cloakroom
  - Three-car gated driveway
  - Over 2,500 sq.ft of internal space
- Three reception rooms, including a dual 36" reception
  - Private rear garden
- Situated in Golders Green on the cusp of Hampstead Heath





GROUND FLOOR  
1128 sq.ft. (104.8 sq.m.) approx.

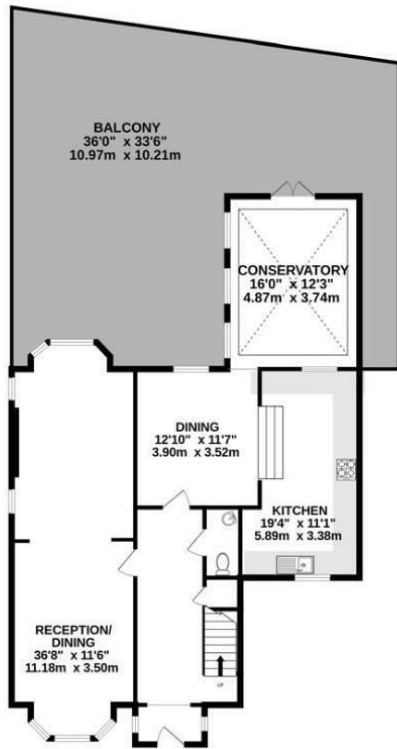

1ST FLOOR  
891 sq.ft. (82.8 sq.m.) approx.



2ND FLOOR  
483 sq.ft. (44.9 sq.m.) approx.

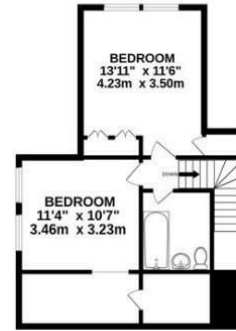

TOTAL FLOOR AREA : 2503 sq.ft. (232.5 sq.m.) approx.

Whilst every attempt has been made to ensure the accuracy of the floorplan contained here, measurements of doors, windows, rooms and any other items are approximate and no responsibility is taken for any error, omission or mis-statement. This plan is for illustrative purposes only and should be used as such by any prospective purchaser. The services, systems and appliances shown have not been tested and no guarantee as to their operability or efficiency can be given.  
Made with Metropix ©2025

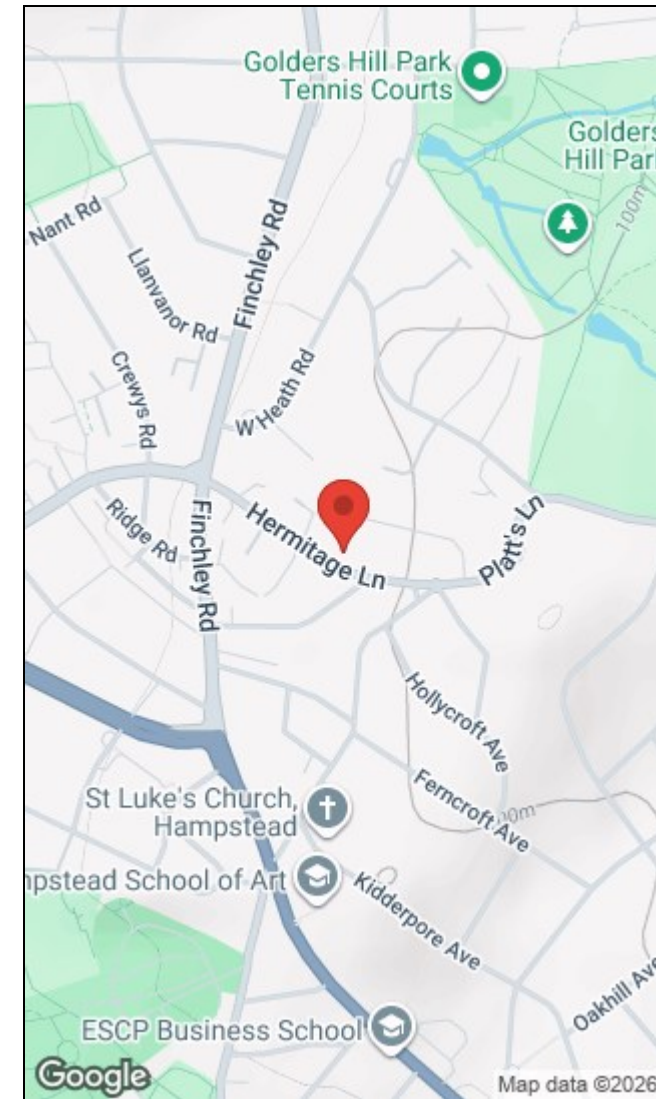

| Energy Efficiency Rating                    |                         | Environmental Impact (CO <sub>2</sub> ) Rating                  |                         |
|---|-------------------------|---|-------------------------|
| Current                                     | Potential               | Current   | Potential               |
| Very energy efficient - lower running costs |                         | Very environmentally friendly - lower CO <sub>2</sub> emissions |                         |
| (92 plus) <b>A</b>                          |                         | (92 plus) <b>A</b>  |                         |
| (81-91) <b>B</b>                            |                         | (81-91) <b>B</b>  |                         |
| (69-80) <b>C</b>                            |                         | (69-80) <b>C</b>  |                         |
| (55-68) <b>D</b>                            |                         | (55-68) <b>D</b>  |                         |
| (39-54) <b>E</b>                            |                         | (39-54) <b>E</b>  |                         |
| (21-38) <b>F</b>                            |                         | (21-38) <b>F</b>  |                         |
| (1-20) <b>G</b>                             |                         | (1-20) <b>G</b>   |                         |
| Not energy efficient - higher running costs |                         | Not environmentally friendly - higher CO <sub>2</sub> emissions |                         |
| <b>73</b>                                   | <b>41</b>               |   |                         |
| EU Directive 2002/91/EC                     | EU Directive 2002/91/EC | EU Directive 2002/91/EC   | EU Directive 2002/91/EC |

223 West End Lane, West Hampstead, London, NW6 1XJ | 0207 431 4777  
westhampsteadsales@hunters.com | www.hunters.com



This Hunters business is independently owned and operated by Starside Estates Limited | Registered Address: 29 Oakwood Park Road, London, N14 6QB | Registered Number: 6741529 England and Wales | VAT No: 943 9575 77 with the written consent of Hunters Franchising Limited.