

HUNTERS®

HERE TO GET *you* THERE

1 Henry Terrace, Yeadon, Leeds, LS19 7JG

Asking Price £300,000

Property Images



HUNTERS®

HERE TO GET *you* THERE

Property Images

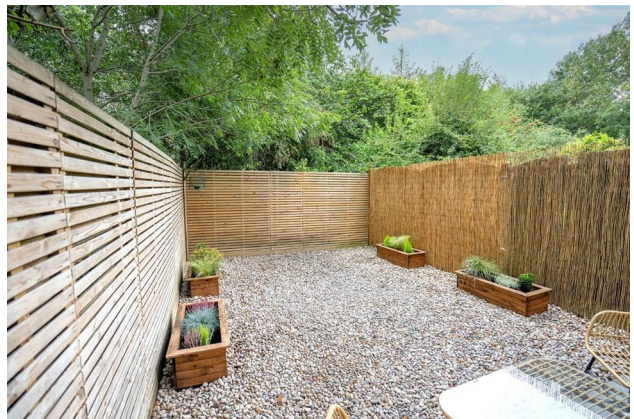
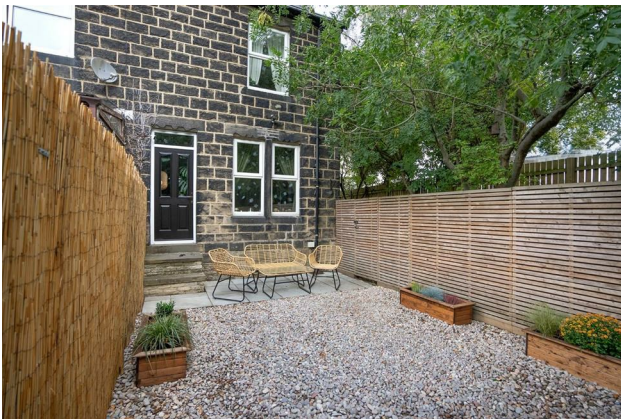

HUNTERS[®]

HERE TO GET *you* THERE

Property Images

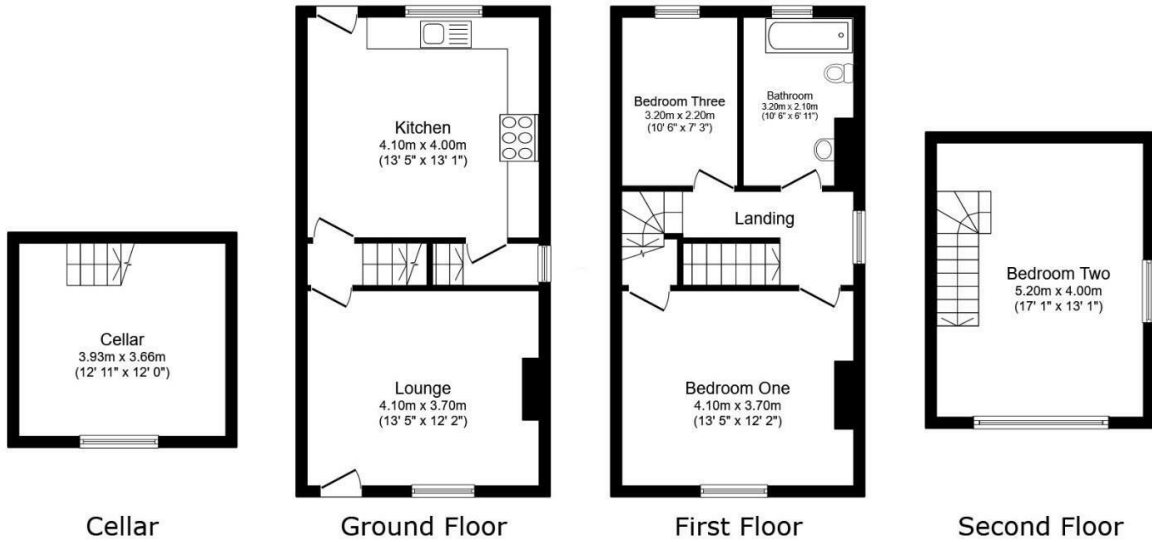

Total floor area: 113.0 sq.m. (1,216 sq.ft.)

This floor plan is for illustrative purposes only. It is not drawn to scale. Any measurements, floor areas (including any total floor area), openings and orientations are approximate. No details are guaranteed, they cannot be relied upon for any purpose and do not form any part of any agreement. No liability is taken for any error, omission or misstatement. A party must rely upon its own inspection(s). Powered by www.Propertybox.io



EPC

Energy Efficiency Rating		Current	Potential
Very energy efficient - lower running costs			
(92 plus) A			
(81-91) B			
(69-80) C			79
(55-68) D			
(39-54) E		47	
(21-38) F			
(1-20) G			
Not energy efficient - higher running costs			
England & Wales	EU Directive 2002/91/EC		

Map



Details

Type: House - End Terrace Beds: 3 Bathrooms: 1 Receptions: 1 Tenure: Freehold

Summary

Nestled in the charming area of Henry Terrace, Yeadon, Leeds, this delightful end terrace house presents a wonderful opportunity for those seeking a blend of character and modern living.

Upon entering, you are greeted by a welcoming reception room, perfect for entertaining guests or enjoying quiet evenings at home. The house features three well-proportioned bedrooms, providing ample space for rest and relaxation. The conveniently located bathroom caters to the needs of the household, ensuring comfort and practicality.

One of the most appealing aspects of this property is the stunning woodland views to the rear, which create a picturesque backdrop for your daily life. Residents will appreciate the quick access to local woodland walks, ideal for leisurely strolls or invigorating hikes in nature. Furthermore, the property includes private allotments to the rear, exclusively for street residents to rent upon availability, offering a unique opportunity for gardening enthusiasts to cultivate their own green space.

Parking is made easy with space available for up to three vehicles, ensuring that you and your guests will always have a convenient spot. This end terrace house in Henry Terrace is not just a home; it is a lifestyle choice, combining the charm of a historic property with the conveniences of modern living. Whether you are looking to settle down or invest, this property is certainly worth considering.

Features

- Spacious 3-bedroom end terrace
- High-quality kitchen/diner
- Cosy lounge with log burner
- Modern bathroom with tub
- Useful storage cellar
- Enclosed landscaped rear garden
- Parking spaces at front
- Quiet location near amenities
- Close to A65 and train station
- Viewing highly recommended