

HUNTERS®

HERE TO GET *you* THERE

112 High Street, Yeadon, Leeds, LS19 7AB

Offers In Excess Of £325,000

Property Images



HUNTERS®

HERE TO GET *you* THERE

Property Images



HUNTERS[®]

HERE TO GET *you* THERE

Property Images



HUNTERS®

HERE TO GET *you* THERE

Approximate Floor Area = 135.8 sq m / 1462 sq ft

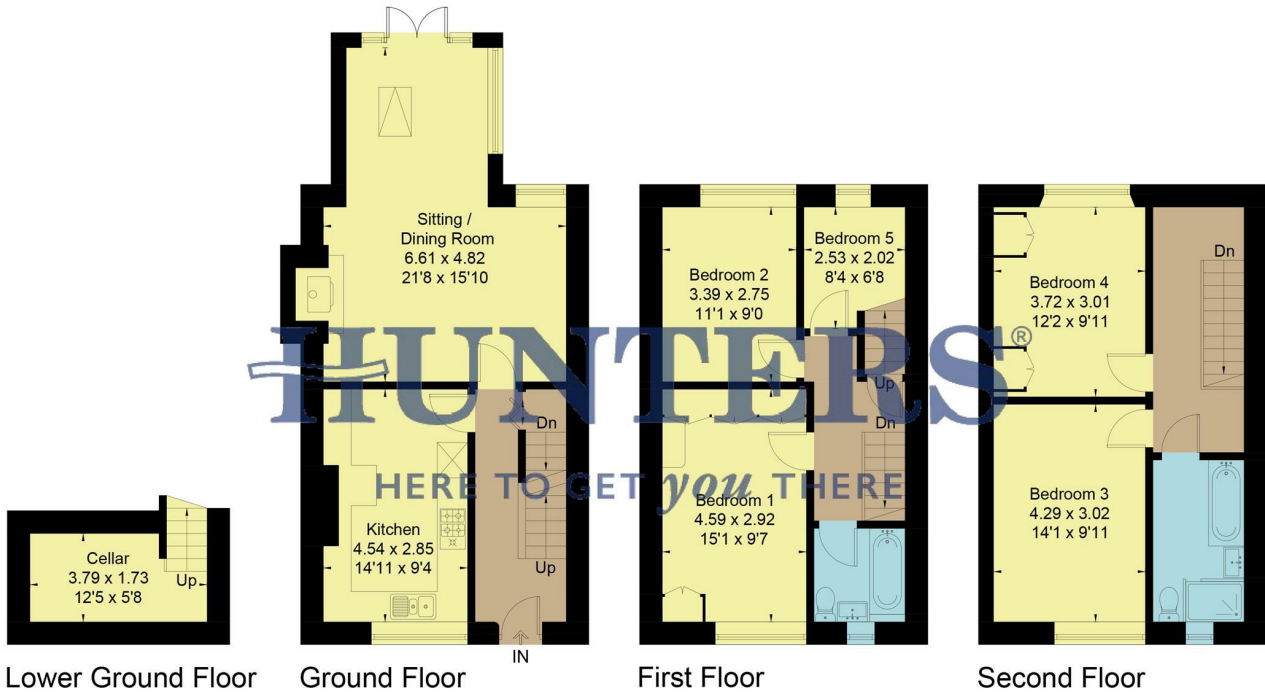

This floor plan has been drawn in accordance with RICS Property Measurement 2nd edition. All measurements, including the floor area, are approximate and for illustrative purposes only. @fourwalls-group.com #108464

EPC

Energy Efficiency Rating		Current	Potential
Very energy efficient - lower running costs			
(92 plus) A			
(81-91) B			
(69-80) C			
(55-68) D		68	
(39-54) E			
(21-38) F			
(1-20) G			
Not energy efficient - higher running costs			
England & Wales	EU Directive 2002/91/EC		

Map

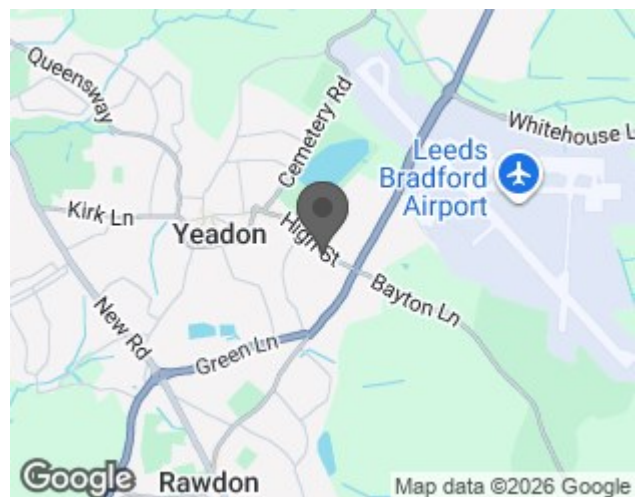

Details

Type: House - Terraced Beds: 5 Bathrooms: 2 Receptions: 2 Tenure: Freehold

Summary

Nestled in the heart of Yeadon, Leeds, this charming mid-terrace stone house offers a delightful blend of space and character. With five well-proportioned bedrooms, including four generous doubles, this property is perfect for families or those seeking ample room for guests or a home office.

The house boasts a traditional stone façade, which adds to its appeal and reflects the rich heritage of the area. Inside, you will find a welcoming atmosphere, with plenty of natural light flowing through the spacious rooms. The layout is designed for both comfort and functionality, making it an ideal setting for modern living.

Yeadon is a vibrant community with a range of local amenities, including shops, schools, and parks, all within easy reach. The property is conveniently located on the High Street, providing excellent access to public transport links, making commuting to Leeds city centre and beyond a breeze.

This mid-terrace stone house is not just a place to live; it is a home where memories can be made. With its generous living space and prime location, it presents a wonderful opportunity for those looking to settle in a friendly and thriving neighbourhood. Don't miss the chance to make this lovely property your own.

Features

- Five spacious bedrooms
- Two modern bathrooms
- Four versatile floors
- Stone mid-terrace house
- Southwest-facing garden
- Views of cricket ground
- Close to Yeadon Tarn
- Easy access to Leeds
- Storage cellar included
- Viewing highly recommended