

HUNTERS®

HERE TO GET *you* THERE



HUNTERS®
HERE TO GET *you* THERE

Moorfield Drive

Yeadon, Leeds, LS19 6AJ

Asking Price £170,000



Council Tax: B



HUNTERS
HERE TO GET *you* THERE

HUNTERS
HERE TO GET *you* THERE

Moorfield Court Moorfield Drive

Yeadon, Leeds, LS19 6AJ

Asking Price £170,000





Road Map



Hybrid Map



Terrain Map

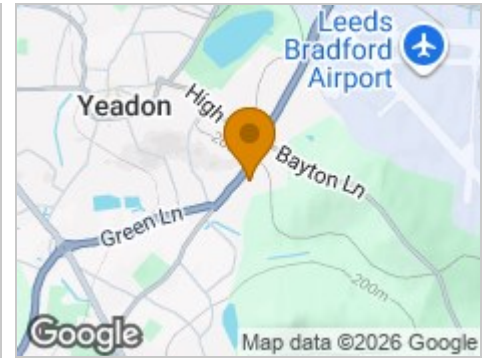

Floor Plan

Approximate Floor Area = 57.8 sq m / 622 sq ft
 Garage = 12.6 sq m / 136 sq ft
 Total = 70.4 sq m / 758 sq ft

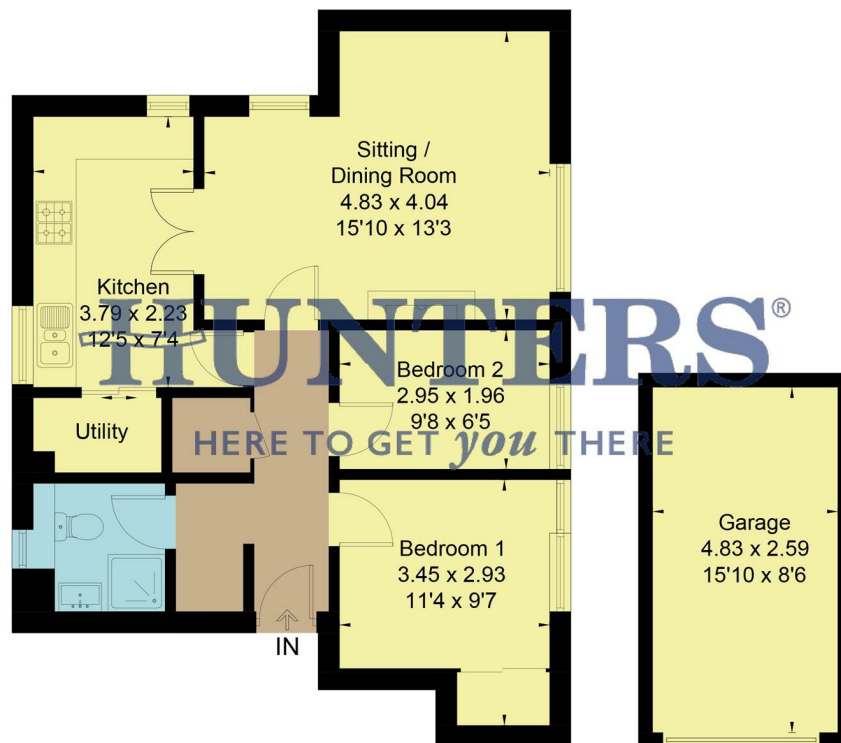

First Floor

(Not Shown In Actual Location / Orientation)



This floor plan has been drawn in accordance with RICS Property Measurement 2nd edition.
 All measurements, including the floor area, are approximate and for illustrative purposes only. @fourwalls-group.com #108903

Viewing

Please contact our Hunters Yeadon Office on 01132029923 if you wish to arrange a viewing appointment for this property or require further information.

Energy Efficiency Graph

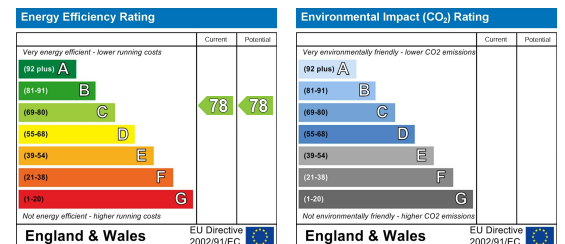

These particulars are intended to give a fair and reliable description of the property but no responsibility for any inaccuracy or error can be accepted and do not constitute an offer or contract. We have not tested any services or appliances (including central heating if fitted) referred to in these particulars and the purchasers are advised to satisfy themselves as to the working order and condition. If a property is unoccupied at any time there may be reconnection charges for any switched off/disconnected or drained services or appliances - All measurements are approximate. **THINKING OF SELLING?** If you are thinking of selling your home or just curious to discover the value of your property, Hunters would be pleased to provide free, no obligation sales and marketing advice. Even if your home is outside the area covered by our local offices we can arrange a Market Appraisal through our national network of Hunters estate agents.