



## Brockman Crescent, Dymchurch, Romney Marsh, Kent, TN29 0TT

- Three Bedroom Detached Family Home
- Modern Kitchen/Dining Room
- Driveway & Detached Garage & Workshop
- Enclosed Rear Garden
- Close To Local Amenities
- Two Reception Rooms
- Shower Room & Family Bathroom
- Scope To Create A Detached Annexe
- Within A Short Walk To The Beach
- Viewing Recommended

**Offers In Excess Of £450,000**



# Brockman Crescent, Dymchurch, Romney Marsh, Kent, TN29 0TT

## DESCRIPTION

Situated in the sought-after Brockman Crescent, Dymchurch, this charming detached home perfectly combines comfort and style. Boasting three generously sized bedrooms, it is ideal for families or anyone in need of extra space. The two spacious reception rooms offer versatility for both relaxing evenings and entertaining guests.

The property features a modern kitchen/dining room with a range of wall and base units, flowing seamlessly into a sitting room complete with a cozy log-burning stove. With a well-appointed bathroom and separate shower room, the home provides practicality and convenience for residents and visitors alike. Thoughtfully designed, the layout maximises space and natural light, creating a welcoming and inviting atmosphere throughout.

A versatile detached garage/workshop offering excellent potential to create a self-contained annexe, ideal for an Air B&B opportunity or accommodation for a family member. With ample space and a flexible layout, this property provides a blank canvas to design a bespoke living area while retaining the option for workshop or storage use. Perfectly suited for those looking to add value or expand their home, this annex space combines practicality with exciting development potential.

Dymchurch is celebrated for its scenic surroundings and strong sense of community, making it a truly desirable place to live. Local amenities and the stunning coastal landscape are just moments away, offering the perfect balance of everyday convenience and seaside charm.

Whether you're looking to establish a family home or invest in a property with excellent potential, this Brockman Crescent house presents a rare and exciting opportunity not to be missed.





## GROUND FLOOR

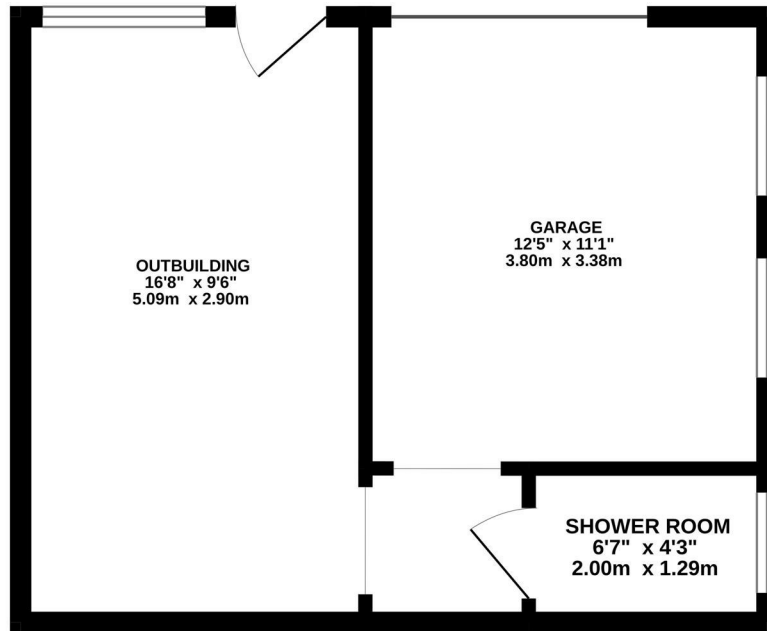

Whilst every attempt has been made to ensure the accuracy of the floorplan contained here, measurements of doors, windows, rooms and any other items are approximate and no responsibility is taken for any error, omission or mis-statement. This plan is for illustrative purposes only and should be used as such by any prospective purchaser. The services, systems and appliances shown have not been tested and no guarantee as to their operability or efficiency can be given.  
Made with Metropix ©2026

### Viewings

Please contact [hythe@hunters.com](mailto:hythe@hunters.com), if you wish to arrange a viewing appointment for this property or require further information.

### Valuations

For a valuation of your property, please email the team with your property details, contact information and the times you are available.

## ENERGY PERFORMANCE CERTIFICATE

The energy efficiency rating is a measure of the overall efficacy of a home. The higher the rating the more energy efficient the home is and the lower the fuel bills will be.

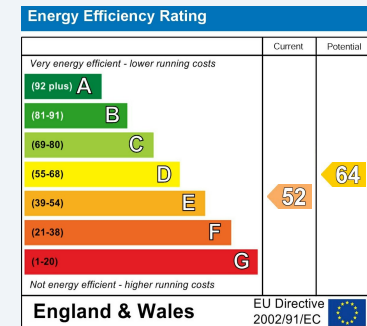

These particulars are intended to give a fair and reliable description of the property but no responsibility for any inaccuracy or error can be accepted and do not constitute an offer or contract. We have not tested any services or appliances (including central heating if fitted) referred to in these particulars and the purchasers are advised to satisfy themselves as to the working order and condition. If a property is unoccupied at any time there may be reconnection charges for any switched off/disconnected or drained services or appliances - All measurements are approximate.

**THINKING OF SELLING?** If you are thinking of selling your home or just curious to discover the value of your property, Hunters would be pleased to provide free, no obligation sales and marketing advice. Even if your home is outside the area covered by our local offices we can arrange a Market Appraisal through our national network of Hunters estate agents.



156a High Street, Hythe, CT21 5JU  
Tel: 01303 261557 Email: [hythe@hunters.com](mailto:hythe@hunters.com) <https://www.hunters.com>

