



HUNTERS[®]
HERE TO GET *you* THERE

At Last Cottage Moor End, Kelfield, York, YO19 6RJ

HUNTERS
HERE TO GET *you* THERE

At Last Cottage Moor End, Kelfield, York, YO19 6RJ

Offers In The Region Of £275,000

DESCRIPTION

At Last Cottage is an attractive two bedroom detached home which stands proudly in this popular village location of Kelfield. The property benefits from an oil central heating system, UPVC double glazing and briefly comprises of an open plan kitchen/dining room, downstairs cloakroom/w.c, and reception room with patio doors leading into the garden on the ground floor. To the first floor there are two bedrooms, bathroom and separate toilet with basin. To the front of the property there is a driveway leading to a garage. To the rear of the property there is a low maintenance patio area with fencing around the perimeter. Viewing comes highly recommended to appreciate the accommodation on offer. Call Hunters Selby seven days a week to book a viewing.

LOCATION

Kelfield is a small village located between Cawood and Riccall. Amenities include public house, post office and general store. Easy access to major road networks including A19, A1, M1 and M62.

DIRECTIONS

From Selby, take the A19 (towards York), take the left hand turn signposted Riccall, turn left onto Main Street, then left again onto Silver Street where the road Silver Street turns slightly right and becomes Kelfield Road, On entering the village continue on Moor End where the property can be identified by our Hunters For Sale Board.

Material Information - Selby

Tenure Type; Freehold

Council Tax Banding; D

EPC Rating : C

Hunters Selby 23 Finkle Street, Selby, YO8 4DT | 01757 210884

selby@hunters.com | www.hunters.com

At Last Cottage, Moor End, Kelfield, York, YO19



Denotes restricted head height

Approximate Area = 747 sq ft / 69.3 sq m
 Limited Use Area(s) = 17 sq ft / 1.5 sq m
 Garage = 130 sq ft / 12 sq m
 Total = 894 sq ft / 82.8 sq m

For identification only - Not to scale

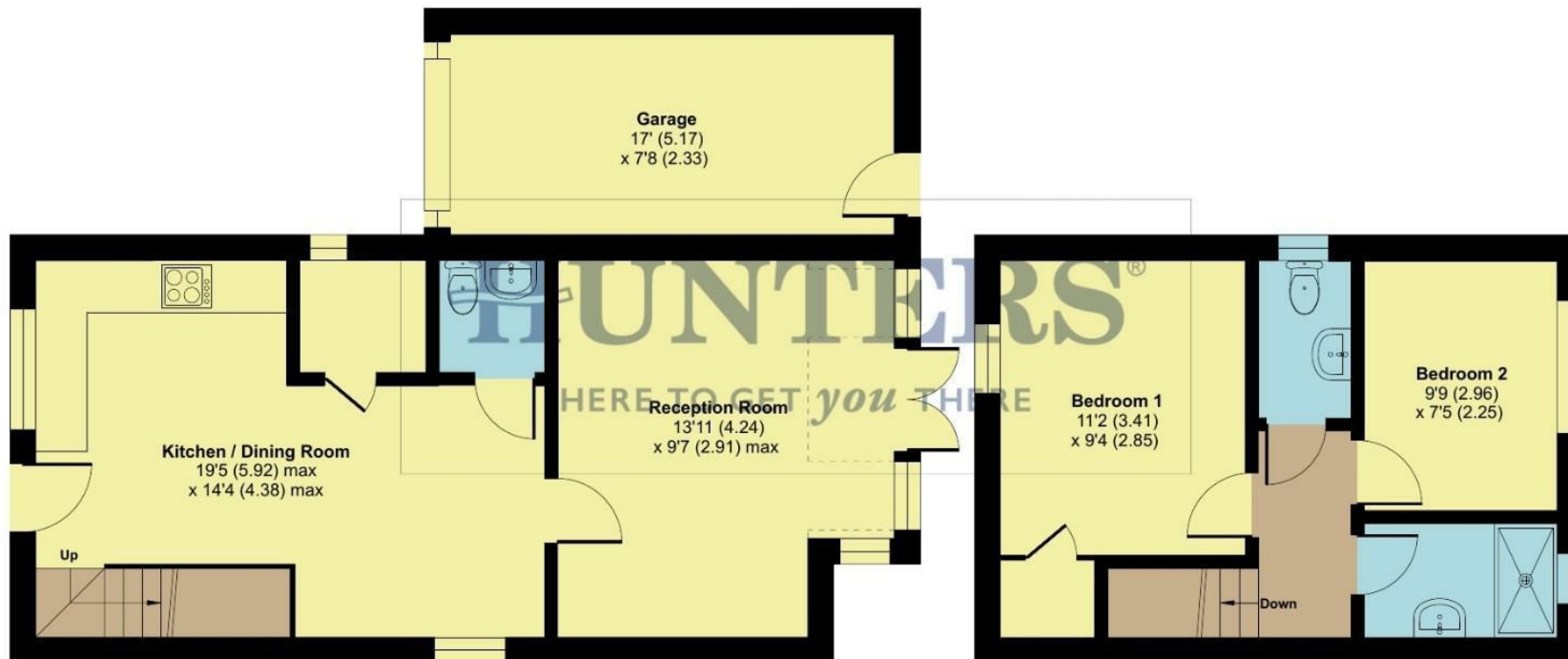

GROUND FLOOR
 APPROX FLOOR AREA 40.9 SQ M
 (441 SQ FT)

FIRST FLOOR
 APPROX FLOOR AREA 28.4 SQ M
 (306 SQ FT)



Floor plan produced in accordance with RICS Property Measurement 2nd Edition, Incorporating International Property Measurement Standards (IPMS2 Residential), © nctecom 2026. Produced for Hunters Property Group. REF: 1400576



Energy Efficiency Rating		Current	Potential
Very energy efficient - lower running costs			
(92 plus) A			
(81-91) B			
(69-80) C			
(55-68) D			
(39-54) E			
(21-38) F			
(1-20) G			
Not energy efficient - higher running costs			
		71	85
EU Directive 2002/91/EC			
England & Wales			

Environmental Impact (CO ₂) Rating		Current	Potential
Very environmentally friendly - lower CO ₂ emissions			
(92 plus) A			
(81-91) B			
(69-80) C			
(55-68) D			
(39-54) E			
(21-38) F			
(1-20) G			
Not environmentally friendly - higher CO ₂ emissions			
EU Directive 2002/91/EC			
England & Wales			











HUNTERS
HERE TO GET *you* THERE