



HUNTERS[®]
HERE TO GET *you* THERE

Craig House, Hartington Road, London, W13 8QJ | £400,000
Call us today on 020 8567 4444



Approx. 56.0 sq. metres (603.3 sq. feet)

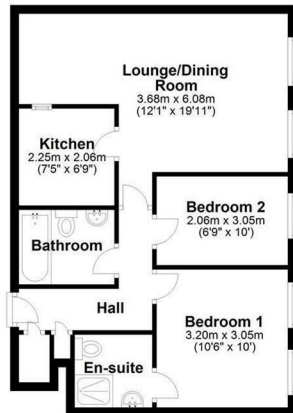

Score	Energy rating	Current	Potential
92+	A		
81-91	B		
69-80	C		74 C
55-68	D		
39-54	E	53 E	
21-38	F		
1-20	G		

Thinking of Selling?

If you are thinking of selling your home or just curious to discover the value of your property, Hunters would be pleased to provide free, no obligation sales and marketing advice. Even if your home is outside the area covered by our local offices we can arrange a Market Appraisal through our national network of Hunters estate agents.

A two bedroom/two bathroom apartment situated in this well maintained purpose built building with a lift service, and well located, just moments from the station and shops.

Accommodation comprises a welcoming hallway with storage cupboards and doors leading to all rooms including a spacious lounge/dining room, separate kitchen, two bedrooms, en suite to the master bedroom and a separate family bathroom. The building benefits from a lift servicing all floors and access to a sunny roof top terrace.

Well located, this property is just moments from the many shops and restaurants on Uxbridge Road, and is less than a quarter of a mile from West Ealing station with regular trains to London and future Cross Rail to come. Ealing Broadway, with its many transport links, shops and restaurants is within walking distance too. Call Hunters today to arrange your appointment to view.