

HUNTERS[®]

HERE TO GET *you* THERE



Cranston Road

London, SE23 2HB

£1,600 Per Month



Offers over £1,600 pcm. Partly furnished or unfurnished, TWO DOUBLE BEDROOMS, ideal for professional couples or sharers, FIRST FLOOR OF PERIOD BUILDING, ideal location for Forest Hill and Honor Oak towns / stations.



EPC rated: D

Council tax: C (£1,614 p/yr)

Long let available.

PLEASE VIEW OUR FULL HD VIDEO WALK THROUGH – LIKE AND SUBSCRIBE TO OUR CHANNEL FOR FOREST HILL PROPERTY MARKET UPDATES

VIEW OUR INTERACTIVE VIRTUAL REALITY TOUR – SHARE A LINK WITH YOUR FRIENDS AND FAMILY TO ENJOY THE VIRTUAL TOUR WITH THEM ON SCREEN TOO

Some striking features of this flat that may not be apparent from the images include:

- There are two stunning fireplaces both of which have cast iron features
- The lounge is over 17 ft and spans the width of the building making this ideal for a seating area and dedicated dining area
- Overall floor space of approximately 700 sq ft which is the size of a small house
- A few steps in the hallway and high ceilings make the property feel spacious and split level which adds to the charm of the layout

The property is located approximately 0.6 miles from the main hub of Forest Hill which offers many cafés, restaurants and recreational facilities. Forest Hill station provides transport via the East London Line with links to many London Stations including London Bridge in Approximately 15 minutes.

The property is also less than a mile from the open space of Blythe Hill fields and its panoramic views over Canary Wharf, the City, Kent and Surrey.

For those tenants who don't know the area so well here is a summary of transport and recreation found locally.

Three train stations are located approximately 0.5 to 0.8 miles from the property and offer some of the following travel times to central London stations:

Charring Cross in approximately 22 minutes

St Pancras in approximately 32 minutes

Canary Wharf in approximately 32 minutes

Blackfriars in approximately 22 minutes

Bus routes are available along the road and for late night travellers, night bus N171 runs from Tottenham Court Road through Waterloo, Elephant & Castle and stops at the junction of Brockley Rise which is almost opposite the property.

Local high streets include Honor Oak, Forest Hill and Catford, where you will find Sainsbury's, Tesco, your choice of boutique cafés, restaurants and trendy gastro pubs, as well as leisure centres, libraries and even the odd cocktail bar...

Catford town centre is approximately 0.8 miles away but if you ever fancied a greater selection of shops, eateries and social activity there are travel connections to the adjoining towns of Lewisham and Bromley both of which have shopping centres and high streets with many well-known brand name shops and restaurants.

Locally, there are numerous points of interest and some of the most popular include:

The Horniman Museum and Gardens with regular events such as a farmer's market, live music and seasonal festivals to name a few.

You can read more about the Horniman museum and gardens here:

<http://www.horniman.ac.uk/>

Blythe Hill Fields is also located in the local area and offers recreational facilities such as the "Trim trails" which is an exercise trail. It also hosts local events where the residents of SE23 and SE6 get to know each other better and enjoy the community spirit. You may look up details about Blythe Hill Fields on their website:

<http://www.blythehillfields.org.uk/index.htm>

Some of the eateries nearby we know well are the award-winning Babur Indian restaurant. There's also the popular Mama Dough (Sour Dough) pizza restaurant and Le Querce - run by a Sardinian family serving traditional dishes.

The Honor Oak pub (approximately 0.1 miles way) was refurbished a year or so ago and is now a popular gastropub with a beer garden out the back.

Additional conveniences include the NHS doctors' surgery on the corner of St German's Road (located off the south circular), with a handy chemist located next door and a post office further along the road.

Furniture for illustration purposes only and may not be available or the same furniture for tenants to move in. Tenants are advised to discuss the furnishing with the agent before proceeding.

Please contact Hunters to arrange your viewing.

Area Map

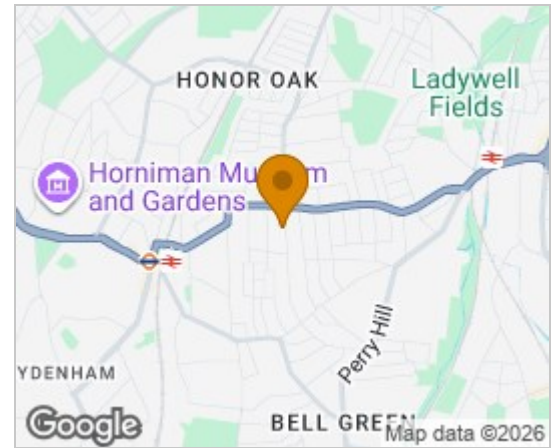

Floor Plans

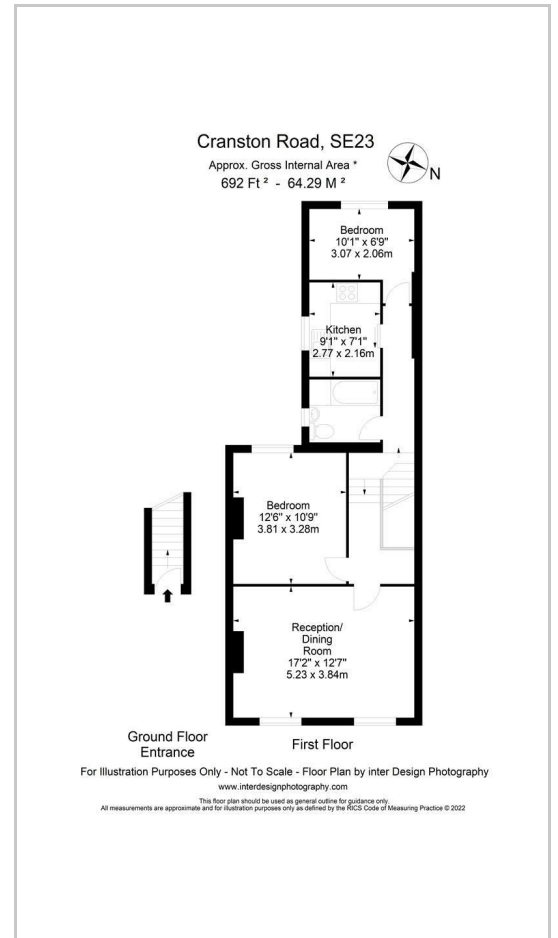

Energy Efficiency Graph

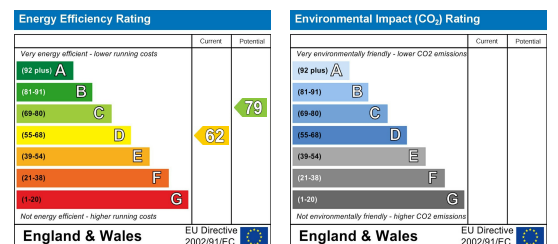

These particulars are intended to give a fair and reliable description of the property but no responsibility for any inaccuracy or error can be accepted and do not constitute an offer or contract. We have not tested any services or appliances (including central heating if fitted) referred to in these particulars and the purchasers are advised to satisfy themselves as to the working order and condition. If a property is unoccupied at any time there may be reconnection charges for any switched off/disconnected or drained services or appliances - All measurements are approximate. **THINKING OF SELLING?** If you are thinking of selling your home or just curious to discover the value of your property, Hunters would be pleased to provide free, no obligation sales and marketing advice. Even if your home is outside the area covered by our local offices we can arrange a Market Appraisal through our national network of Hunters estate agents.

10A Dartmouth Road, Forest Hill, SE23 3XU

Tel: 02030024089 Email: foresthill@hunters.com <https://www.hunters.com>