



## Grecian Street, , Maidstone, ME14 2TS

- Log burning stove
- Rear garden
- Close to local amenities
- Council Tax Band B
- Two double bedroom
- On street parking with Council Permit
- EPC D

**Offers In The Region Of £260,000**



# Grecian Street, Maidstone, ME14 2TS

## DESCRIPTION

Nestled on the charming Grecian Street in Maidstone, this delightful mid-terrace house offers a perfect blend of comfort and practicality. Upon entering, you are welcomed into a cosy lounge, complete with a charming log burning stove, ideal for those chilly evenings. The adjoining kitchen provides a functional space for culinary adventures and family gatherings.

This property boasts two spacious double bedrooms, ensuring ample room for relaxation and rest. The well-appointed bathroom adds to the convenience of this home, while a useful basement room presents additional possibilities, whether for storage or as a versatile space to suit your needs.

Outside, the rear garden offers a lovely retreat, perfect for enjoying the fresh air or entertaining guests during the warmer months. This mid-terrace house is not just a place to live; it is a warm and inviting home that promises comfort and a sense of community in the heart of Maidstone. With its appealing features and prime location, this property is an excellent opportunity for those seeking a charming residence in a vibrant area. With accessibility for on street parking with a council permit.

**Flood Risk:** Very low Each year, there is a chance of flooding of less than 1 in 1000 (0.1%)

**Services:** Gas fired central heating, mains drainage and mains electricity.

**Average Broadband Speed:** Superfast 76mb Ultrafast 1000mb





BASEMENT

GROUND FLOOR

1ST FLOOR

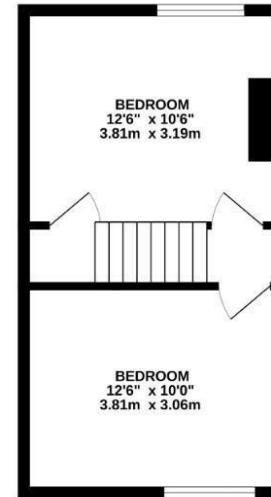
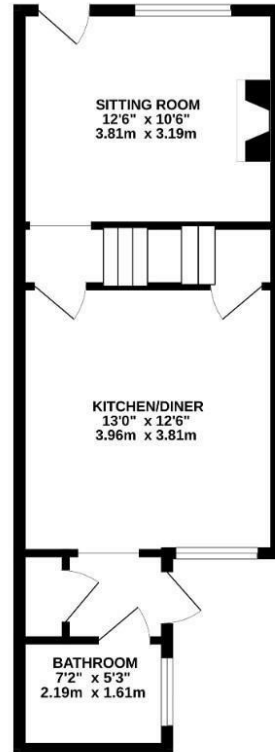
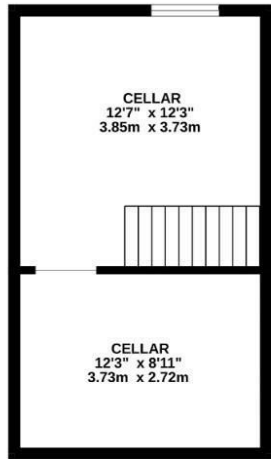

Whilst every attempt has been made to ensure the accuracy of the floorplan contained here, measurements of doors, windows, rooms and any other items are approximate and no responsibility is taken for any error, omission or mis-statement. This plan is for illustrative purposes only and should be used as such by any prospective purchaser. The services, systems and appliances shown have not been tested and no guarantee as to their operability or efficiency can be given.  
Made with Metropix ©2026

### Viewings

Please contact [Maidstone@hunters.com](mailto:Maidstone@hunters.com), if you wish to arrange a viewing appointment for this property or require further information.

### Valuations

For a valuation of your property, please email the team with your property details, contact information and the times you are available.

## ENERGY PERFORMANCE CERTIFICATE

The energy efficiency rating is a measure of the overall efficacy of a home. The higher the rating the more energy efficient the home is and the lower the fuel bills will be.

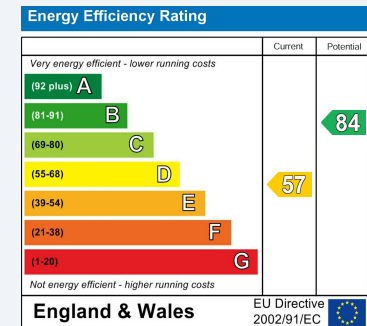

These particulars are intended to give a fair and reliable description of the property but no responsibility for any inaccuracy or error can be accepted and do not constitute an offer or contract. We have not tested any services or appliances (including central heating if fitted) referred to in these particulars and the purchasers are advised themselves as to the working order and condition. If a property is unoccupied at any time there may be reconnection charges for any switched off/disconnected or drained services or appliances - All measurements are approximate.

**THINKING OF SELLING?** If you are thinking of selling your home or just curious to discover the value of your property, Hunters would be pleased to provide free, no obligation sales and marketing advice. Even if your home is outside the area covered by our local offices we can arrange a Market Appraisal through our national network of Hunters estate agents.



65 High Street, Maidstone, ME14 1SR  
Tel: 01622 278003 Email: [Maidstone@hunters.com](mailto:Maidstone@hunters.com) <https://www.hunters.com>

