



Highland Road, Maidstone, ME15 7QQ

- No forward chain
- Recently decorated throughout
- Parking to front
- Entrance porch
- Three Bedrooms
- Recently landscaped rear garden

Asking Price £300,000

Highland Road, Maidstone, ME15 7QQ



Situated on Highland Road in Maidstone, this delightful terraced house presents an excellent opportunity for families and first-time buyers alike. The property boasts a sizeable entrance porch and three well-proportioned bedrooms, providing ample space for relaxation and rest. The inviting lounge/diner offers a warm and welcoming atmosphere, perfect for entertaining guests or enjoying quiet evenings at home and opens out onto the rear garden .

The heart of the home is undoubtedly the spacious kitchen. This area is designed to be both functional and stylish, making it a wonderful space for culinary creativity.

Stepping outside, you will find a very recently landscaped rear garden and patio, a serene retreat for outdoor enjoyment, gardening, or simply soaking up the sun. The garden is well-maintained with an array of shrubs and flowers, providing a picturesque setting for summer barbecues or peaceful afternoons.

For those with vehicles, the property includes parking to the front for two cars, a valuable feature in this sought-after area. Additionally, the absence of a chain means a smoother transition for potential buyers, allowing for a quicker move-in process.

This property on Highland Road is not just a house; it is a home waiting to be filled with memories. With its prime location, spacious living areas, and lovely outdoor space, it is a must-see for anyone looking to settle in Maidstone.

Services: Mains gas and electricity and mains drainage

Broadband: Ultrafast broadband Max Download 1000 Mbps

Flood Risk: Very low each year, there is a chance of flooding of less than 1 in 1000 (0.1%)

Superfast broadband Max Upload 1000 Mbps



Highland Road, Maidstone, ME15 7QQ



GROUND FLOOR

1ST FLOOR

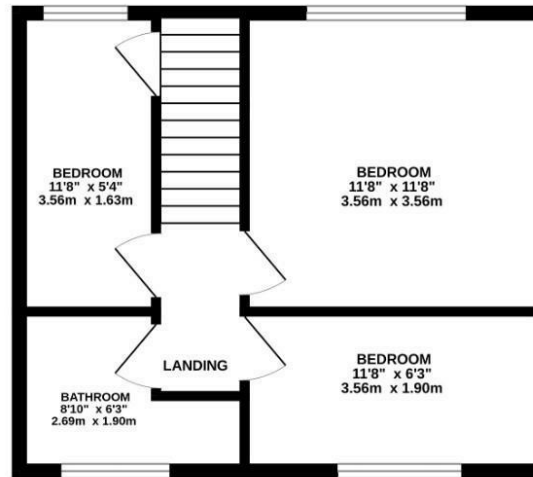
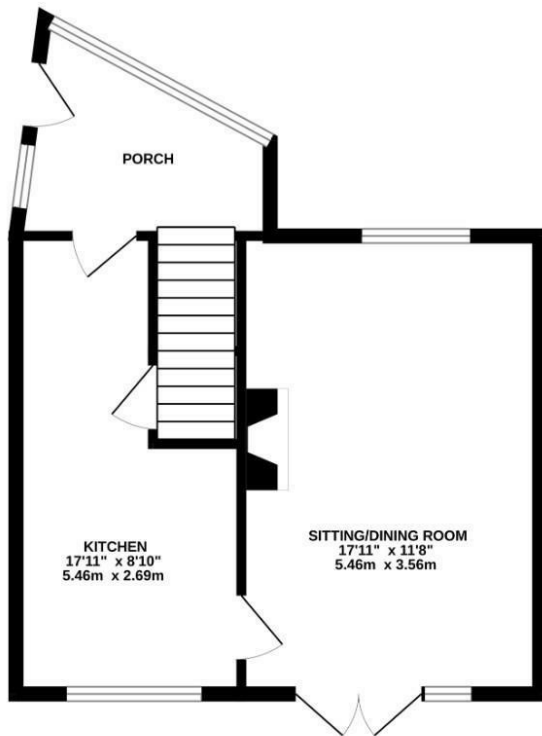

Whilst every attempt has been made to ensure the accuracy of the floorplan contained here, measurements of doors, windows, rooms and any other items are approximate and no responsibility is taken for any error, omission or mis-statement. This plan is for illustrative purposes only and should be used as such by any prospective purchaser. The services, systems and appliances shown have not been tested and no guarantee as to their operability or efficiency can be given.
Made with Metropix ©2025

Viewings

Please contact Maidstone@hunters.com, if you wish to arrange a viewing appointment for this property or require further information.

Valuations

For a valuation of your property, please email the team with your property details, contact information and the times you are available.

ENERGY PERFORMANCE CERTIFICATE

The energy efficiency rating is a measure of the overall efficacy of a home. The higher the rating the more energy efficient the home is and the lower the fuel bills will be.

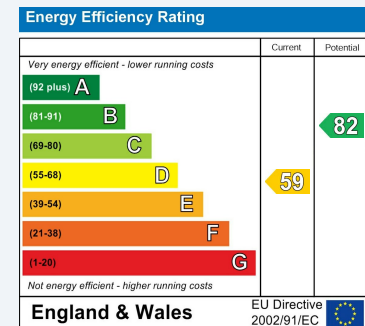

These particulars are intended to give a fair and reliable description of the property but no responsibility for any inaccuracy or error can be accepted and do not constitute an offer or contract. We have not tested any services or appliances (including central heating if fitted) referred to in these particulars and the purchasers are advised to satisfy themselves as to the working order and condition. If a property is unoccupied at any time there may be reconnection charges for any switched off/disconnected or drained services or appliances - All measurements are approximate.

THINKING OF SELLING? If you are thinking of selling your home or just curious to discover the value of your property, Hunters would be pleased to provide free, no obligation sales and marketing advice. Even if your home is outside the area covered by our local offices we can arrange a Market Appraisal through our national network of Hunters estate agents.