

# HUNTERS<sup>®</sup>

HERE TO GET *you* THERE



## Hamilton Close

Stourbridge, DY8 5EU



Council Tax: B



# 26 Hamilton Close

Stourbridge, DY8 5EU

£290,000



## The Front of The Property

There is a block paved driveway, double glazed door to utility room and a double glazed door to entrance hall.

## Entrance Hall

With a double glazed door leading from the front of the property, doors to various rooms, stairs to first floor landing and a central heating radiator.

## Office/Study

6'2" x 8'6" (1.9m x 2.6m)

With a door leading from the entrance hall, double glazed window to front and a central heating radiator.

## Lounge/Dining Room

15'1" x 13'9" (4.6m x 4.2m )

With a door leading from the entrance hall, feature fireplace, under stairs storage cupboard, door to kitchen, double glazed window to rear and a central heating radiator.

## Kitchen

8'2" x 16'0" (2.5m x 4.9m)

With a door leading from the lounge, a range of wall and base units, one and a half stainless steel sink drainer, oven, electric hob with stainless steel cooker hood above, breakfast bar with seating, space for fridge/freezer, door to bedroom four, patio door to garden, two double glazed windows to rear and a column style radiator.

## Bedroom Four/Snug

13'5" x 8'2" (4.1m x 2.5m )

With a door leading from the kitchen, door to utility and a central heating radiator.

## Landing

With stairs leading from the entrance hall, doors to various rooms, loft access and over stairs storage cupboard.

### Bedroom Three

9'2" x 5'10" (2.8m x 1.8m)

With a door leading from the landing, double glazed window to rear and a central heating radiator.

### Bedroom Two

9'6" x 8'6" (2.9m x 2.6m)

With a door leading from the landing, double glazed window to front and a central heating radiator.

### Bathroom

5'2" x 5'10" (1.6m x 1.8m)

With a door leading from the landing, W/C, hand wash basin, tiled splashback, shower over bath, shower screen, double glazed window to front and a central heating radiator.

### Bedroom One

12'1" x 8'6" (3.7m x 2.6m)

With a door leading from the landing, double glazed window to rear and a central heating radiator.

### Garden

With patio doors leading from the kitchen, block paved patio, rear lawn and shrubbed borders.



## Road Map



## Hybrid Map



## Terrain Map

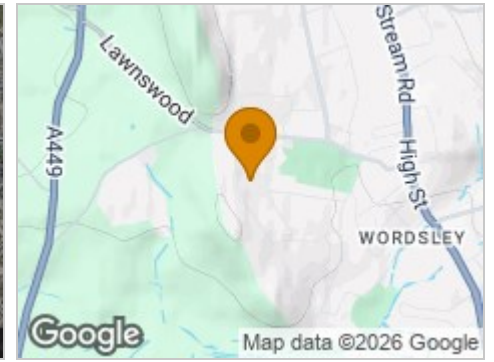

## Floor Plan

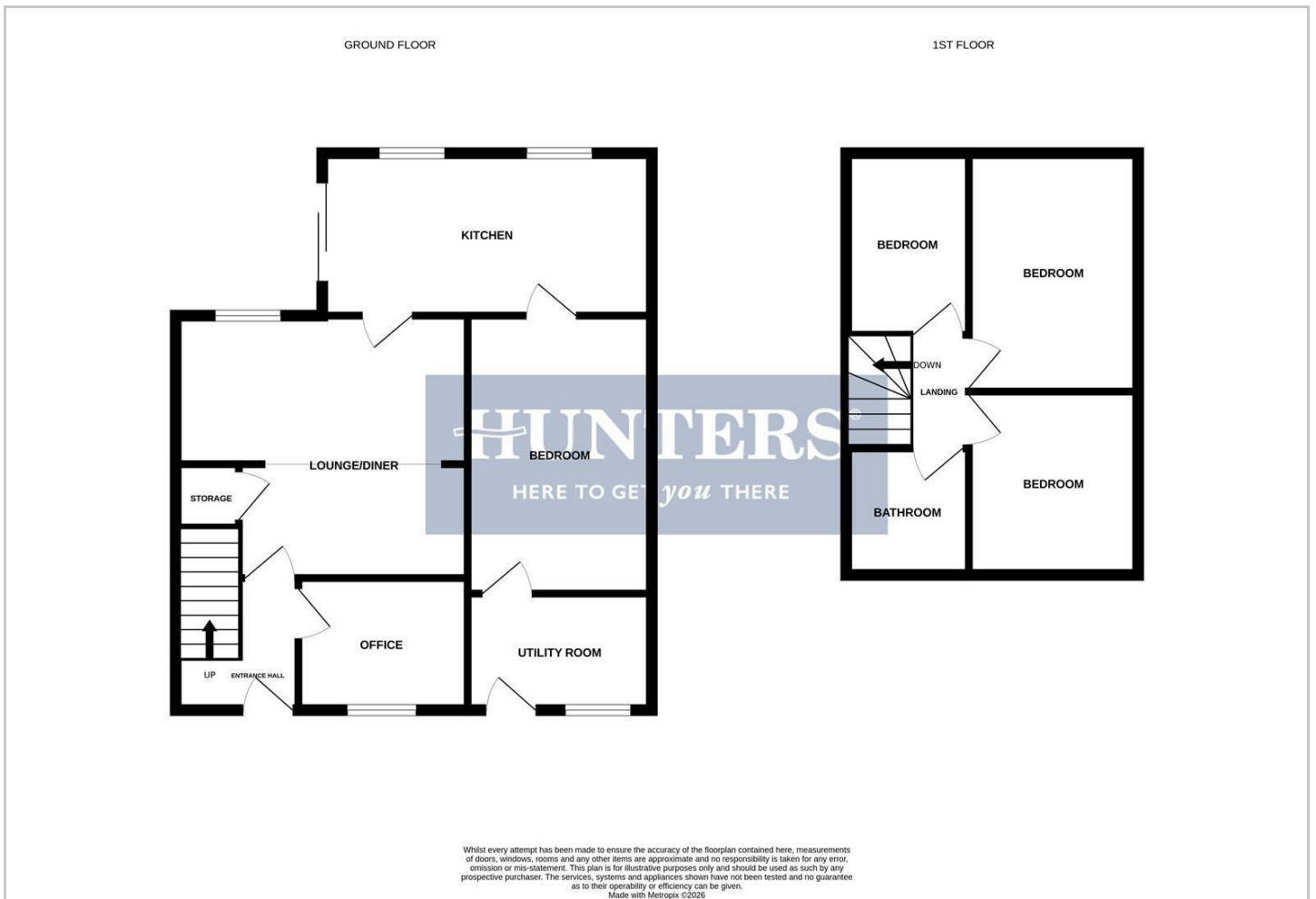

## Viewing

Please contact our Hunters Stourbridge Office on 01384 443331 if you wish to arrange a viewing appointment for this property or require further information.

## Energy Efficiency Graph

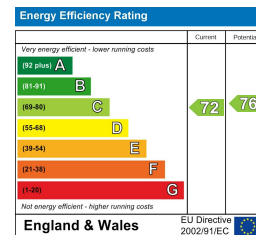

These particulars are intended to give a fair and reliable description of the property but no responsibility for any inaccuracy or error can be accepted and do not constitute an offer or contract. We have not tested any services or appliances (including central heating if fitted) referred to in these particulars and the purchasers are advised to satisfy themselves as to the working order and condition. If a property is unoccupied at any time there may be reconnection charges for any switched off/disconnected or drained services or appliances - All measurements are approximate. **THINKING OF SELLING?** If you are thinking of selling your home or just curious to discover the value of your property, Hunters would be pleased to provide free, no obligation sales and marketing advice. Even if your home is outside the area covered by our local offices we can arrange a Market Appraisal through our national network of Hunters estate agents.