

Apartment (EPC Rating: D)

**14 GLADSTONE ROAD, WATFORD,
WD17 2QY**

Per Calendar Month

£1,400 Per

2 Bedroom Apartment located in Watford

Two bedroom apartment located on Gladstone Road in the lovely town of Watford. This property boasts a reception rooms. With two bedrooms, there is ample space.

Spanning 463 square feet, this apartment provides a comfortable living space for its occupants.

Additionally, the property includes parking space for one vehicle.

Situated in a convenient location, this apartment offers easy access to local amenities, schools, and transport links.

0.3 MILES TO WATFORD HIGH STREET STATION.

0.3 MILES TO ATRIA.

0.5 MILES TO WATFORD GRAMMAR SCHOOL FOR GIRLS.

0.7 MILES TO WATFORD JUNCTION RAILWAY STATION.

1 MILE TO WATFORD GENERAL HOSPITAL.

1.3 MILES TO WATFORD GRAMMAR SCHOOL FOR BOYS.

1.5 MILES TO METROPOLITAN STATION APPROACH.



WATFORD LETTINGS | 12 MARKET STREET, WATFORD, HERTFORDSHIRE, WD18 0PD

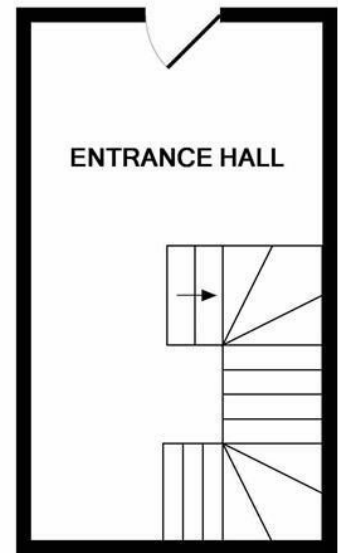
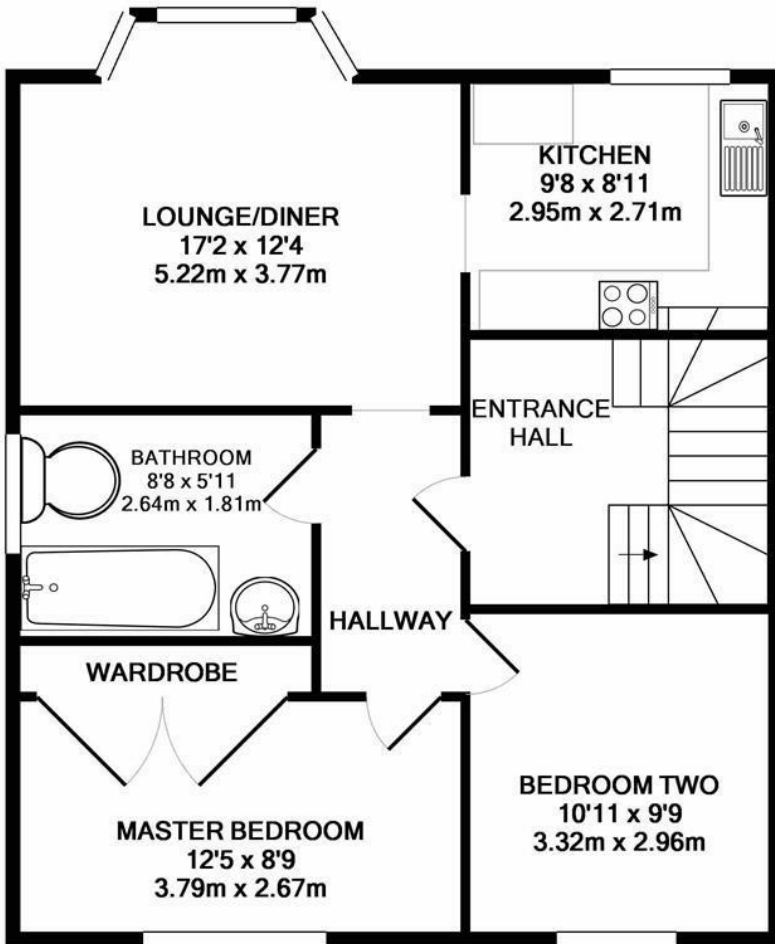

1ST FLOOR
APPROX. FLOOR
AREA 178 SQ.FT.
(16.5 SQ.M.)

GROUND FLOOR
APPROX. FLOOR
AREA 731 SQ.FT.
(67.9 SQ.M.)

TOTAL APPROX. FLOOR AREA 909 SQ.FT. (84.4 SQ.M.)

Whilst every attempt has been made to ensure the accuracy of the floor plan contained here, measurements of doors, windows, rooms and any other items are approximate and no responsibility is taken for any error, omission, or mis-statement. This plan is for illustrative purposes only and should be used as such by any prospective purchaser. The services, systems and appliances shown have not been tested and no guarantee as to their operability or efficiency can be given

Made with Metropix ©2019

Council Tax Band

D

Energy Performance Graph

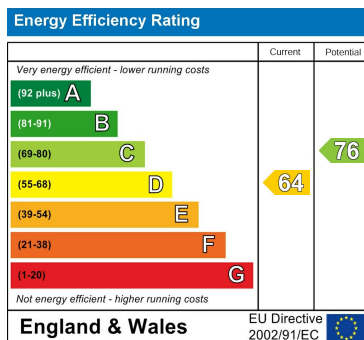

Call us on

01923 220 012

rentals@warrenanthony.co.uk

www.warrenanthony.co.uk

Agents Note: Whilst every care has been taken to prepare these particulars, they are for guidance purposes only. All measurements are approximate and are for general guidance purposes only and whilst every care has been taken to ensure their accuracy, they should not be relied upon and potential buyers are advised to recheck the