



Apartment (EPC Rating:)

CROMER ROAD, WATFORD, WD24 4DY

PCM

£1,050 PCM



1 Bedroom Apartment located in Watford

PERFECTLY LOCATED ONE BEDROOM MAISONETTE ON A QUIET ROAD WITH FAST ACCESS TO ST ALBANS ROAD. LOCATED NEARBY AN ABUNDANCE OF SHOPS, RESTURANTS AND MANY MORE! IDEAL FOR A SINGLE PROFESSIONAL WORKER OR A COUPLE! AVAILABLE DECEMBER 2024

First floor, one bedroom masionette located off of St Albans Road perfect for a single professional worker or couples!

Upon entry the stairs will take you directly up to the open plan living room with small kitchenette area. There are large bay windows overlooking the front of the property as well as a sizeable cupboard allowing plenty of room for storage.

The double bedroom has a wall-to-wall wardrobe which comes with the property as well as a spacious bathroom containing a bath, shower, sink and toilet.

Available to move in JUNE 2024



WATFORD LETTINGS | 12 MARKET STREET, WATFORD, HERTFORDSHIRE, WD18 0PD

BASEMENT
43 sq ft. (4.0 sq.m.) approx.

GROUND FLOOR
471 sq ft. (43.7 sq.m.) approx.

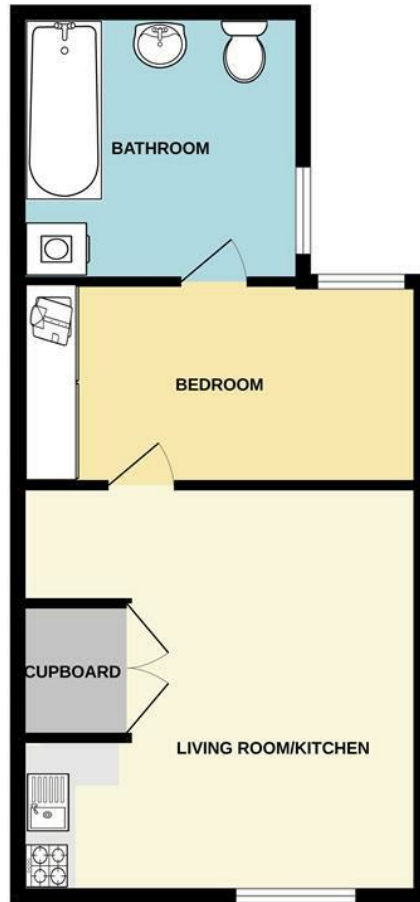
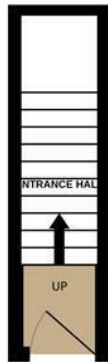

1 BEDROOM 1 BATHROOM

TOTAL FLOOR AREA: 514 sq ft. (47.7 sq.m.) approx.

Whilst every attempt has been made to ensure the accuracy of the floorplan contained here, measurements of doors, windows, rooms and any other items are approximate and no responsibility is taken for any error, omission or mis-statement. This plan is for illustrative purposes only and should be used as such by any prospective purchaser. The services, systems and appliances shown have not been tested and no guarantee as to their operability or efficiency can be given.
Made with Metropix ©2023

Council Tax Band

Energy Performance Graph

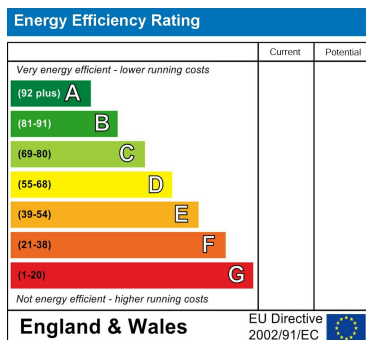

Call us on

01923 220 012

enquiries@warrenanthony.co.uk

www.warrenanthony.co.uk

Agents Note: Whilst every care has been taken to prepare these particulars, they are for guidance purposes only. All measurements are approximate and are for general guidance purposes only and whilst every care has been taken to ensure their accuracy, they should not be relied upon and potential buyers are advised to recheck the