



Apartment (EPC Rating: )

**WATFORD, WD18 0WY**

PCM

**£1,350 PCM**

# 1 Bedroom Apartment located in Watford

A BRAND NEW DEVELOPMENT IN THE HEART OF CENTRAL WATFORD - JUST MINUTES FROM THE HEART OF WATFORDS BUSTLING TOWN CENTRE AND ITS VAST ARRAY OF SHOPS, BARS, RESTAURANTS AND LEISURE FACILITIES. 0.9 MILES TO WATFORD JUNCTION - 0.4 MILES TO WATFORD HOSPITAL.

IN THE HEART OF CENTRAL WATFORD - JUST MINUTES FROM THE HEART OF WATFORDS BUSTLING TOWN CENTRE AND ITS VAST ARRAY OF SHOPS, BARS, RESTAURANTS AND LEISURE FACILITIES. 0.9 MILES TO WATFORD JUNCTION - 0.4 MILES TO WATFORD HOSPITAL

This well-proportioned one-bedroom apartment comprises of an entrance hallway with a live feed video entry phone, one double bedroom with fitted wardrobes, a modern fully tiled bathroom, and a large open plan living room/kitchen area. The kitchen has integrated dishwasher, washing machine, fridge freezers, cooker, and hob plus ample cupboard space. All rooms are fitted with venetian blinds and grey laminate wood effect flooring. The apartment comes with a large loft area with pull down ladders.

This property is in the heart of Watford, there is no parking available, but you do not need it with stations, transport links, and all of the restaurants and supermarkets on your doorstep!

Available beginning of March 2024!



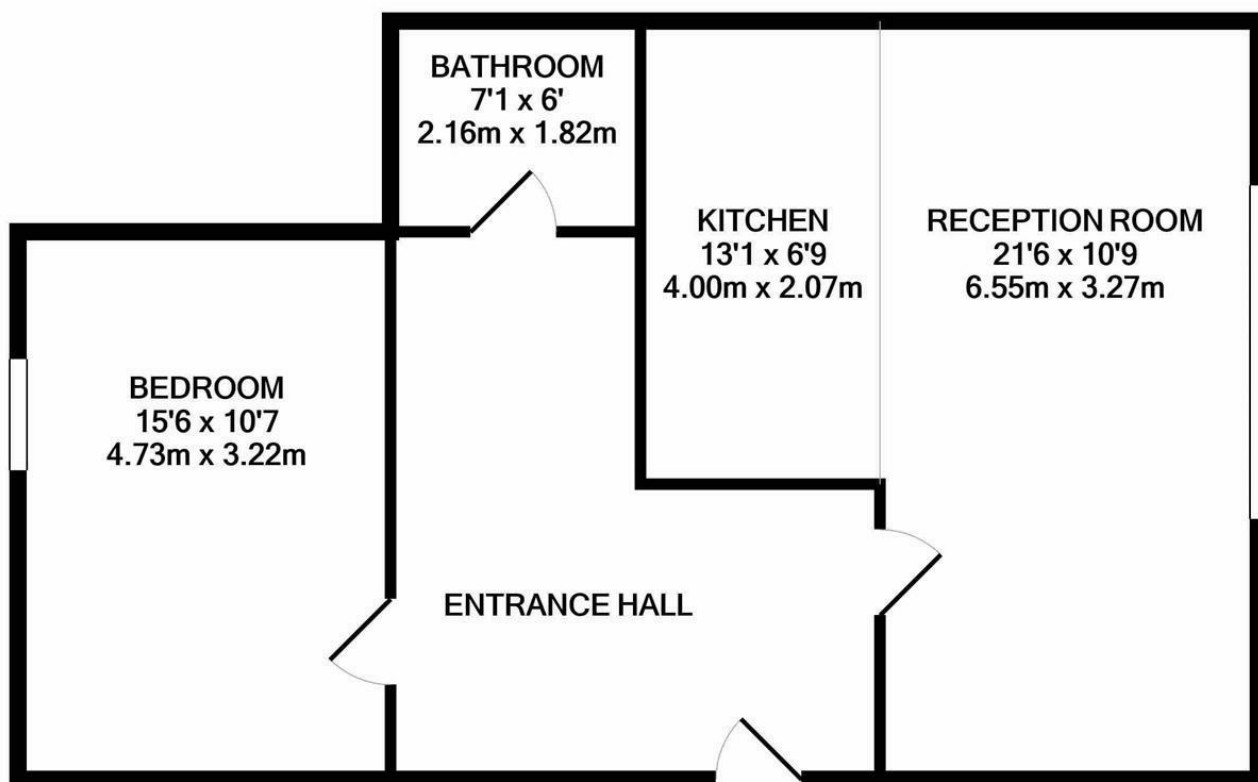

TOTAL APPROX. FLOOR AREA 693 SQ.FT. (64.4 SQ.M.)

Whilst every attempt has been made to ensure the accuracy of the floor plan contained here, measurements of doors, windows, rooms and any other items are approximate and no responsibility is taken for any error, omission, or mis-statement. This plan is for illustrative purposes only and should be used as such by any prospective purchaser. The services, systems and appliances shown have not been tested and no guarantee as to their operability or efficiency can be given  
Made with Metropix ©2022

Council Tax Band

Energy Performance Graph

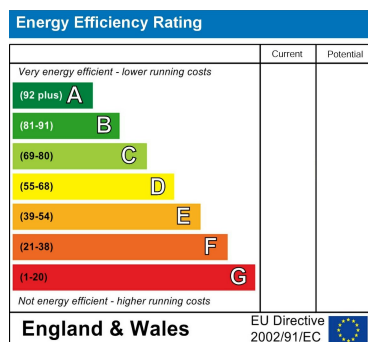

Call us on

**01923 220 012**

**enquiries@warrenanthony.co.uk**

**www.warrenanthony.co.uk**

Agents Note: Whilst every care has been taken to prepare these particulars, they are for guidance purposes only. All measurements are approximate and are for general guidance purposes only and whilst every care has been taken to ensure their accuracy, they should not be relied upon and potential buyers are advised to recheck the