



House - Terraced (EPC Rating: C)

**ST MARYS ROAD, WATFORD, WD18
0EE**

Per Month

£1,700 Per

3 Bedroom House - Terraced located in Watford

TWO/THREE BEDROOM FAMILY HOME LOCATED IN THE HEART OF WATFORD JUST 0.2 MILES FROM WATFORD TOWN CENTRE - 0.3 MILES TO WATFORD GIRLS GRAMMAR SCHOOL & 0.8 MILES TO WATFORD JUNCTION STATION - AVAILABLE NOW!

This property is in a prime location offering convenience to families and commuters.

This house comprises of; living room, dining room, kitchen and downstairs bathroom. On the first floor, there are two double bedrooms (one with en-suite) and a small third room off the second.

The road is a one way road offering permit parking. Additional benefits are gas central heating, double glazing and a rear garden.

Offered furnished but can be flexible. Available immediately!

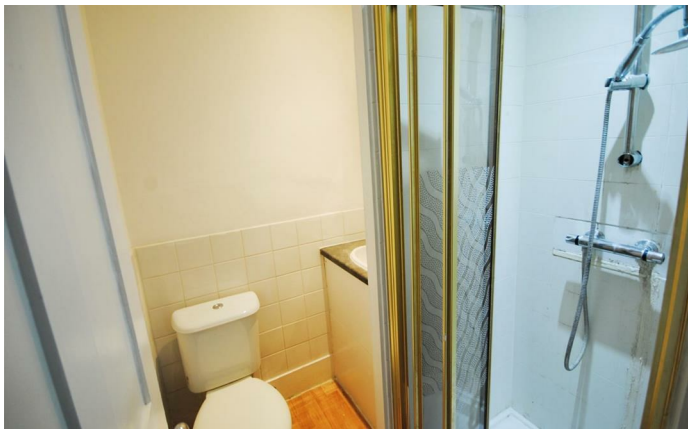

WATFORD LETTINGS | 12 MARKET STREET, WATFORD, HERTFORDSHIRE, WD18 0PD

GROUND FLOOR
389 sq.ft. (36.1 sq.m.) approx.

1ST FLOOR
319 sq.ft. (29.6 sq.m.) approx.

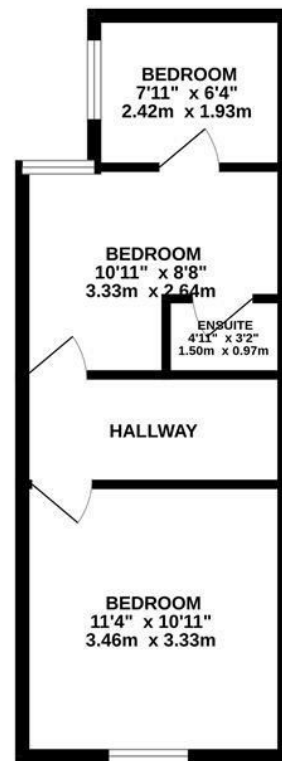
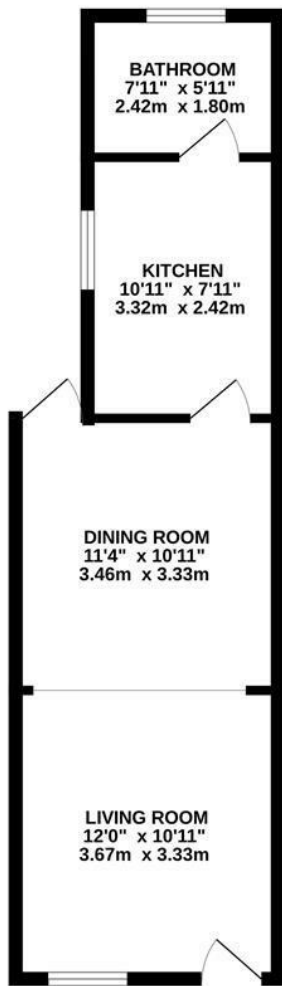

TOTAL FLOOR AREA: 708 sq.ft. (65.8 sq.m.) approx.

Whilst every attempt has been made to ensure the accuracy of the floorplan contained here, measurements of doors, windows, rooms and any other items are approximate and no responsibility is taken for any error, omission or mis-statement. This plan is for illustrative purposes only and should be used as such by any prospective purchaser. The services, systems and appliances shown have not been tested and no guarantee as to their operability or efficiency can be given.
Made with Metropix ©2025

Council Tax Band

C

Energy Performance Graph

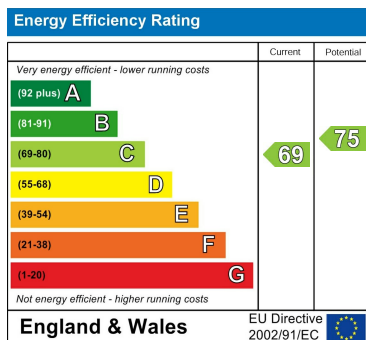

Call us on

01923 220 012

enquiries@warrenanthony.co.uk

www.warrenanthony.co.uk

Agents Note: Whilst every care has been taken to prepare these particulars, they are for guidance purposes only. All measurements are approximate and are for general guidance purposes only and whilst every care has been taken to ensure their accuracy, they should not be relied upon and potential buyers are advised to recheck the