



Apartment (EPC Rating: E)

**FARRIERS COURT, HORSESHOE LANE,  
WATFORD, WD25 7JB**

Per Calendar Month

**£1,150 Per**

# 1 Bedroom Apartment located in Watford

Spacious One Double Bedroom Apartment - Excellent Access to M1, M25 & A41- Available Mid July 2025.

This third-floor apartment is offered to a high standard and provides a bright, modern living space. The property features a generous lounge/diner, which benefits from plenty of natural light. The bedroom is a good size and includes mirror-fronted fitted wardrobes, providing ample storage space.

The apartment also includes a sleek, modern kitchen fitted with contemporary appliance. The bathroom comes equipped with a shower.

The apartment benefits from double glazing throughout. There is also allocated parking, providing a dedicated space for your vehicle, and small communal gardens.

Offered unfurnished. It's ideally located with excellent bus routes to Watford and St Albans, and is just a minute's drive from the M1, offering quick access to the M25 and A41.

No Pets Allowed – Available for move-in mid-July 2025.





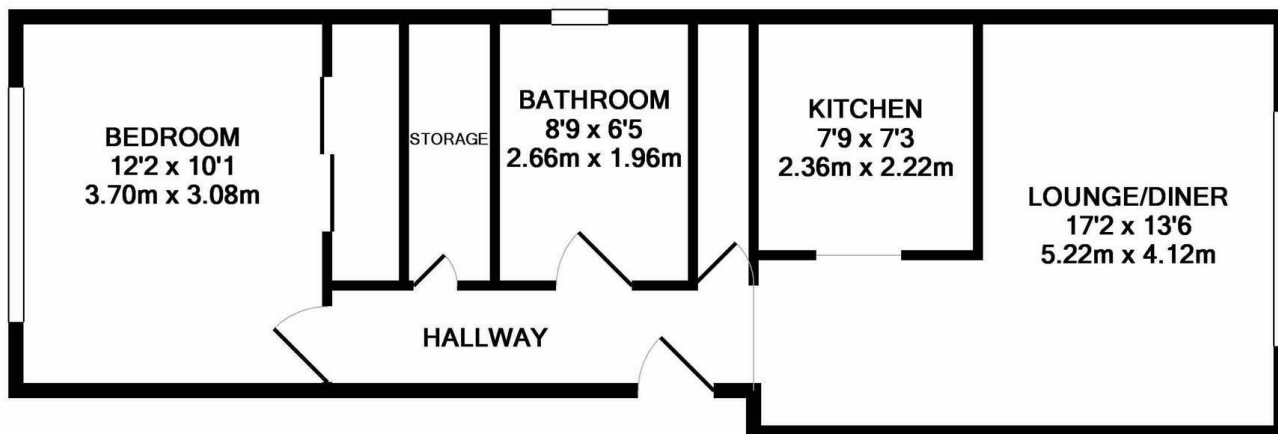

TOTAL APPROX. FLOOR AREA 522 SQ.FT. (48.5 SQ.M.)

Whilst every attempt has been made to ensure the accuracy of the floor plan contained here, measurements of doors, windows, rooms and any other items are approximate and no responsibility is taken for any error, omission, or mis-statement. This plan is for illustrative purposes only and should be used as such by any prospective purchaser. The services, systems and appliances shown have not been tested and no guarantee as to their operability or efficiency can be given  
Made with Metropix ©2018

Council Tax Band

**E**

Energy Performance Graph

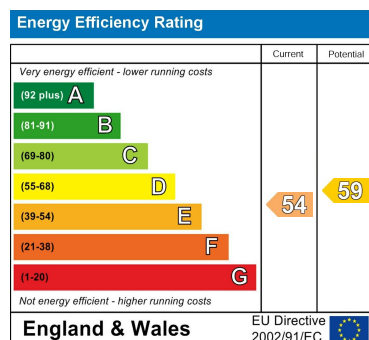

Call us on

**01923 220 012**

**enquiries@warrenanthony.co.uk**

**www.warrenanthony.co.uk**

Agents Note: Whilst every care has been taken to prepare these particulars, they are for guidance purposes only. All measurements are approximate and are for general guidance purposes only and whilst every care has been taken to ensure their accuracy, they should not be relied upon and potential buyers are advised to recheck the