



Maisonette (EPC Rating: D)

**THE PARADE, DELTA GAIN,
CARPENDERS PARK, WATFORD, WD19**
Per Calendar Month
£1,800 Per

3 Bedroom Maisonette located in Watford

Warren Anthony are delighted to present this spacious three-bedroom maisonette, located in a quiet residential area close to Carpenders Park station, this property is well-suited for families and professionals.

The home welcomes you into a bright and expansive open-plan living and dining area, finished with neutral décor and stylish wood-effect flooring. Large double-glazed windows throughout.

The modern kitchen is fully fitted with sleek cabinetry and contemporary worktops, complete with an integrated oven and hob, a washing machine, and a built-in boiler.

The bathroom is finished in sophisticated marble-effect tiles and features a full-sized bathtub with an overhead shower and glass screen. A stylish vanity unit with under-sink storage and a frosted window add both practicality and privacy.

The property offers three well-proportioned bedrooms, all carpeted for added comfort. The master and second bedrooms are bright and generously sized, while the third bedroom is ideal for use as a home office or nursery. Each room benefits from gas central heating via radiators.



1ST FLOOR
403 sq.ft. (37.4 sq.m.) approx.

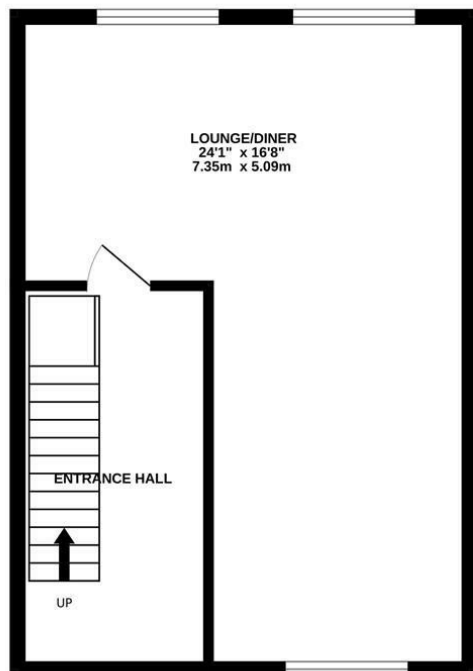

2ND FLOOR
403 sq.ft. (37.4 sq.m.) approx.

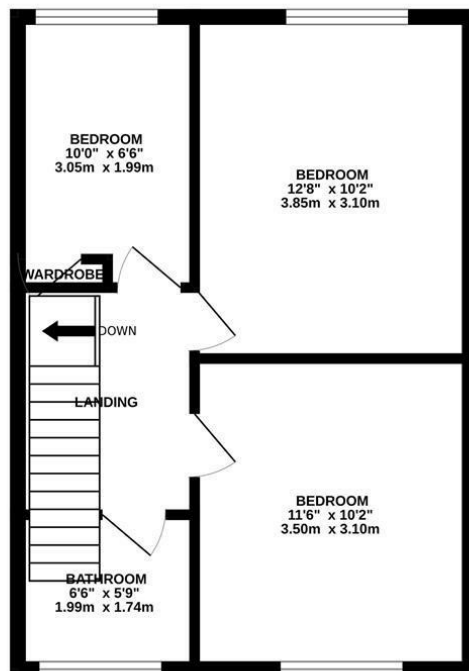

TOTAL FLOOR AREA : 805 sq.ft. (74.8 sq.m.) approx.

Whilst every attempt has been made to ensure the accuracy of the floorplan contained here, measurements of doors, windows, rooms and any other items are approximate and no responsibility is taken for any error, omission or mis-statement. This plan is for illustrative purposes only and should be used as such by any prospective purchaser. The services, systems and appliances shown have not been tested and no guarantee as to their operability or efficiency can be given.
Made with Metropix ©2023

Council Tax Band

D

Energy Performance Graph

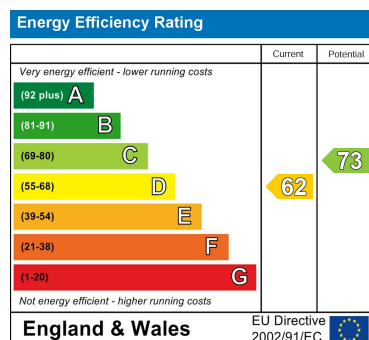

Call us on

01923 220 012

enquiries@warrenanthony.co.uk

www.warrenanthony.co.uk

Agents Note: Whilst every care has been taken to prepare these particulars, they are for guidance purposes only. All measurements are approximate and are for general guidance purposes only and whilst every care has been taken to ensure their accuracy, they should not be relied upon and potential buyers are advised to recheck the