



Apartment (EPC Rating: )

MERTON ROAD, WATFORD, WD18 0WY

PCM

£1,600 PCM

# 2 Bedroom Apartment located in Watford

A MODERN DEVELOPMENT IN THE HEART OF CENRAL WATFORD - JUST MINUTES FROM WATFORDS BUSTILING TOWN CENTERE AND ITS VAST ARRAY OF SHOPS, BARS, RESTAURANTS AND LEISURE FACILTIES. NO PARKING!

This spacious, modern, two-bedroom apartment comprises of an entrance hallway with a live feed video entry phone, two double bedrooms both with fitted wardrobes and modern grey carpets, a modern fully tiled bathroom, and a very large open plan living room/kitchen area. The kitchen comes with integrated appliances including a family size fridge freezer, dishwasher, hob, and cooker.

All appliances are from Howdens. All communal areas are fitted with venetian blinds, and grey laminate wood effect flooring.

The apartment comes with a large loft area with pull down ladders.

This property is in the heart of Watford, there is no parking available, but you do not need it with stations, transport links, and all of the restaurants and supermarkets on your doorstep!

Unfurnished and available from November 2025



WATFORD LETTINGS | 12 MARKET STREET, WATFORD, HERTFORDSHIRE, WD18 0PD

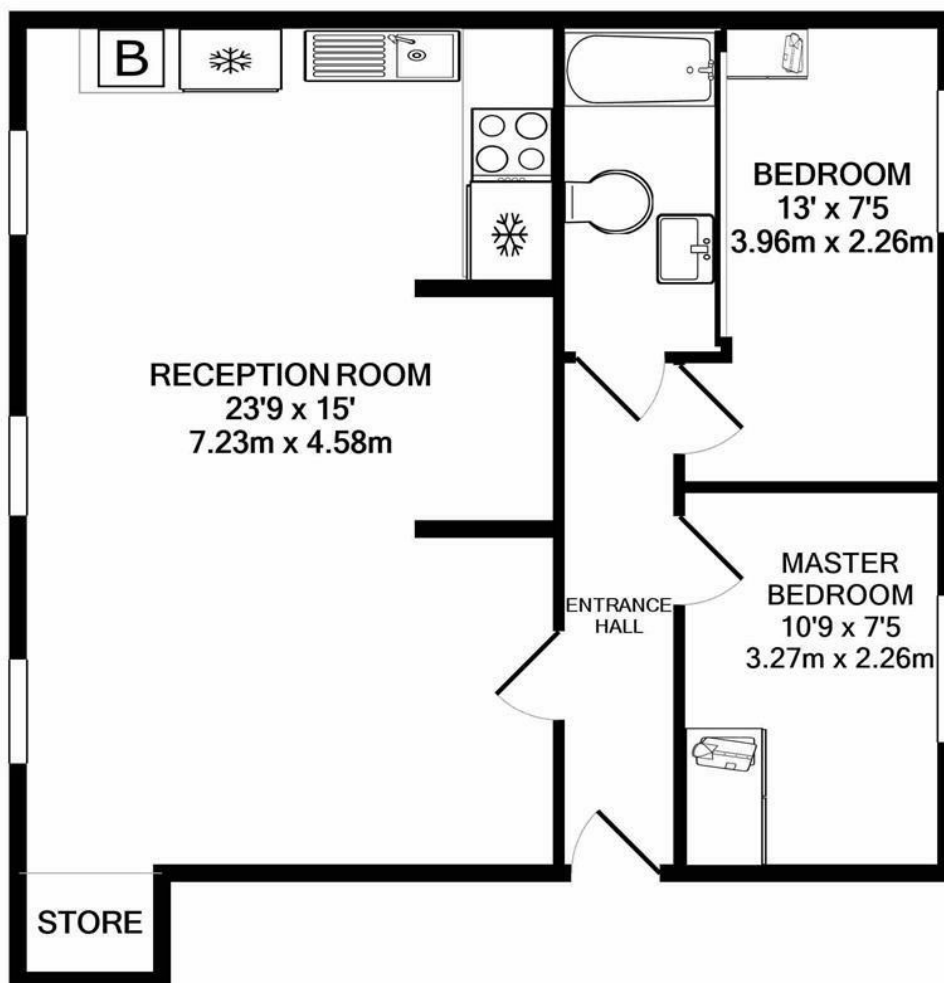

TOTAL APPROX. FLOOR AREA 621 SQ.FT. (57.7 SQ.M.)

Whilst every attempt has been made to ensure the accuracy of the floor plan contained here, measurements of doors, windows, rooms and any other items are approximate and no responsibility is taken for any error, omission, or mis-statement. This plan is for illustrative purposes only and should be used as such by any prospective purchaser. The services, systems and appliances shown have not been tested and no guarantee as to their operability or efficiency can be given

Made with Metropix ©2022

Council Tax Band

Call us on

**01923 220 012**

**enquiries@warrenanthony.co.uk**

**www.warrenanthony.co.uk**

Energy Performance Graph

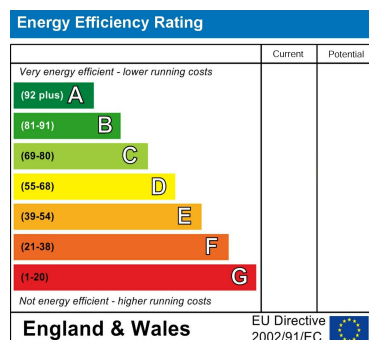

Agents Note: Whilst every care has been taken to prepare these particulars, they are for guidance purposes only. All measurements are approximate and are for general guidance purposes only and whilst every care has been taken to ensure their accuracy, they should not be relied upon and potential buyers are advised to recheck the