

House - Terraced (EPC Rating:)

**TUCKER STREET, WATFORD, WD18
0AU**
Per Calendar Month
£1,650 Per

2 Bedroom House - Terraced located in Watford

TWO BEDROOM HOUSE LOCATED IN WATFORD FIELDS JUST 370 FEET TO FIELD JUNIOR SCHOOL AND 0.4 MILES TO WATFORD GIRLS GRAMMAR SCHOOL - AVAILABLE OCTOBER 2025.

Located in Watford Fields, this delightful home presents a unique opportunity for those seeking a two-bedroom home in a highly sought-after location. Just a short stroll of 370 feet from Field Junior School, this property is ideally situated for families prioritising education, with the esteemed Watford Girls Grammar School only 0.4 miles away.

The property boasts two spacious reception rooms, providing ample space for relaxation and entertaining. The kitchen is practical and there are also two double bedrooms off landing. A conveniently located bathroom also off the landing adds to the practicality of this lovely home.

There is the option of permit parking available along with double glazing and gas central heating. This house is offered unfurnished and available end of October 2025.



WATFORD LETTINGS | 12 MARKET STREET, WATFORD, HERTFORDSHIRE, WD18 0PD

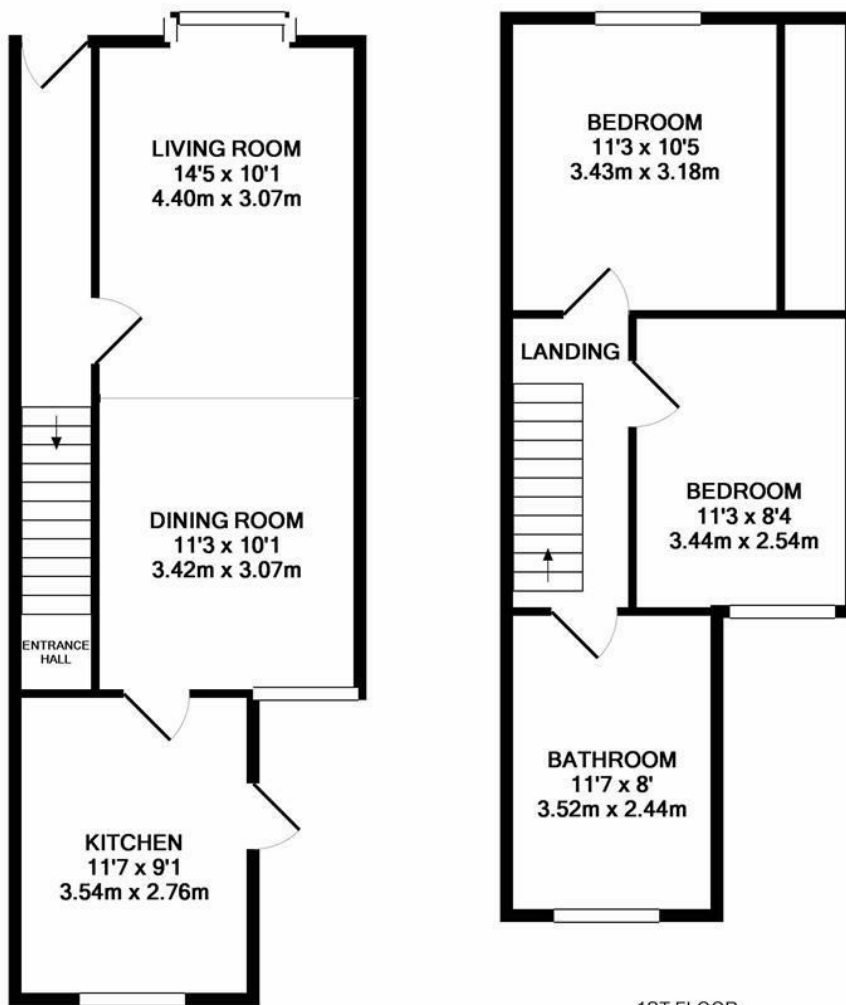

GROUND FLOOR
APPROX. FLOOR
AREA 434 SQ.FT.
(40.3 SQ.M.)

1ST FLOOR
APPROX. FLOOR
AREA 388 SQ.FT.
(36.1 SQ.M.)

TOTAL APPROX. FLOOR AREA 823 SQ.FT. (76.4 SQ.M.)

Whilst every attempt has been made to ensure the accuracy of the floor plan contained here, measurements of doors, windows, rooms and any other items are approximate and no responsibility is taken for any error, omission, or mis-statement. This plan is for illustrative purposes only and should be used as such by any prospective purchaser. The services, systems and appliances shown have not been tested and no guarantee as to their operability or efficiency can be given
Made with Metropix ©2019

Council Tax Band

Energy Performance Graph

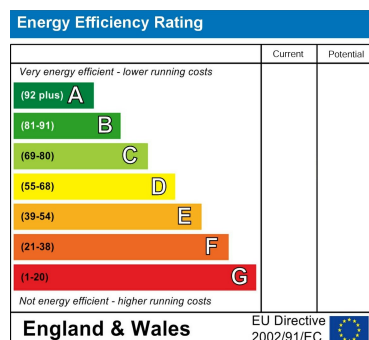

Call us on

01923 220 012

enquiries@warrenanthony.co.uk

www.warrenanthony.co.uk

Agents Note: Whilst every care has been taken to prepare these particulars, they are for guidance purposes only. All measurements are approximate and are for general guidance purposes only and whilst every care has been taken to ensure their accuracy, they should not be relied upon and potential buyers are advised to recheck the