



House - Terraced (EPC Rating: C)

**HOLYWELL ROAD, WATFORD,
HERTFORDSHIRE, WD18 0HT**

Per Calendar Month

£1,600 Per

2 Bedroom House - Terraced located in Hertfordshire

TWO BEDROOM HOUSE - BATHROOM OFF LANDING - 0.3 MILES TO WATFORD GENERAL HOSPITAL - 0.2 MILES TO LAURENCE HAINES PRIMARY SCHOOL - 0.6 MILES TO WESTFIELD ACADEMY.

This two-bedroom house is ideally located just 0.3 miles from Watford General Hospital, making it perfect for healthcare professionals. Families will also appreciate its proximity to Laurence Haines Primary School (0.2 miles) and Westfield Academy (0.6 miles). The home features a bright lounge with a bay window, a separate dining room, and a kitchen with access to an additional outside utility area. Upstairs, you'll find a spacious master bedroom with fitted wardrobes, a second double bedroom, and a bathroom conveniently located off the landing. The property is offered unfurnished and is available now.



WATFORD LETTINGS | 12 MARKET STREET, WATFORD, HERTFORDSHIRE, WD18 0PD

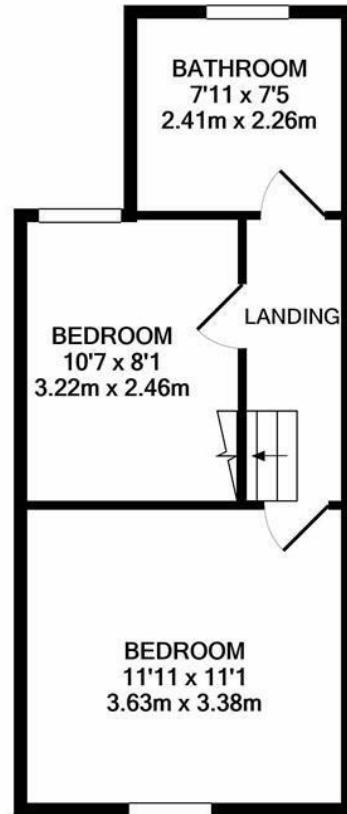
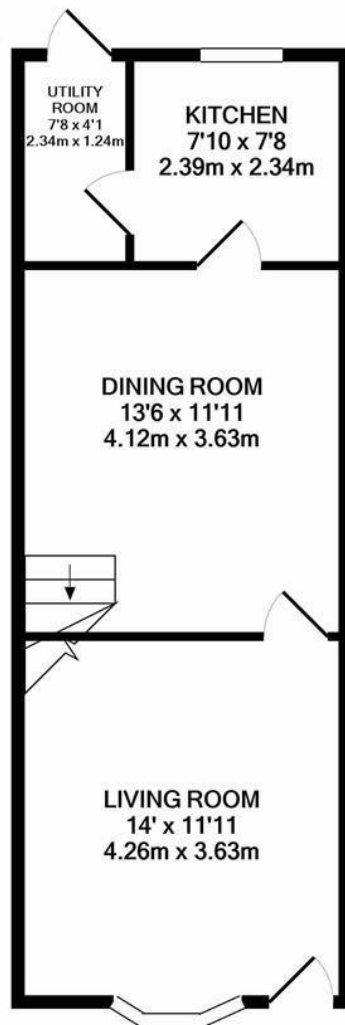

1ST FLOOR
APPROX. FLOOR
AREA 317 SQ.FT.
(29.4 SQ.M.)

GROUND FLOOR
APPROX. FLOOR
AREA 413 SQ.FT.
(38.4 SQ.M.)

TOTAL APPROX. FLOOR AREA 730 SQ.FT. (67.8 SQ.M.)

Whilst every attempt has been made to ensure the accuracy of the floor plan contained here, measurements of doors, windows, rooms and any other items are approximate and no responsibility is taken for any error, omission, or mis-statement. This plan is for illustrative purposes only and should be used as such by any prospective purchaser. The services, systems and appliances shown have not been tested and no guarantee as to their operability or efficiency can be given
Made with Metropix ©2019

Council Tax Band

C

Energy Performance Graph

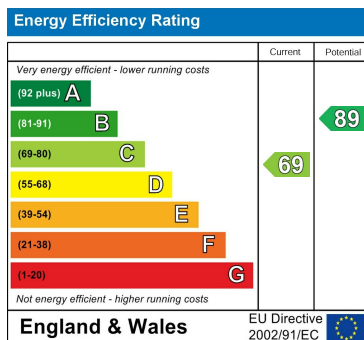

Call us on

01923 220 012

enquiries@warrenanthony.co.uk

www.warrenanthony.co.uk

Agents Note: Whilst every care has been taken to prepare these particulars, they are for guidance purposes only. All measurements are approximate and are for general guidance purposes only and whilst every care has been taken to ensure their accuracy, they should not be relied upon and potential buyers are advised to recheck the