



Apartment (EPC Rating: C)

**HIGHLANDS, OXHEY, WATFORD,  
WD19 4LY**

**PCM**

**£1,150 PCM**

# 1 Bedroom Apartment located in Watford

MODERN ONE BEDROOM GROUND FLOOR MAISONETTE LOCATED IN OXHEY WITH ROAD PARKING - AVAILABLE NOW.

This property is tucked away from the hustle and bustle and is located within a quiet road in Oxhey. The property comprises of a lounge diner with wood effect flooring & storage cupboard, a nice kitchen, bathroom with shower over bath and a double bedroom with large fitted wardrobes. There is the advantage of a combi boiler, double glazing & a small communal garden area.

This property is approximately 15 minutes walk to carpenders park station.

There is ample parking and the apartment is offered unfurnished. Available for immediate occupation.





GROUND FLOOR  
306 sq.ft. (28.5 sq.m.) approx.

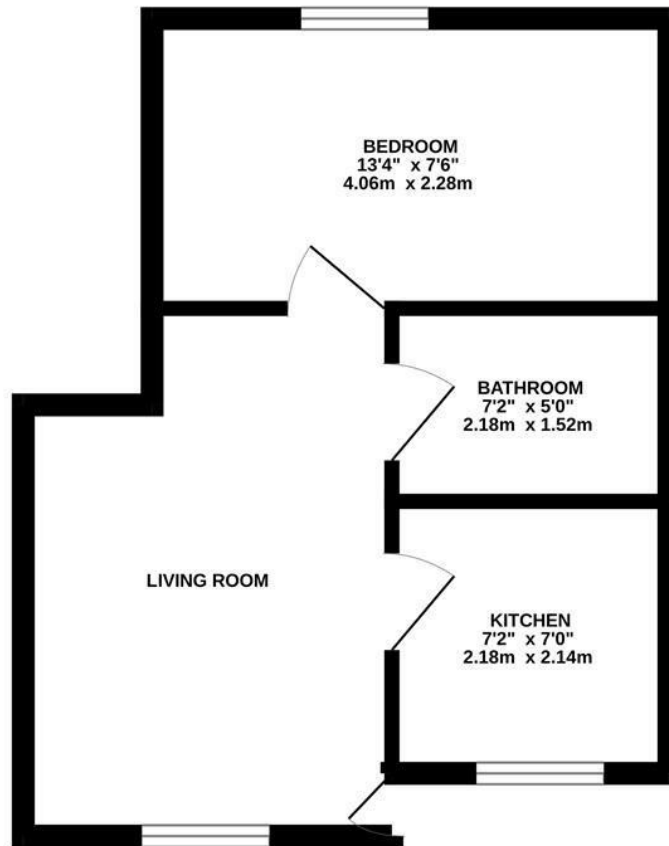

TOTAL FLOOR AREA : 306 sq.ft. (28.5 sq.m.) approx.

Whilst every attempt has been made to ensure the accuracy of the floorplan contained here, measurements of doors, windows, rooms and any other items are approximate and no responsibility is taken for any error, omission or mis-statement. This plan is for illustrative purposes only and should be used as such by any prospective purchaser. The services, systems and appliances shown have not been tested and no guarantee as to their operability or efficiency can be given.

Made with Metropix ©2024

Council Tax Band

C

Energy Performance Graph

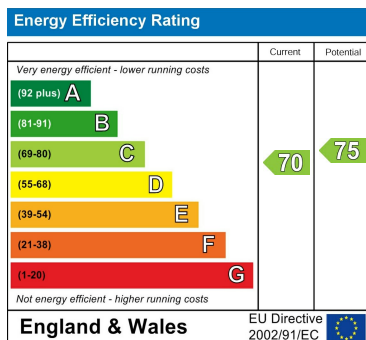

Call us on

01923 220 012

[enquiries@warrenanthony.co.uk](mailto:enquiries@warrenanthony.co.uk)

[www.warrenanthony.co.uk](http://www.warrenanthony.co.uk)

Agents Note: Whilst every care has been taken to prepare these particulars, they are for guidance purposes only. All measurements are approximate and are for general guidance purposes only and whilst every care has been taken to ensure their accuracy, they should not be relied upon and potential buyers are advised to recheck the