



Apartment (EPC Rating: D)

**WELLINGTON ROAD, WATFORD, WD17
1QU**

Per Month

£1,300 Per

1 Bedroom Apartment located in Watford

ONE BEDROOM FIRST FLOOR APARTMENT JUST 0.2 MILES FROM WATFORD JUNCTION AND WATFORD TOWN CENTRE IDEAL FOR PROFESSIONALS WHO COMMUTE - AVAILABLE NOW

This one bedroom apartment is located within a block of two properties and comprises of an entrance hallway, large double bedroom with good space for wardrobes, bathroom and a lovely open plan living room/kitchen.

One of the standout features of this property is its exceptional location. Situated just 0.2 miles from Watford Junction, it is perfect for commuters looking for easy access to London and beyond. Additionally, the bustling Watford Town Centre is a mere 0.2 miles away, providing a wealth of shopping, dining, and entertainment options right on your doorstep.

This apartment is available for immediate occupancy, making it an excellent opportunity for those looking to move quickly. With its combination of space, character, and prime location, this property is not to be missed.

Unfurnished and available now.



GROUND FLOOR

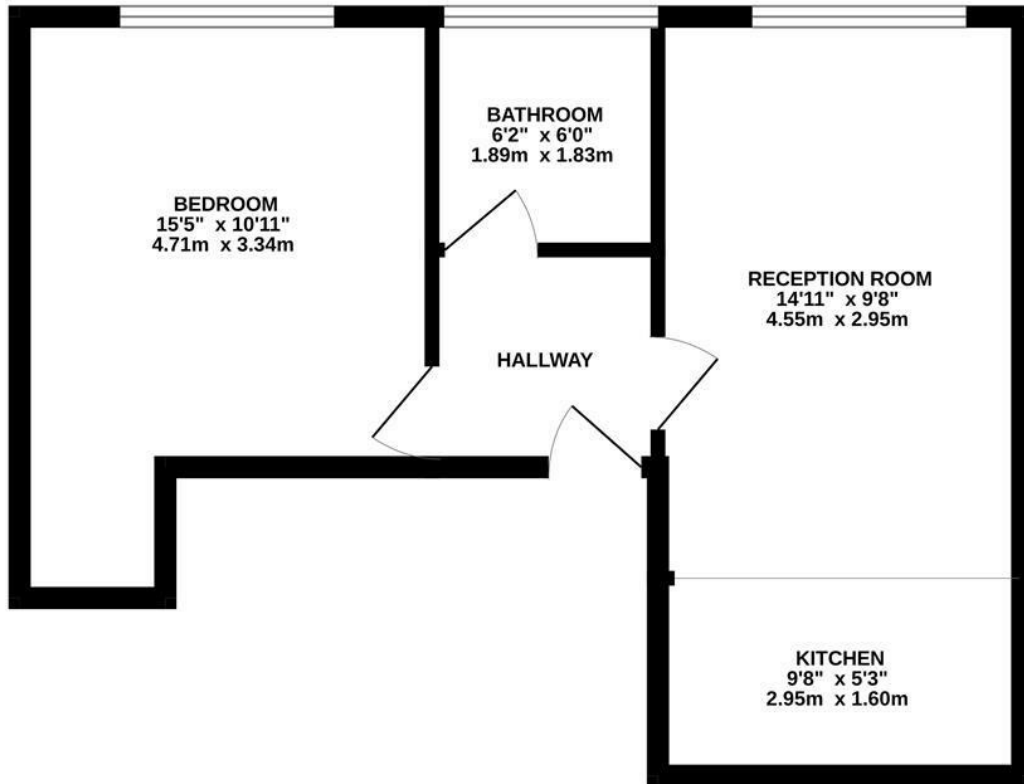

WELLINGTON RD

Whilst every attempt has been made to ensure the accuracy of the floorplan contained here, measurements of doors, windows, rooms and any other items are approximate and no responsibility is taken for any error, omission or mis-statement. This plan is for illustrative purposes only and should be used as such by any prospective purchaser. The services, systems and appliances shown have not been tested and no guarantee as to their operability or efficiency can be given.
Made with Metropix ©2025

Council Tax Band

D

Energy Performance Graph

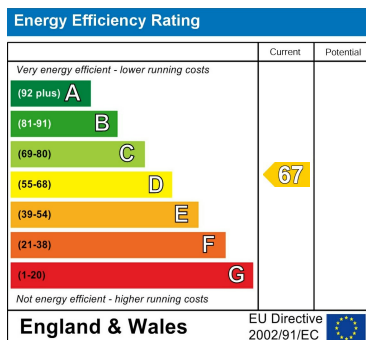

Call us on

01923 220 012

enquiries@warrenanthony.co.uk

www.warrenanthony.co.uk

Agents Note: Whilst every care has been taken to prepare these particulars, they are for guidance purposes only. All measurements are approximate and are for general guidance purposes only and whilst every care has been taken to ensure their accuracy, they should not be relied upon and potential buyers are advised to recheck the