

House - End Terrace (EPC Rating: D)

BYEWATERS, WATFORD, WD18 8WJ

Per Calendar Month

£1,300 Per

1 Bedroom House - End Terrace located in Watford

LOVELY ONE BEDROOM HOUSE WITH PRIVATE GARDEN LOCATED IN THE BYEWATERS DEVELOPMENT JUST A SHORT WALK TO WATFORD METROPOLITAN STATION AND CROXLEY&WATFORD BUSINESS PARKS - AVAILABLE NOW!

This house is set within a beautiful development offering stunning views of the moors and perfect for a summers day walk along the Grand Union Canal.

The property is comprised of a living room and kitchen/breakfast room on the ground floor with stairs leading up to the bedroom and the bathroom. This house is ideal for a professional couple looking for a quiet abode with easy access to mainline stations for commuting.

Offered unfurnished and available now! Property offers allocated parking for 2 cars.



WATFORD LETTINGS | 12 MARKET STREET, WATFORD, HERTFORDSHIRE, WD18 0PD

GROUND FLOOR
238 sq.ft. (22.1 sq.m.) approx.

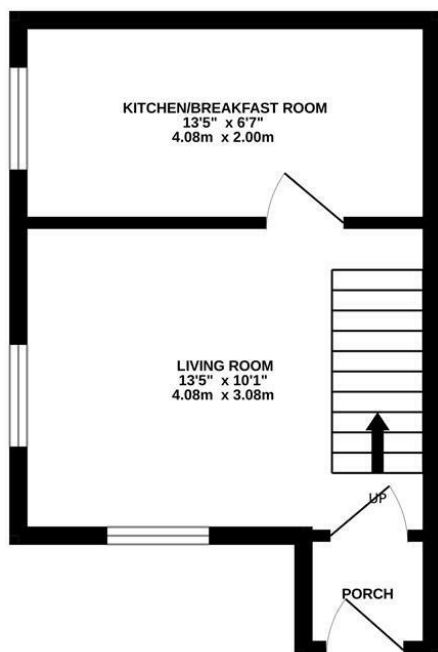

1ST FLOOR
223 sq.ft. (20.7 sq.m.) approx.

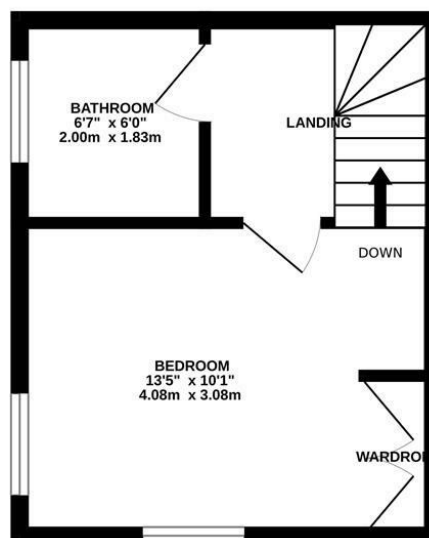

TOTAL FLOOR AREA : 461 sq.ft. (42.8 sq.m.) approx.

Whilst every attempt has been made to ensure the accuracy of the floorplan contained here, measurements of doors, windows, rooms and any other items are approximate and no responsibility is taken for any error, omission or mis-statement. This plan is for illustrative purposes only and should be used as such by any prospective purchaser. The services, systems and appliances shown have not been tested and no guarantee as to their operability or efficiency can be given.
Made with Metropix ©2024

Council Tax Band

D

Energy Performance Graph

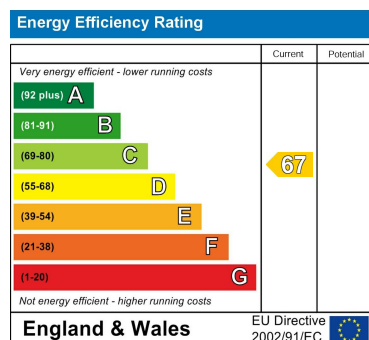

Call us on

01923 220 012

enquiries@warrenanthony.co.uk

www.warrenanthony.co.uk

Agents Note: Whilst every care has been taken to prepare these particulars, they are for guidance purposes only. All measurements are approximate and are for general guidance purposes only and whilst every care has been taken to ensure their accuracy, they should not be relied upon and potential buyers are advised to recheck the