

House - Terraced (EPC Rating: D)

REGENT STREET, WATFORD, WD24
5AU
PCM

£1,575 PCM



2 Bedroom House - Terraced located in Watford

BEAUTIFULLY PRESENTED TWO BEDROOM HOUSE CONVENIENTLY SITUATED JUST 0.7 MILES TO WATFORD JUNCTION STATION - AVAILABLE NOW!

Situated in a highly convenient location, this well-maintained two double bedroom terraced property offers easy access to Watford Junction station, popular local schools, and the vibrant Watford town centre, all within a short walk.

The accommodation features two spacious reception rooms, a modern fitted kitchen equipped with fridge, freezer, cooker, gas hob, and washing machine, as well as a stylish ground floor shower room. Upstairs, you'll find two generously sized double bedrooms.

Additional benefits include a private rear garden, gas central heating, and double glazing throughout. The property is offered unfurnished and will be available NOW!



BASEMENT
77 sq.ft. (7.1 sq.m.) approx.

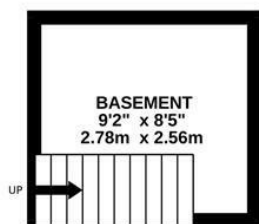

GROUND FLOOR
375 sq.ft. (34.9 sq.m.) approx.

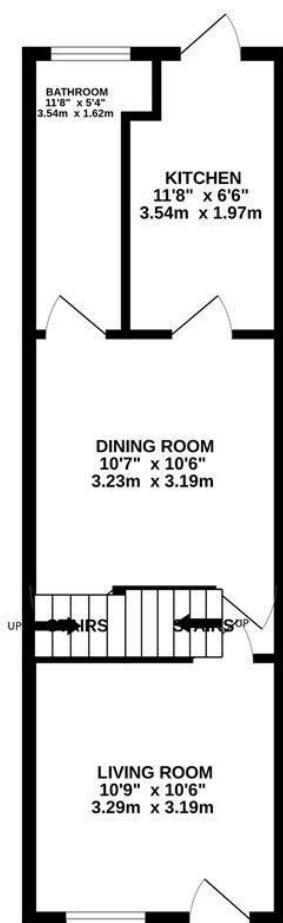

1ST FLOOR
254 sq.ft. (23.6 sq.m.) approx.

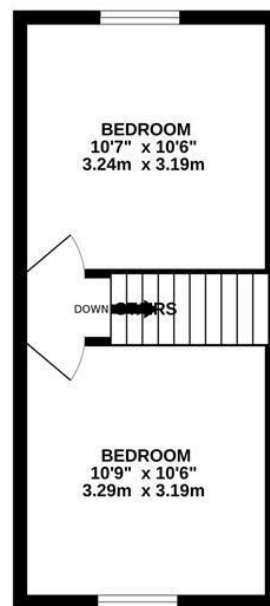

TOTAL FLOOR AREA : 706 sq.ft. (65.6 sq.m.) approx.

Whilst every attempt has been made to ensure the accuracy of the floorplan contained here, measurements of doors, windows, rooms and any other items are approximate and no responsibility is taken for any error, omission or mis-statement. This plan is for illustrative purposes only and should be used as such by any prospective purchaser. The services, systems and appliances shown have not been tested and no guarantee as to their operability or efficiency can be given.
Made with Metropix ©2025

Council Tax Band

D

Energy Performance Graph

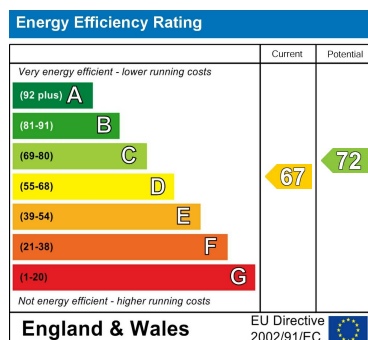

Call us on

01923 220 012

enquiries@warrenanthony.co.uk

www.warrenanthony.co.uk

Agents Note: Whilst every care has been taken to prepare these particulars, they are for guidance purposes only. All measurements are approximate and are for general guidance purposes only and whilst every care has been taken to ensure their accuracy, they should not be relied upon and potential buyers are advised to recheck the

